



Ford Place, Stockton-On-Tees, TS18 2RX

This immaculate three bedroom semi-detached house is located on a larger than average corner plot. Accommodation is gas centrally heated, uPVC double glazed and briefly included an entrance porch, lounge/dining room with double doors into a conservatory, a modern fitted kitchen with integrated oven, hob and microwave plus space for a small breakfast table. Upstairs there are three bedrooms and a modern bathroom with shower over the bath. Externally there is a small lawned front garden, an enclosed tidy rear garden and a driveway leading to an integral garage. This property would make a lovely starter home or equally a good investment opportunity.

Asking Price £150,000



Ford Place, Stockton-On-Tees, TS18 2RX

ENTRANCE HALL

LOUNGE/DINING ROOM

11'1" x 22'10" (3.38m x 6.96m)

CONSERVATORY

12'0" x 9'5" (3.66 x 2.87)

KITCHEN/BREAKFAST ROOM

10'1" x 9'1" (3.07 x 2.77)

LANDING

BEDROOM ONE

12'3" x 9'8" (3.73 x 2.95)

BEDROOM TWO

9'11" x 9'1" (3.02 x 2.77)

BEDROOM THREE

9'9" x 9'8" (2.97 x 2.95)

BATHROOM

7'2" x 6'11" (2.18 x 2.11)





Map



EPC graph

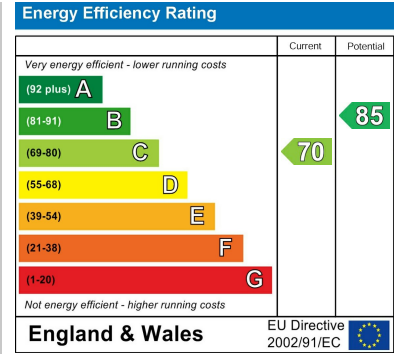

Floor Plan

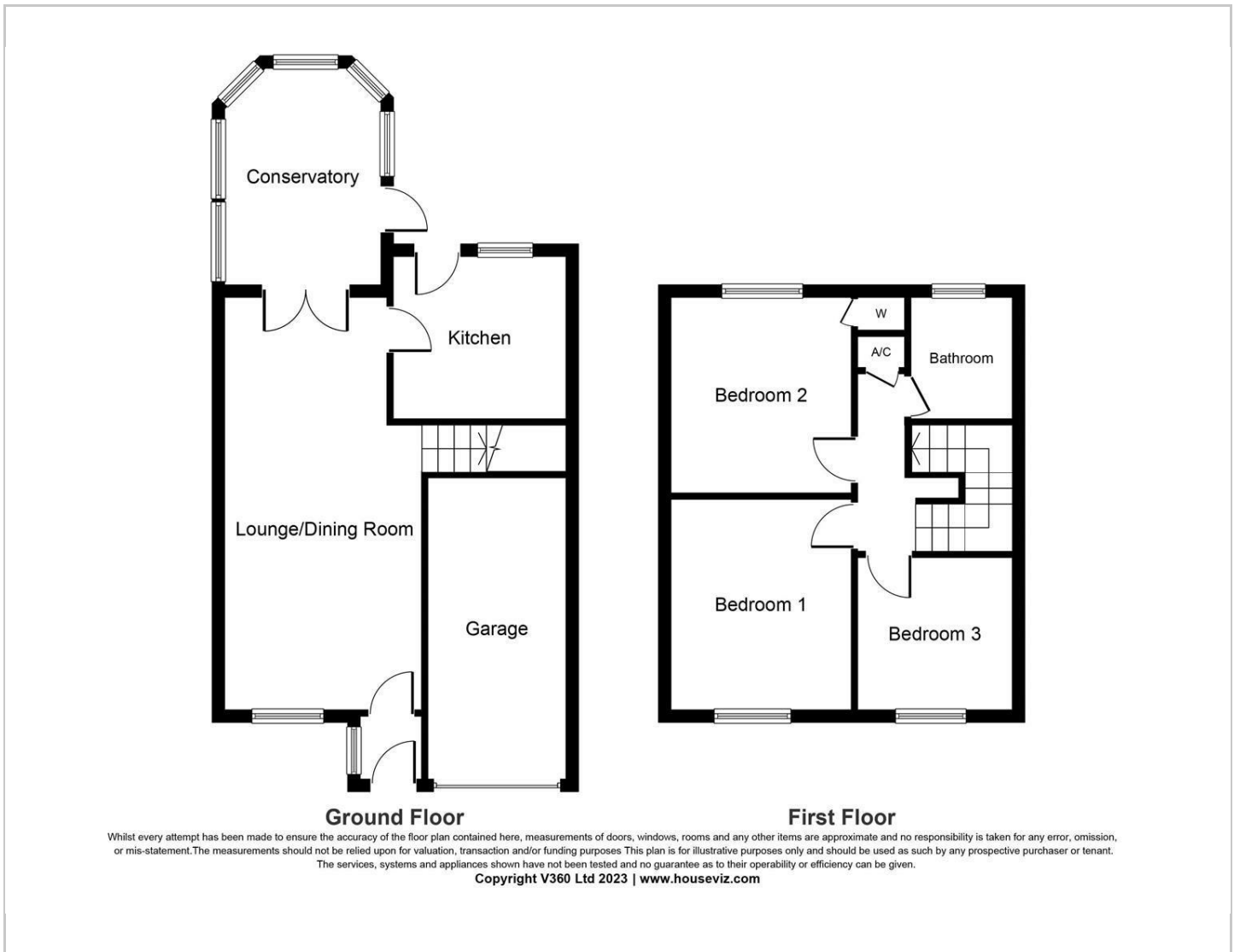

VIEWING

Please contact us on 01642 615657 if you wish to arrange a viewing or would like more information.

These particulars, whilst believed to be accurate are set out as a general outline only for guidance and do not constitute any part of an offer or contract. Intending purchasers should not rely on them as statements of representation of fact, but must satisfy themselves by inspection or otherwise as to their accuracy. No person in this firm's employment has the authority to make or give any representation or warranty in respect of the property.

17 Bishop Street, Stockton on Tees, TS18 1SY

Tel: 01642 615657 Email: stockton@gowlandwhite.co.uk <https://www.gowlandwhite.co.uk/>