



## Tithe Barn Road, Hardwick, Stockton-On-Tees, TS19 8PR

A three bedroom mid terrace property in a popular location on the Hardwick Estate, within easy reach of local amenities, shops, schools, transport links and North Tees Hospital. Will likely appeal to First Time Buyers or an Investor, due to the popularity and demand for lettings in the area.

Accommodation comprises entrance porch, hallway leading to a good sized lounge and kitchen/dining area with integrated gas hob and oven with extractor fan. The rear porch leads out to a private, low maintenance garden with outhouse installed with electrics. Upstairs provides master bedroom with fitted wardrobes, two further bedrooms and recently renovated shower room with walk in rainfall shower.

This property also benefits from gas central heating (new boiler fitted May 2023) and double glazing.

Asking Price £90,000



# Tithe Barn Road, Hardwick, Stockton-On-Tees, TS19 8PR

PORCH

HALL

LOUNGE

13'3 x 11'10 (4.04m x 3.61m)

KITCHEN/DINING

18'4 x 9'1 (5.59m x 2.77m)

BACK PORCH

9'2 x 4'3 (2.79m x 1.30m)

OUTHOUSE

6'9 x 5'2 (2.06m x 1.57m)

LANDING

BEDROOM ONE

11'5 x 10'2 (3.48m x 3.10m)

BEDROOM TWO

9'2 x 10'2 (2.79m x 3.10m)

BEDROOM THREE

8' x 8' (2.44m x 2.44m)

SHOWER ROOM

8'1 x 5'11 (2.46m x 1.80m)





## Map

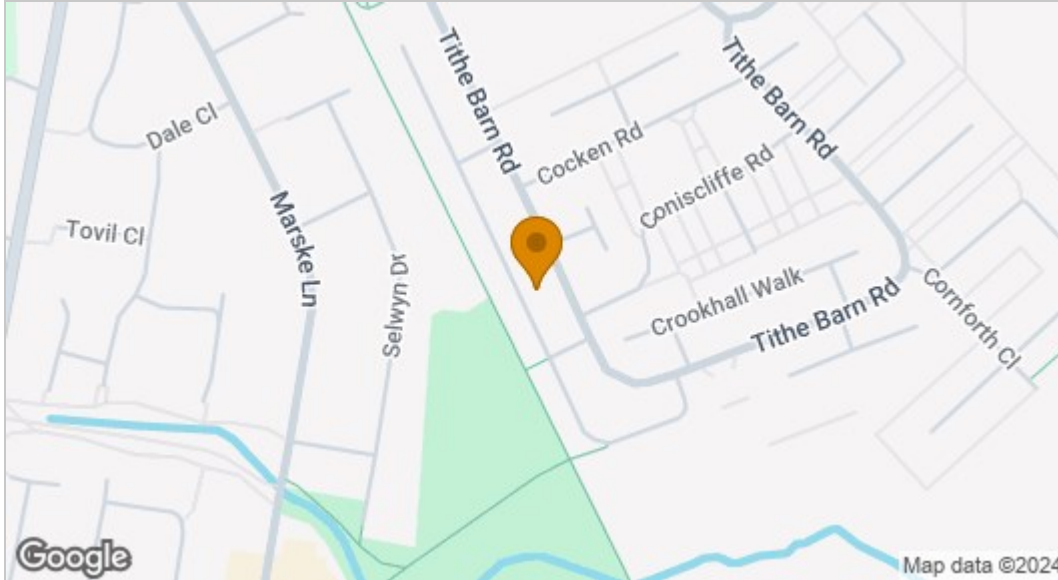

## EPC graph

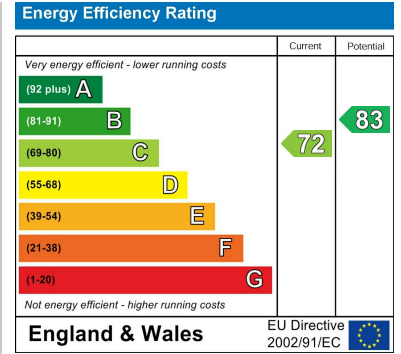

## Floor Plan

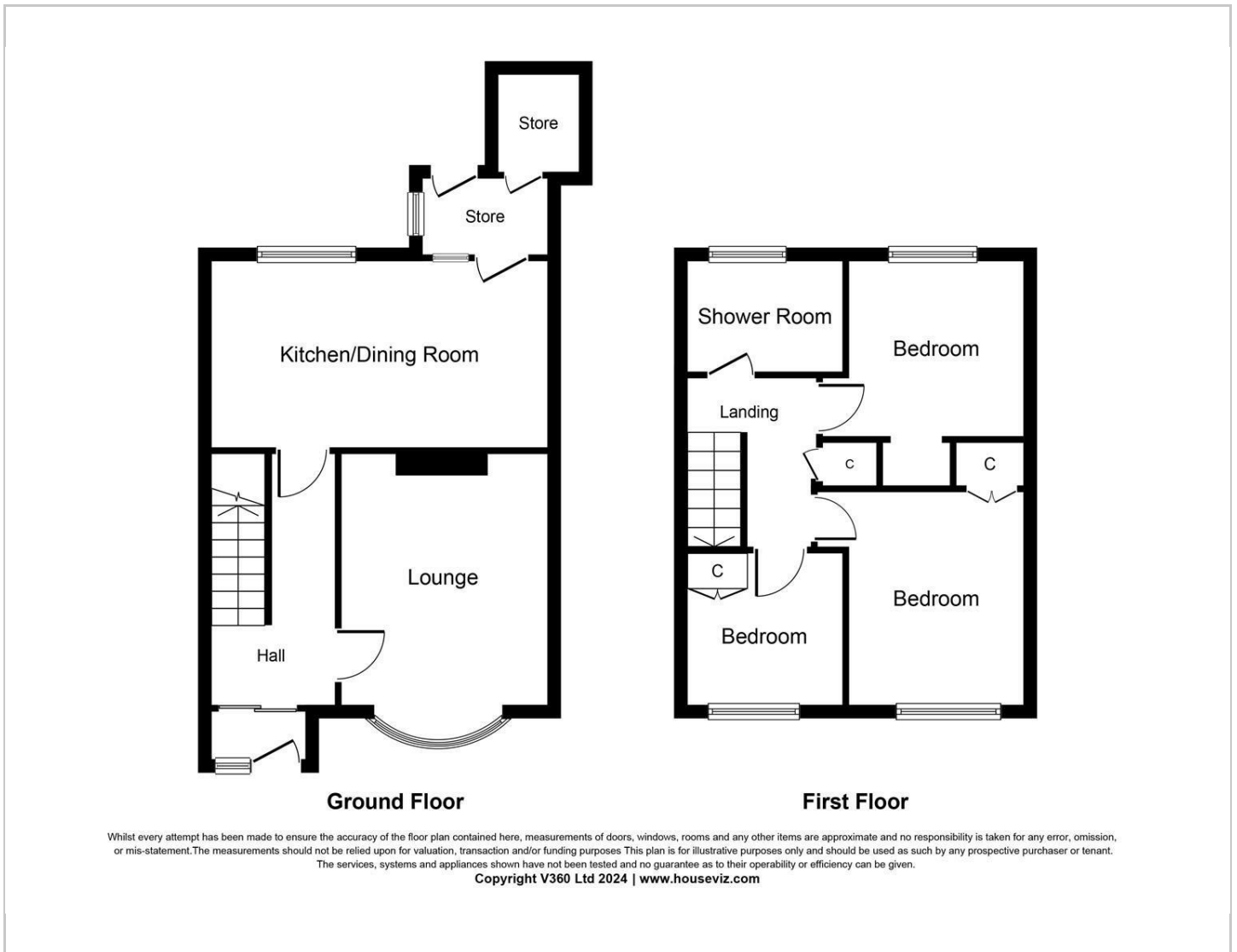

## VIEWING

Please contact us on 01642 615657 if you wish to arrange a viewing or would like more information.

These particulars, whilst believed to be accurate are set out as a general outline only for guidance and do not constitute any part of an offer or contract. Intending purchasers should not rely on them as statements of representation of fact, but must satisfy themselves by inspection or otherwise as to their accuracy. No person in this firm's employment has the authority to make or give any representation or warranty in respect of the property.

17 Bishop Street, Stockton on Tees, TS18 1SY

Tel: 01642 615657 Email: [stockton@gowlandwhite.co.uk](mailto:stockton@gowlandwhite.co.uk) <https://www.gowlandwhite.co.uk/>