



## Seymour Drive, Eaglescliffe, Stockton-On-Tees, TS16 0LG

Located in a sought after location this 3 bed semi detached house is within in a family friendly area known for its excellent primary schools and secondary school. Embrace the potential to make it your own with a touch of modernisation, while enjoying the comfort of double glazing and gas central heating throughout.

Step inside to a hallway which leads to a spacious lounge/dining room, a kitchen, and a convenient breakfast room. Upstairs there are three bedrooms and a functional bathroom. Outside, the property provides front and rear gardens. The driveway leads to a garage, ensuring ample parking space.

Offered for sale with the advantage of NO CHAIN !

Asking Price £170,000





Seymour Drive, Eaglescliffe, Stockton-On-Tees, TS16 0LG

HALL

LOUNGE/DINING ROOM  
22'5" x 11'5" (6.83m x 3.48m)

KITCHEN  
7" x 8'6" (2.13m x 2.59m )

BREAKFAST ROOM  
8'5" x 8'6" (2.57m x 2.59m )

LANDING

BATHROOM  
5'6" x 7'9" (1.68m x 2.36m)

BEDROOM TWO  
9'9" x 11'2" (2.97m x 3.40m)

BEDROOM ONE  
10'10" x 11'5" (3.30m x 3.48m )

BEDROOM THREE  
6'8" x 8'4" (2.03m x 2.54m )









## Map



## EPC graph

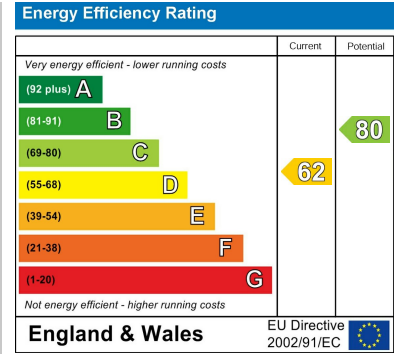

## Floor Plan

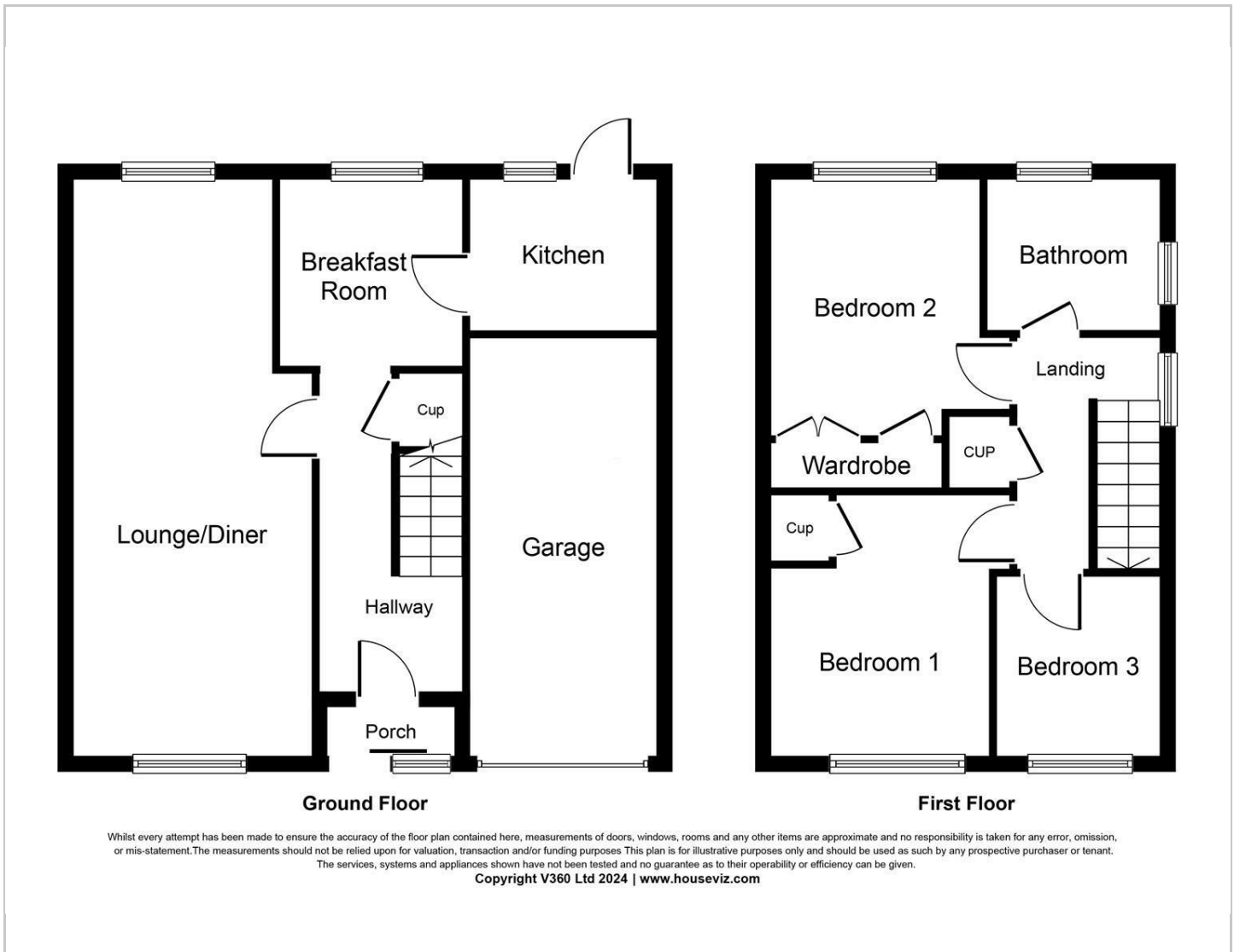

## VIEWING

Please contact us on 01642 248248 if you wish to arrange a viewing or would like more information.

These particulars, whilst believed to be accurate are set out as a general outline only for guidance and do not constitute any part of an offer or contract. Intending purchasers should not rely on them as statements of representation of fact, but must satisfy themselves by inspection or otherwise as to their accuracy. No person in this firm's employment has the authority to make or give any representation or warranty in respect of the property.