



Lambourn Meadows, Lower Way, Thatcham RG19 3RP
£480,000

 4  2  2

- Brand New Home
- Four bedrooms
- Superbly appointed
- Driveway parking
- 10 year NHBC Warranty
- Semi detached townhouse
- Large master bedroom suite
- Downstairs cloakroom
- Carport and solar panelling to Show Home



CALL US TO ARRANGE YOUR OWN PERSONAL VIEWING. A superb brand new home built by Charles Church Homes located off Lower Way close to the Nature Reserve offering lovely walks on your doorstep! The four bedroom townhouse offers light and spacious accommodation arranged over three floors with a large master bedroom suite on the top floor. This very well appointed and great design for family living includes accommodation consisting of an entrance hall, cloakroom, fully fitted kitchen/dining room, living room with French doors to the rear garden on the ground floor, three great sized bedrooms and family bathroom to the first floor and spacious dual aspect master bedroom suite with built-in wardrobes and large en-suite shower room to the top floor. Outside there is a garden and driveway parking. The show home has the addition of solar panelling and a carport to the above. The properties have been finished to high standard throughout and, for peace of mind, come with a 10 year insuran



Approximate Gross Internal Area
107.50 sq m / 1157.12 sq ft
(Excludes Eaves)

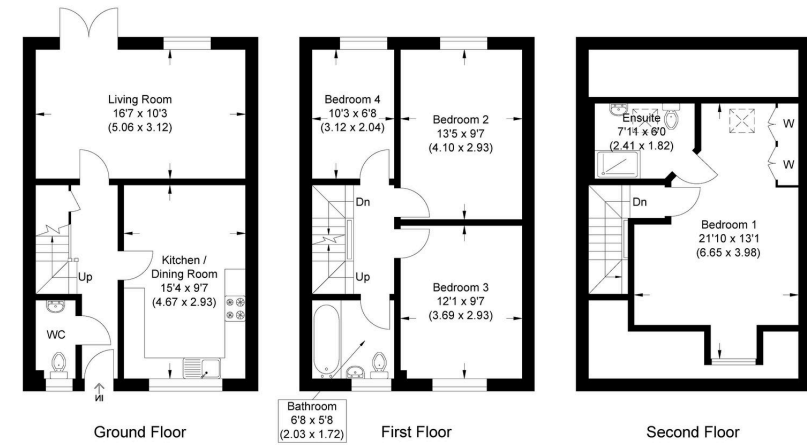

Illustration for identification purposes only, measurements are approximate, not to scale.



☎ 01635 523777 (Sales)

☎ 01635 523880 (Lettings)

🌐 www.downer.co.uk

DOWNER & CO Estate Agents, 44 Cheap Street Newbury, Berkshire RG14 5BX