







## George House, Bishops Green, Newbury, RG20 4HT

£875,000

 4  2  3

- Four double bedrooms
- Large plot with potential to build another property STPP
- Converted garage into annex
- Large home office
- Beautifully updated and improved
- Stunning garden
- Ensuite to master
- Walk to local shop
- Easy access to A339 and A34
- Approximately 2500 sq ft



This four double bedroom detached home sits in a large plot and has been significantly updated and improved by the current owner. The property is beautifully presented throughout and the garden has been meticulously maintained.

The light and spacious accommodation consists of entrance hall, kitchen/dining room, living room with gas fireplace, snug/family room with woodburner, utility room, cloakroom, master bedroom with ensuite, three further double bedrooms and family bathroom. The double garage has been converted into a studio annex with office above, and there is also a large home office in the garden.

The garden has potential to build a new house subject to planning. Benefits include upvc triple glazing, gas fired central heating (new Bosch boiler 2023), and driveway parking for several vehicles.







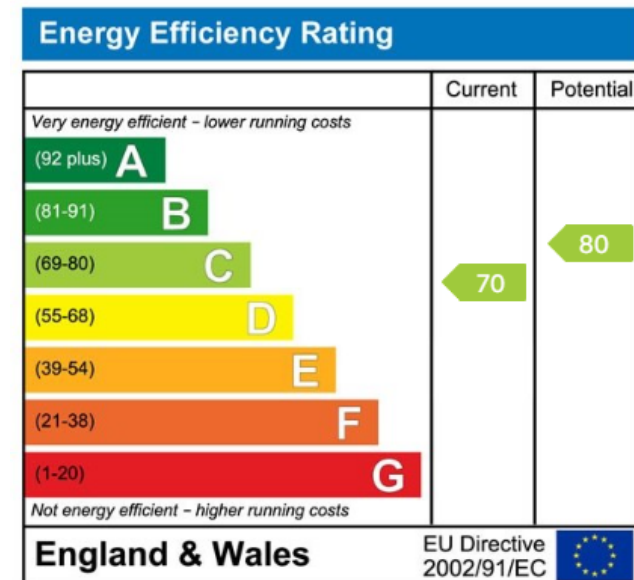
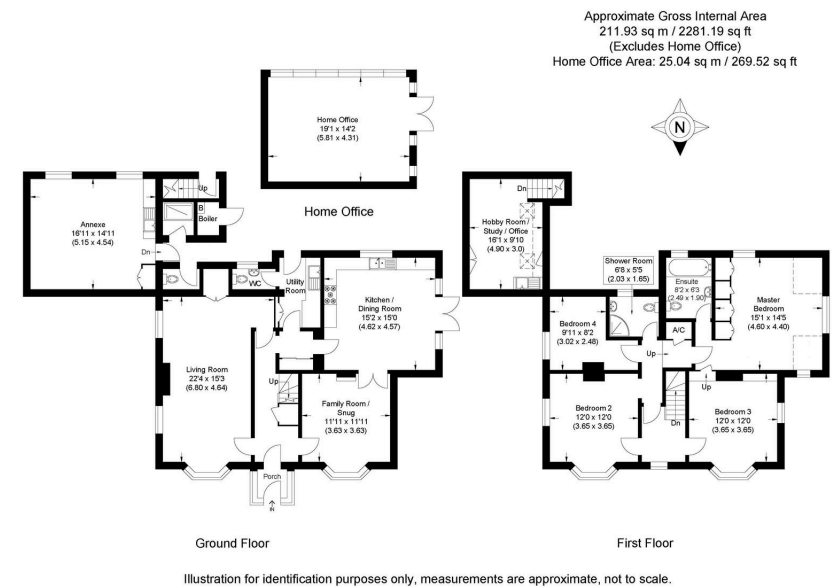

☎ 01635 523777 (Sales)

☎ 01635 523880 (Lettings)

🌐 [www.downer.co.uk](http://www.downer.co.uk)

DOWNER & CO Estate Agents, 44 Cheap Street Newbury, Berkshire RG14 5BX