





## 6 Draper Close, Thatcham RG19 3XQ

£315,000

🛏️ 2 🚿 1 🛋️ 1

- The Moors development
- End of terrace home
- Very smartly presented
- Private corner plot garden
- Walk to town and train station
- Two double bedrooms
- Open plan living/dining room
- Garage and separate driveway parking



Located within walking distance of everything, both Spurcroft primary and Kennet secondary schools, the town centre, the train station and open countryside! This immaculately presented two double bedroom end of terrace house with walled corner plot garden and garage is an ideal first time buy or investment property.

The accommodation comprises entrance lobby, kitchen, living/dining room, two double bedrooms and a family bathroom. Outside the walled corner plot garden has a decked terrace along with lawns and shed. The garage and parking is located a short walk away but offers off road parking for at least four vehicles. Viewings advised.

EPC Rating to follow







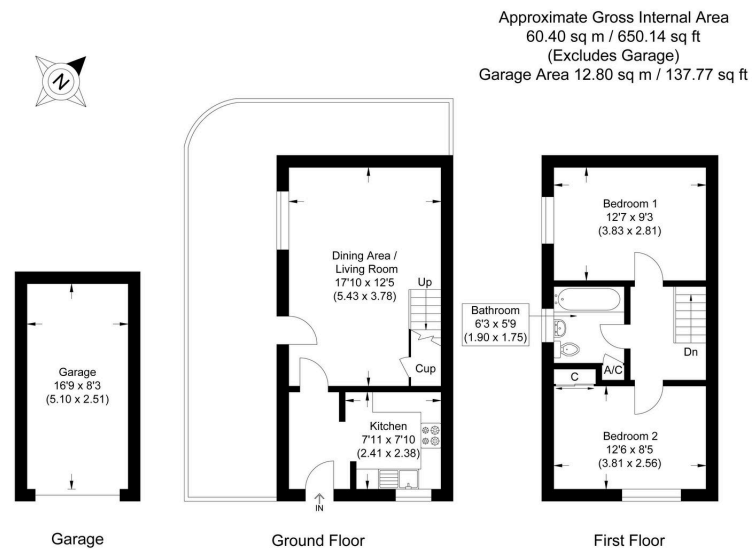

Illustration for identification purposes only, measurements are approximate, not to scale.



📞 01635 523777 (Sales)

📞 01635 523880 (Lettings)

🌐 [www.downer.co.uk](http://www.downer.co.uk)

DOWNER & CO Estate Agents, 44 Cheap Street Newbury, Berkshire RG14 5BX