



Flat 10, Shefford Lodge, Link Road, Newbury, RG14 7LR

Guide Price £199,950

🛏 2 🍳 1 🚿 1

- Ground floor apartment
- Two double bedrooms
- Living/dining room
- Own outdoor patio area
- Walk to town centre/rail station
- 976 year lease remaining
- Off road parking
- Immaculate presentation
- Well kept communal gardens
- Service charge £1680 Per Annum



Immaculately presented two double bedroom ground floor apartment, ideally situated within a short walk to the town centre and rail station.

The spacious accommodation comprises communal entrance hall, own hall, living/dining room with door opening to a private own patio area overlooking the communal gardens, two double bedrooms both with double built-in wardrobes, smartly fitted kitchen and shower room.

Benefits also include a lengthy 976 year lease remaining and unallocated off-road parking. Viewings highly recommended.



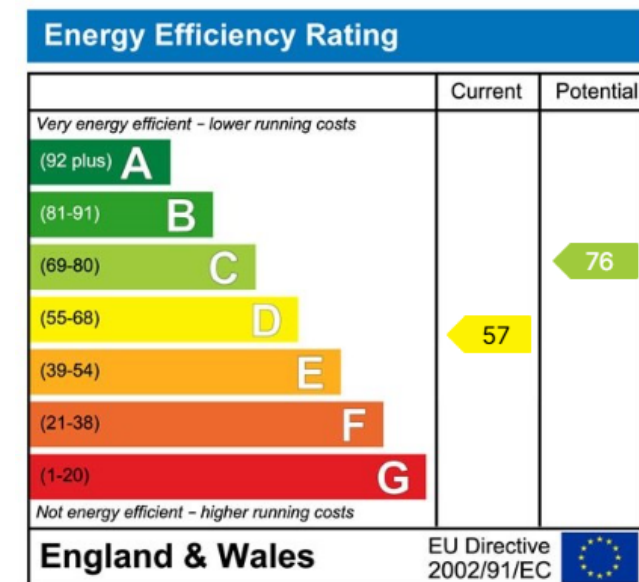
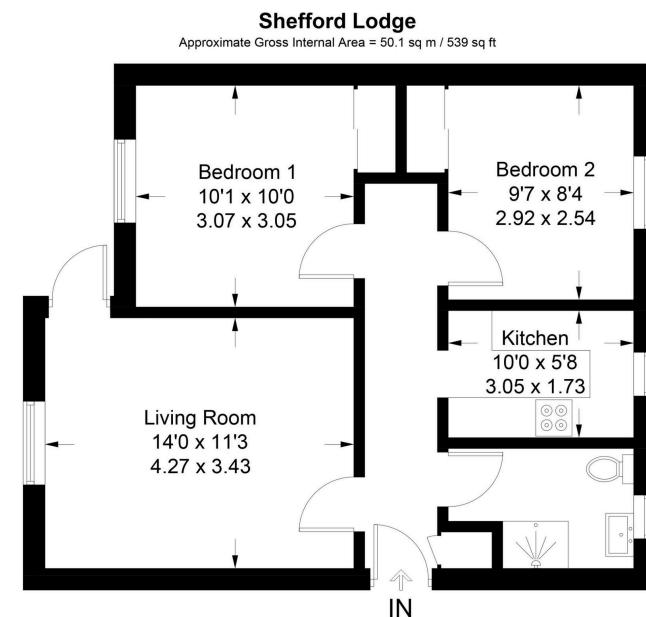

☎ 01635 523777 (Sales)

☎ 01635 523880 (Lettings)

🌐 www.downer.co.uk

DOWNER & CO Estate Agents, 44 Cheap Street Newbury, Berkshire RG14 5BX