



Flat 5, 246 London Road, Newbury, RG14 2BN

£120,000

🛏 1 🚿 1 🚿 1

- Lease 989 years. No Ground Rent. Service Charge £1500 per annum
- Local shops nearby
- First floor
- Great first time purchase or investment
- Conveniently located for A4, A34
- Walk to town centre
- One good sized bedroom
- Allocated parking
- High ceilings



NO ONWARD CHAIN. A one bedroom, first floor flat forming part of a converted house conveniently located within easy reach of Newbury, the A4 and A34. On the doorstep are local shops including Tesco, B&Q and Costa, and the canal path is just a short walk away.

The accommodation consists of communal security entry system, stairs to first floor, through personal front door to open plan kitchen/living room, good sized double bedroom, and bathroom. The property benefits from long lease of 989 years, no ground rent, high ceilings, allocated parking, and communal courtyard to the rear of the building.

Lease 989 years
No Ground Rent
Service Charge £1500 per annum





Approximate Gross Internal Area
35.02 sq m / 376.95 sq ft

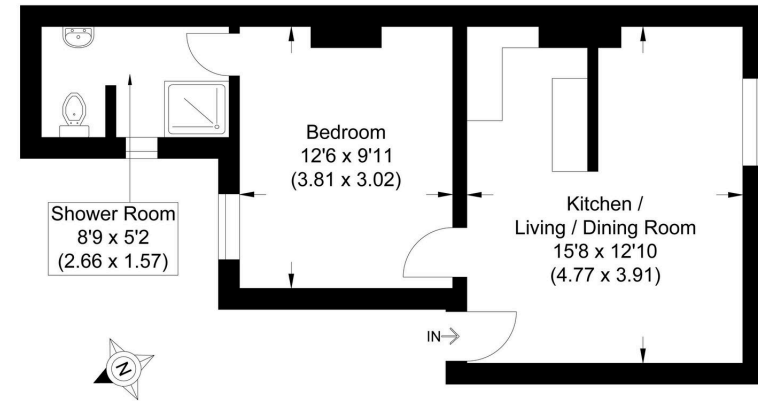
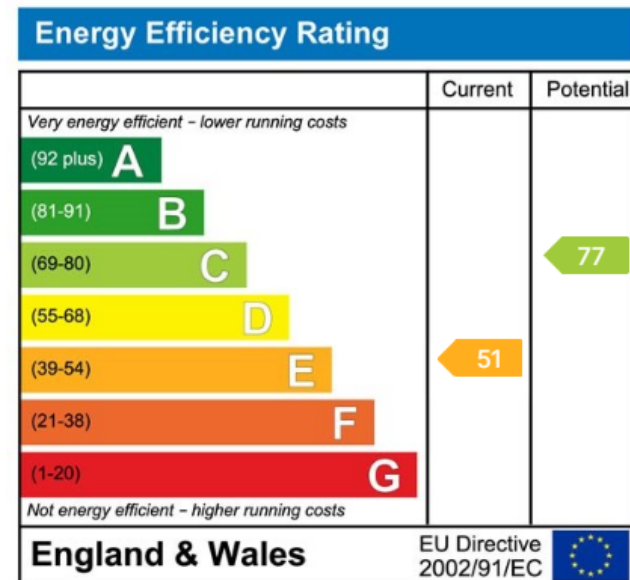

Illustration for identification purposes only, measurements are approximate, not to scale.



☎ 01635 523777 (Sales)

☎ 01635 523880 (Lettings)

🌐 www.downer.co.uk

DOWNER & CO Estate Agents, 44 Cheap Street Newbury, Berkshire RG14 5BX