



10 Sandleford Lane, Greenham RG19 8XW

£385,000

🛏 3 🍳 2 🛋 2

- South side of Newbury
- Three bedrooms
- Downstairs cloakroom
- Garage and driveway
- Close to the Retail Park and Tesco
- End of terrace house
- Master en-suite
- Corner plot garden
- Nearby walks at Greenham Common
- No Onward Chain



On a corner plot, a very popular design of a three bedroom house. This end of terrace home is located on the south side of Newbury, the house is close to the Retail Park/Tesco and has stunning walks on nearby Greenham Common.

Offered with NO ONWARD CHAIN, the accommodation includes entrance hall, cloakroom, living room, inner hallway, open plan kitchen/dining room with French door to the garden, master bedroom en-suite, two further bedrooms, family bathroom, corner plot garden, single detached garage and driveway parking.



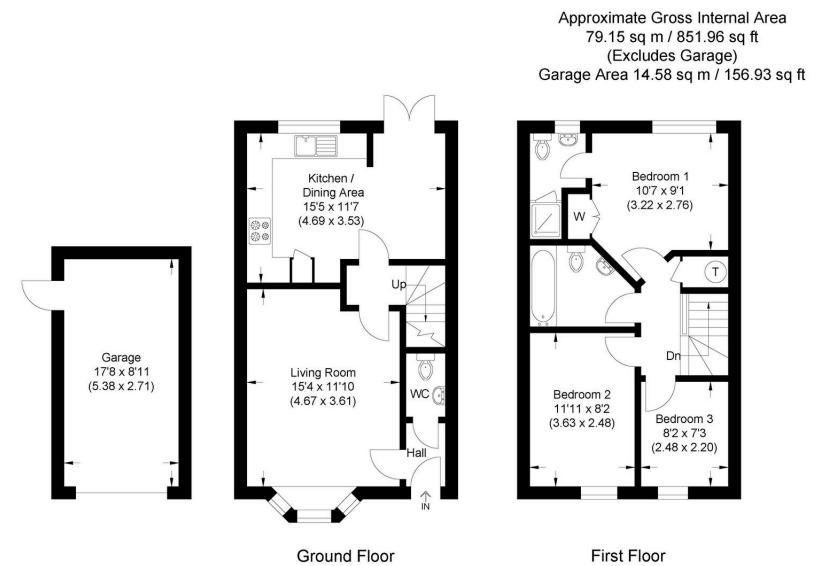
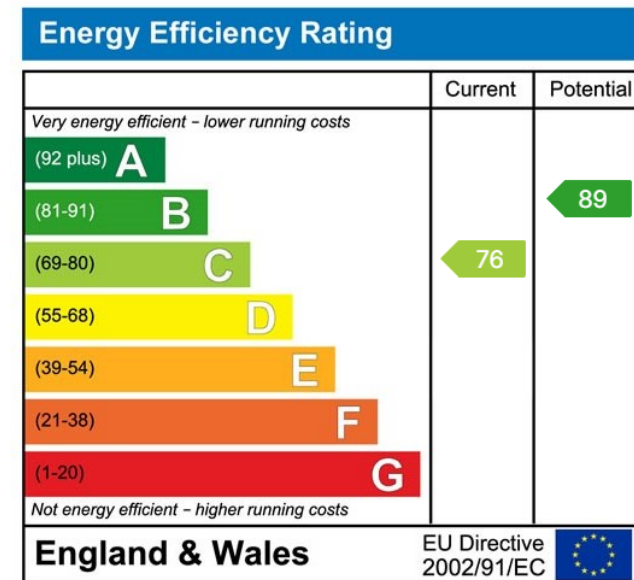

Illustration for identification purposes only, measurements are approximate, not to scale.



☎ 01635 523777 (Sales)

☎ 01635 523880 (Lettings)

🌐 www.downer.co.uk

DOWNER & CO Estate Agents, 44 Cheap Street Newbury, Berkshire RG14 5BX