





Upper Green, Inkpen, Hungerford, RG17 9PZ

£1,050,000

 4  2  5

- NO ONWARD CHAIN
- Over 2500 sq ft
- Beautifully presented
- Outbuilding ideal for a home office
- Easy access to Kintbuty, Hungerford and Newbury
- Far reaching westerly views
- Four double bedrooms
- Spacious and light
- Situated in an area of outstanding natural beauty
- Cinema



NO ONWARD CHAIN. With stunning far reaching westerly views across open fields, this spacious four bedroom home has plenty of living space and flexibility. This detached property is located in Inkpen in an area of outstanding natural beauty. This property is surrounded by miles of footpaths and Kintbury village is just a few miles away with its mainline rail station to London Paddington. The property has been well maintained by the current owners and also extended and improved to to produce a very comfortable family home. The smart accommodation consists of entrance hall, study/playroom, kitchen/breakfast room, dining room, living room, cinema, utility room, cloakroom, master bedroom with ensuite, three further double bedrooms, and family bathroom. Outside the rear garden is laid mainly to lawn with a path to the front. There is also an almost complete detached outbuilding (first fix electrics done) ideal for a home office.



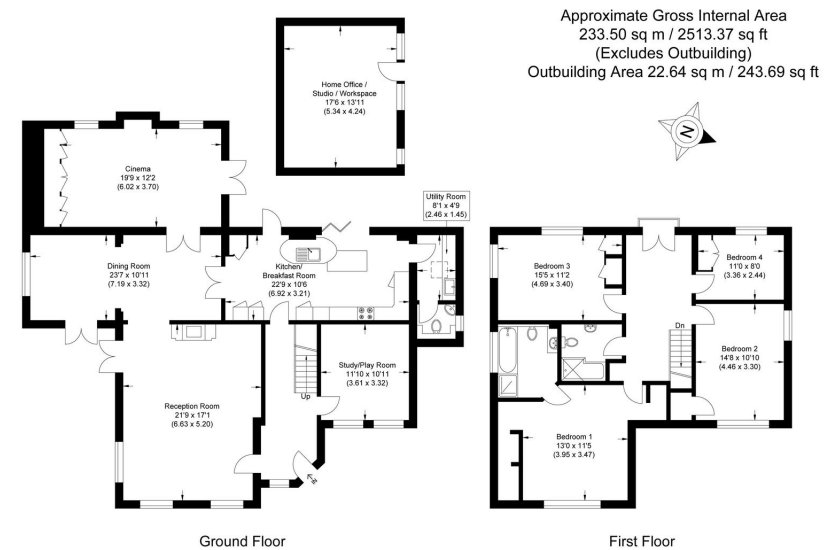
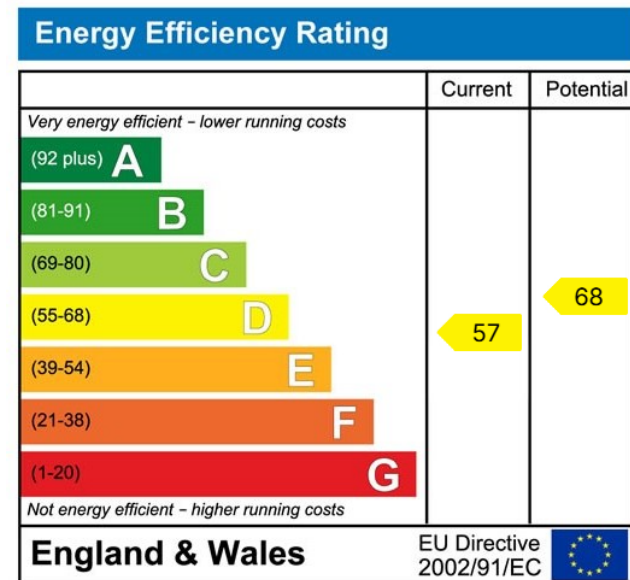

Illustration for identification purposes only, measurements are approximate, not to scale.



☎ 01635 523777 (Sales)

☎ 01635 523880 (Lettings)

🌐 www.downer.co.uk

DOWNER & CO Estate Agents, 44 Cheap Street Newbury, Berkshire RG14 5BX