



9 Stroller Close, Thatcham, RG19 3TX

£315,000

 3  1  1

- Quiet cul-de-sac location
- Western fringes of Thatcham
- Staggered terraced house
- Three bedrooms
- Spacious living/dining room
- Garden
- Garage in block
- Parking to front of property
- Nearby walks at Thatcham Nature Discovery Centre



Tucked away at the end of a quiet cul-de-sac, a staggered three bedroom terrace house offering spacious accommodation. Located on the western fringes of Thatcham, within easy walking distance of the Thatcham Discovery Centre with its lovely lakeside walk and close to Henwick playing fields.

The accommodation includes entrance hall, spacious living/dining room with patio doors to garden, kitchen, two double bedrooms, further single bedroom and bathroom. Outside, the enclosed rear garden has a covered patio, grassed area and large shed. The front garden is brick paved and there is a garage in a nearby block.

EPC Rating to follow.





Approximate Gross Internal Area
73.48 sq m / 790.93 sq ft

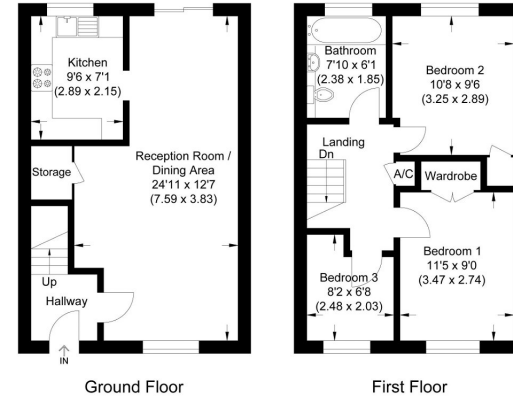

Illustration for identification purposes only, measurements are approximate, not to scale.



☎ 01635 523777 (Sales)

☎ 01635 523880 (Lettings)

🌐 www.downer.co.uk

DOWNER & CO Estate Agents, 44 Cheap Street Newbury, Berkshire RG14 5BX