

Welton Road, Brough, East Yorkshire, HU15 1AF

☎ 01482 669982

✉ info@limbestateagents.co.uk

🌐 limbestateagents.co.uk

Limb
MOVING HOME



14 Moor Green, Anlaby Common, East Yorkshire, HU4 7SS

- 📍 Semi-Detached Bungalow
- 📍 Extended Accommodation
- 📍 Three Reception Rooms
- 📍 Council Tax Band = C
- 📍 Fantastic South Facing Garden
- 📍 Kitchen & Utility
- 📍 Driveway & Garages
- 📍 Freehold / EPC = C

£249,999

INTRODUCTION

Occupying a lovely cul-de-sac position and enjoying a fantastic plot is this extended semi-detached bungalow. A particular feature is the large south facing and well tended rear garden. The accommodation has been extended over the years and briefly comprises a utility/boot room, kitchen, dining room with doors to the conservatory, lounge, bedroom with dressing room with an extensive range of fitted wardrobes plus there is a large bathroom with four piece suite. Upon the first floor is a spacious bedroom and W.C. The property boasts gas central heating and uPVC double glazing.

The property occupies a corner position with a driveway providing excellent parking, two garages and a carport. The fantastic rear garden has been well tended and is mainly lawned with attractive borders and fruit trees. There is a large deck to the rear of the conservatory and a covered patio with grapevine to the side ideal for outdoor entertaining.

LOCATION

Moor Green is a cul-de-sac situated off Westborough Way in Anlaby Common. The property is therefore ideally placed for excellent range of amenities including shops, cafe's, recreation facilities, supermarkets and Anlaby Retail Park, home to any major brands. The property is also in the catchment area for well regarded primary and secondary schools.



ACCOMMODATION

Residential entrance door to:

UTILITY/BOOT ROOM

With fitted units, tiled floor, sink with mixer tap, and windows to the rear.



KITCHEN

15'9" x 9'4" approx (4.80m x 2.84m approx)
Having a range of fitted base and wall units, laminate worksurfaces, one and a half bowl sink and drainer with mixer tap, oven, four ring gas hob with filter above. Windows to rear.



DINING ROOM

15'9" x 10'11" approx (4.80m x 3.33m approx)
With doors leading through to the conservatory. Staircase to the first floor.



CONSERVATORY

10'0" x 10'0" approx (3.05m x 3.05m approx)
With doors opening out to the rear deck.

INNER HALL

With storage cupboards.

LOUNGE

14'11" x 12'10" approx (4.55m x 3.91m approx)
With feature fire surround housing a living flame gas fire. Bow window to front elevation.



BEDROOM 1

10'11" x 8'7" approx (3.33m x 2.62m approx)
Windows to front and side elevation. Fitted cupboard.



DRESSING ROOM

10'11" x 7'6" approx (3.33m x 2.29m approx)
Measurements into extensive range of fitted furniture including wardrobes, drawers and dressing table.



BATHROOM

10'10" x 6'2" approx (3.30m x 1.88m approx)
With four piece suite comprising a bath, shower enclosure, vanity unit with wash hand basin and low flush W.C. Tiled walls, inset spot lights, heated towel rail and windows to rear.



FIRST FLOOR

LANDING

With store cupboard.

BEDROOM 2

14'3" x 12'8" approx (4.34m x 3.86m approx)
With fitted wardrobes and window to side.



W.C.

With low flush W.C. and wash hand basin.

OUTSIDE

The property occupies a corner position with a driveway providing excellent parking, two garages and a carport. The fantastic rear garden has been well tended and is mainly lawned with attractive borders and fruit trees. There is a large deck to the rear of the conservatory and a covered patio with grapevine to the side ideal for outdoor entertaining. There is also a garden shed.



DECK



REAR VIEW



SIDE PATIO



GARAGES & CARPORT



TENURE

Freehold

COUNCIL TAX BAND

From a verbal enquiry we are led to believe that the Council Tax band for this property is Band C. We would recommend a purchaser make their own enquiries to verify this.

FIXTURES & FITTINGS

Fixtures and fittings other than those specified in this brochure, such as carpets, curtains and light fittings, may be available subject to separate negotiation. If there are any points of particular importance to you, please contact the office and we will be pleased to check the information for you.

VIEWING

Strictly by appointment through the agent. Brough Office 01482 669982.

AGENTS NOTE

For clarification, we wish to inform prospective purchasers that we have not carried out a detailed survey, nor tested the services, appliances and specific fittings for this property. All measurements provided are approximate and for guidance purposes only. Floor plans are included as a service to our customers and are intended as a GUIDE TO LAYOUT only. NOT TO SCALE. Matthew Limb Estate Agents Ltd for themselves and for the vendors or lessors of this property whose agents they are give notice that (i) the particulars are set out as a general outline only for the guidance of intending purchasers or lessees, and do not constitute any part of an offer or contract (ii) all descriptions, dimensions, references to condition and necessary permissions for use and occupation, and other details are given in good faith and are believed to be correct and any intending purchaser or tenant should not rely on them as statements or representations of fact but must satisfy themselves by inspection or otherwise as to the correctness of each of them (iii) no person in the employment of Matthew Limb Estate Agents Ltd has any authority to make or give any representation or warranty whatever in relation to this property. If there is any point which is of particular importance to you, please contact the office and we will be pleased to check the information, particularly if you contemplate travelling some distance to view the property.

PHOTOGRAPH DISCLAIMER

In order to capture the features of a particular room we will mostly use wide angle lens photography. This will sometimes distort the image slightly and also has the potential to make a room look larger. Please therefore refer also to the room measurements detailed within this brochure.

VALUATION SERVICE

If you have a property to sell we would be delighted to provide a free/no obligation valuation and marketing advice. Call us now on 01482 669982.

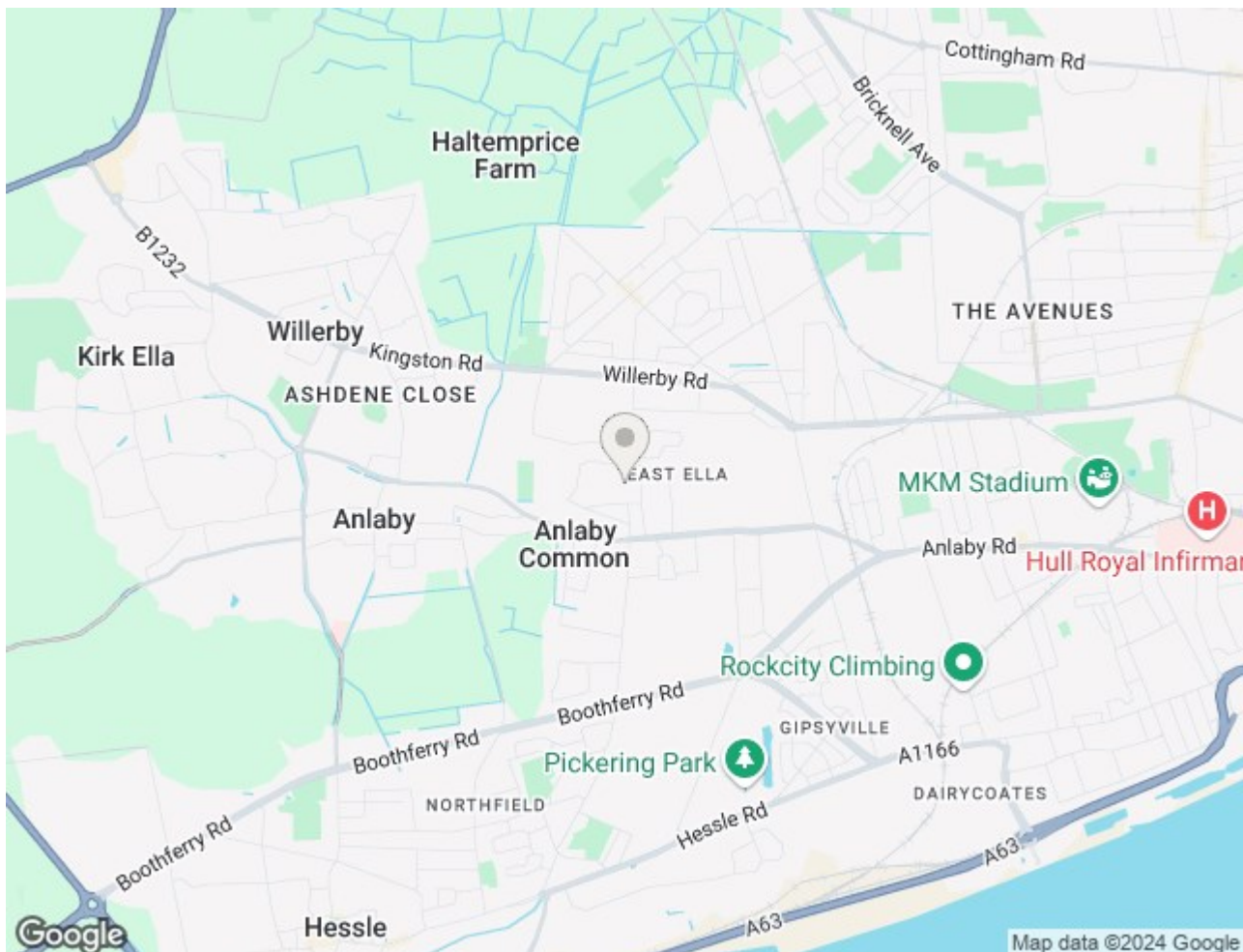

GROUND FLOOR

APPROX. 91.0 SQ. METRES (979.9 SQ. FEET)

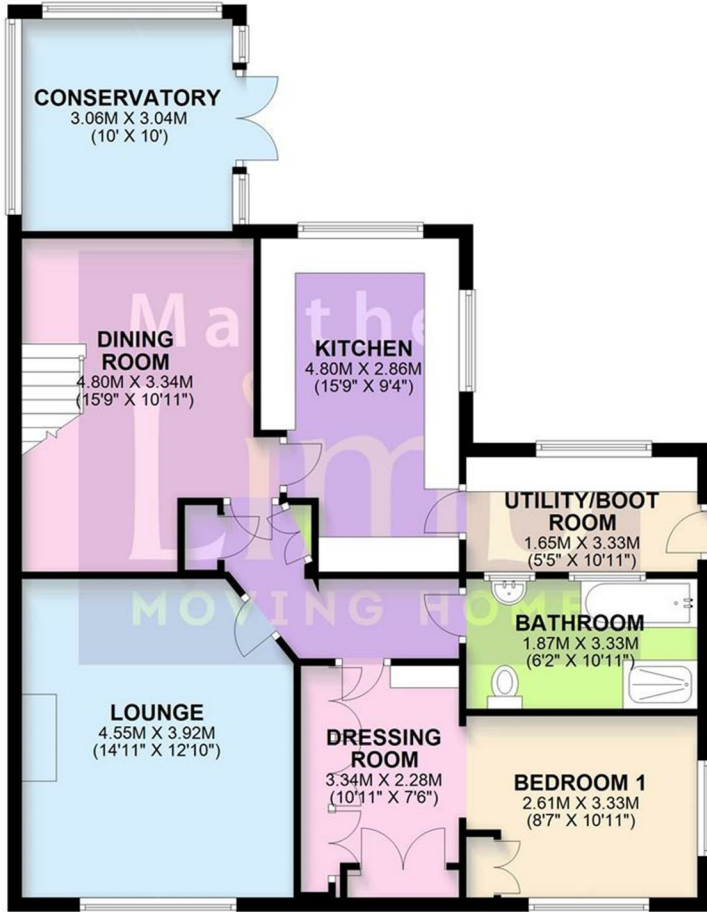

FIRST FLOOR

APPROX. 23.7 SQ. METRES (255.3 SQ. FEET)



TOTAL AREA: APPROX. 114.8 SQ. METRES (1235.2 SQ. FEET)

14 MOOR GREEN, ANLABY COMMON

