



6 Hinchin Brook, Nottingham, NG7 2EF

Price Guide £195,000



2



1



1



D

Floor Plan

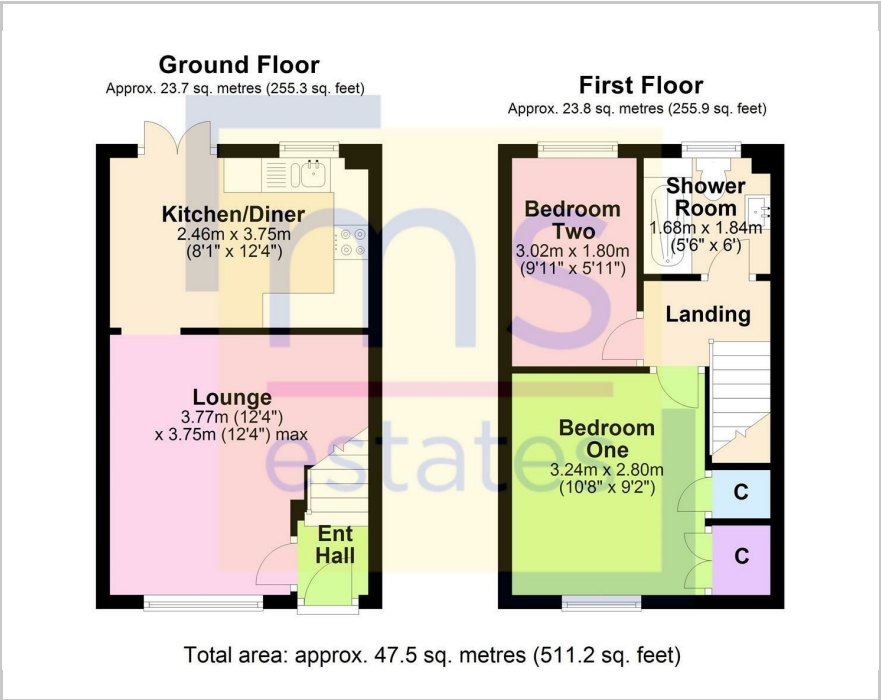

Area Map



- Modern 2-bed semi-detached.
- Breakfast kitchen.
- Separate lounge.
- Contemporary shower room.
- Gas central heating.
- Ample off-street parking.
- Good-sized rear garden.
- Popular Lenton location.
- Close to QMC, Uni & City Centre.
- Ideal for first-time buyers/investors.

Energy Efficiency Rating		
	Current	Potential
Very energy efficient - lower running costs		
(92 plus) A	<div>64</div>	<div>85</div>
(81-91) B		
(69-80) C		
(55-68) D		
(39-54) E		
(21-38) F		
(1-20) G		
Not energy efficient - higher running costs		
England & Wales		EU Directive 2002/91/EC 



These particulars, whilst believed to be accurate are set out as a general outline only for guidance and do not constitute any part of an offer or contract. Intending purchasers should not rely on them as statements of representation of fact, but must satisfy themselves by inspection or otherwise as to their accuracy. No person in this firm's employment has the authority to make or give any representation or warranty in respect of the property.