

The logo for 'ms estates' is located in the top right corner. It consists of the lowercase letters 'ms' in a bold, blue, sans-serif font, with a thin red horizontal line underneath. Below this, the word 'estates' is written in a smaller, blue, sans-serif font. The entire logo is set against a yellow square background with blue L-shaped corner accents.

405 Mansfield Road, Nottingham, NG5 2DP

£550 Per Month





## Floor Plan

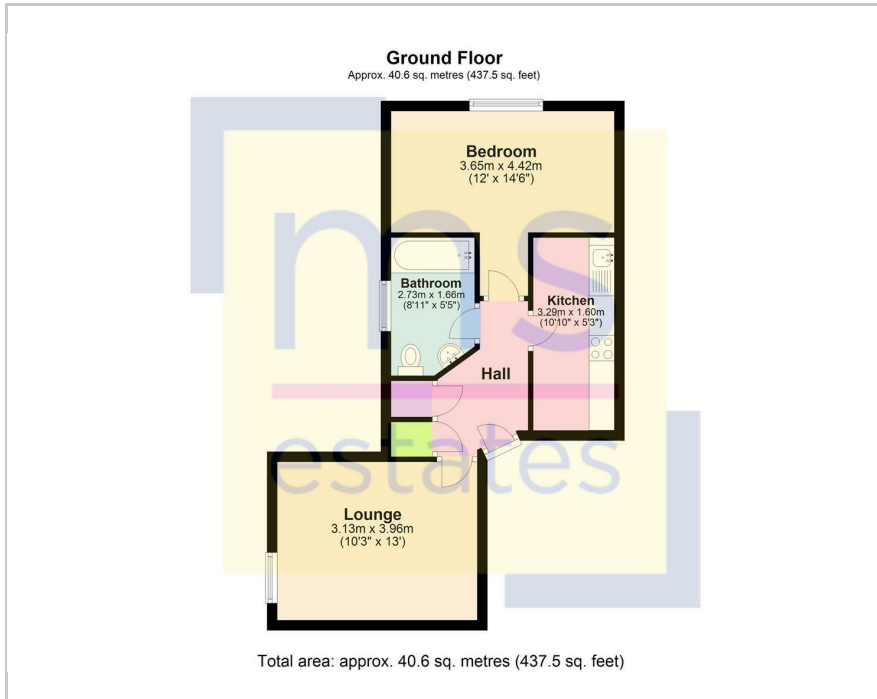

## Area Map



- Available immediately.
- One bedroom top floor flat.
- Newly refurbished throughout.
- New décor and carpets.
- New Kitchen. New Bathroom.
- Electric heating.
- Double glazing.
- Off street parking.
- Good commuter links.
- Close to local amenities.

## Viewing

Please contact our MS Estates Office on 0115 9120061 if you wish to arrange a viewing appointment for this property or require further information.

## Energy Efficiency Graph

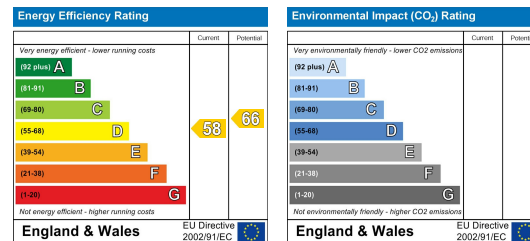

These particulars, whilst believed to be accurate are set out as a general outline only for guidance and do not constitute any part of an offer or contract. Intending purchasers should not rely on them as statements of representation of fact, but must satisfy themselves by inspection or otherwise as to their accuracy. No person in this firm's employment has the authority to make or give any representation or warranty in respect of the property.

3 Park Street, Derby Road, Lenton, Nottingham, NG7 1RR

Tel: 0115 9120061 Email: mail@ms-estates.co.uk www.ms-estates.co.uk