

The logo for 'ms estates' is located in the top right corner. It consists of the lowercase letters 'ms' in a bold, blue, sans-serif font, with a thin red horizontal line underneath. Below this, the word 'estates' is written in a smaller, blue, sans-serif font. The entire logo is set against a yellow square background with dark blue L-shaped corner accents.A semi-transparent version of the 'ms estates' logo is overlaid on the bottom right of the image. It features the same 'ms' and 'estates' text as the main logo, but in a lighter, semi-transparent font.

172 Harrington Drive, Nottingham, NG7 1JH
£320 Per Week

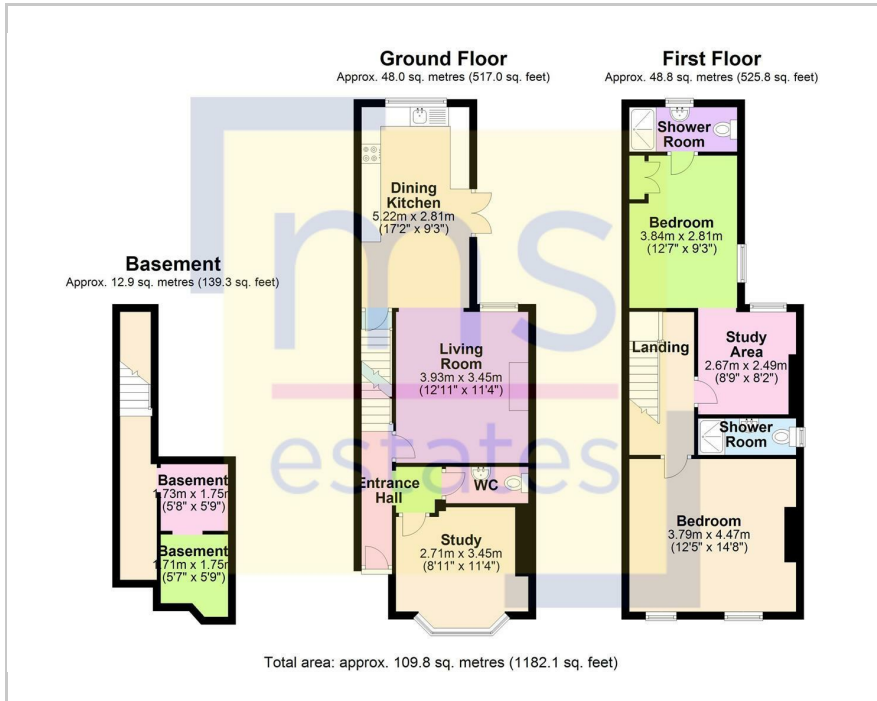

Floor Plan



Area Map



- STUDENT ACCOMMODATION.
- 2 double bedrooms.
- 2 study areas.
- Large dining kitchen and open plan living area.
- Beautifully presented throughout.
- Contemporary furniture.
- Modern kitchen & bathrooms.
- 2 en-suite shower rooms & separate WC.
- Close to local amenities.
- ARLA Registered Agent.

Energy Efficiency Rating

	Current	Potential
Very energy efficient - lower running costs		
(92 plus) A		
(81-91) B		
(69-80) C	69	80
(55-68) D		
(39-54) E		
(21-38) F		
(1-20) G		
Not energy efficient - higher running costs		
England & Wales	EU Directive 2002/91/EC	



These particulars, whilst believed to be accurate are set out as a general outline only for guidance and do not constitute any part of an offer or contract. Intending purchasers should not rely on them as statements of representation of fact, but must satisfy themselves by inspection or otherwise as to their accuracy. No person in this firm's employment has the authority to make or give any representation or warranty in respect of the property.

3 Park Street, Derby Road, Lenton, Nottingham, NG7 1RR

Tel: 0115 9120061 Email: mail@ms-estates.co.uk www.ms-estates.co.uk