



£1,850,000 Freehold
CLEVELAND ROAD, EALING, W13 8AH





A VERY SPACIOUS SIX BEDROOM LATE EDWARDIAN DETACHED FAMILY HOME WITH SOUTH FACING GARDEN.

Cleveland Road is well situated close to both Cleveland Park / Pitshanger Park and Scotch Common within easy reach of the popular Pitshanger Village, new Elizabeth Line, Crossrail Station at West Ealing. The property is also well served by local bus services and falling within numerous good schools including Notting Hill, St Benedict's, and Drayton Manor.

This welcoming and very roomy period detached dwelling with very generous living accommodation arranged over three floors includes: Two large reception rooms. Super-sized kitchen /dining room. Reception hall. Downstairs cloakroom and conservatory. Five double bedrooms. Family bathrooms. Study / 6th Bedroom. Two en suites. South aspect garden with garden office with power supply. Gas fired central heating. Double glazing. Off street parking for at least 4 cars.

COUNCIL TAX BAND: G

EPC Rating: D



 www.sintonandrews.com
020 8566 1990

GROUND FLOOR

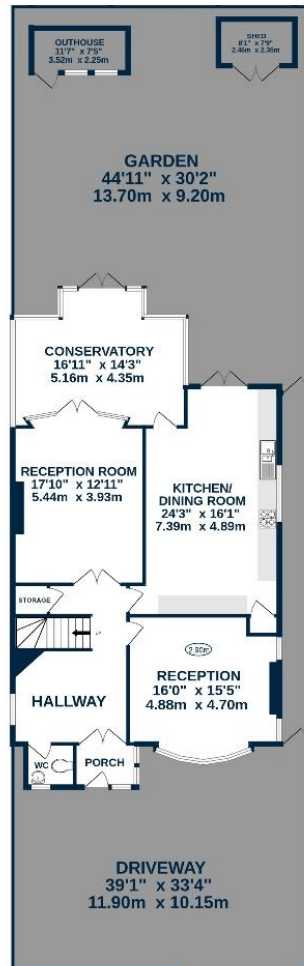

1ST FLOOR



2ND FLOOR



 = Ceiling Height

TOTAL FLOOR AREA : 2953sq.ft. (274.3 sq.m.) approx.

Whilst every attempt has been made to ensure the accuracy of the floorplan contained here, measurements of doors, windows, rooms and any other items are approximate and no responsibility is taken for any error, omission or mis-statement. This plan is for illustrative purposes only and should be used as such by any prospective purchaser. The services, systems and appliances shown have not been tested and no guarantee as to their operability or efficiency can be given.
Made with Metropix ©2024

020 8566 1990

8 Spring Bridge Road, Ealing, London W5 2AA

SINTONANDREWS.COM

