

[illegible]

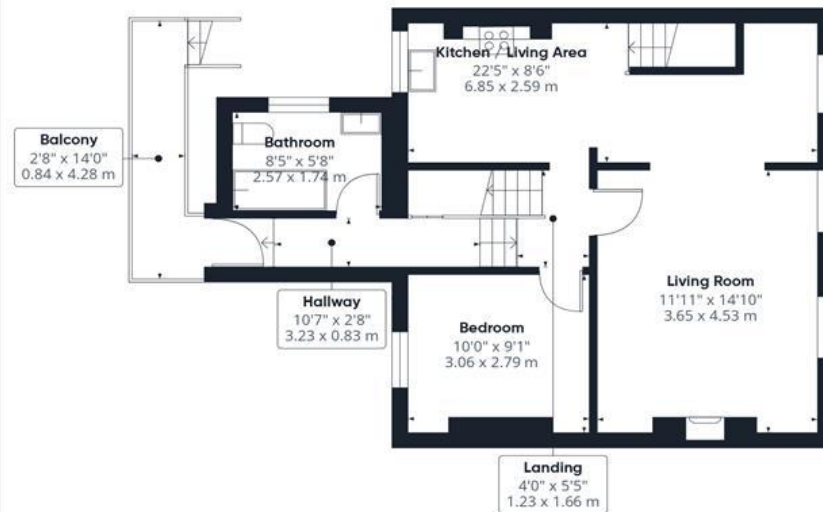



Floor 1

[illegible]Approximate total area⁽¹⁾[illegible][illegible]

Balconies and terraces

43 ft²4 m²

Reduced headroom

1 ft²0.1 m²

(1) Excluding balconies and terraces

Reduced headroom

----- Below 5 ft/1.5 m

Calculations reference the RICS IPMS 3C standard. Measurements are approximate and not to scale. This floor plan is intended for illustration only.

GIRAFFE360

