



## Lydford Road, NW2

### Leasehold - £995,000

We are excited to present For Sale this three-bedroom Garden Flat, offering 1,150 sq ft of living space. Situated a short stroll away from the wonderful 86-acre Gladstone Park.

The property features a generously-sized 25 ft reception room bathed in natural light through French doors. The modern white kitchen/diner, equipped with bi-folding doors, opens to a private garden. The rear garden offers a peaceful retreat with a decked area and well-maintained lawn. There are three spacious bedrooms, two of which come with built-in wardrobes. The family bathroom is stylishly finished with a free-standing bath, metro tiling, and a shower.

Conveniently located near Willesden Green's vibrant amenities, including Walm Lane's diverse delis and restaurants. Transport links include Willesden Green Station (Jubilee Line - Zone 2)

- 3 bedroom Garden Flat - 1,150 sqft
- Spacious rooms with high ceilings
- A private 58 ft decked rear garden
- Council: Brent (E)

020 8459 1133

[enquiries@cameronsstiff.co.uk](mailto:enquiries@cameronsstiff.co.uk)

[cameronsstiff.co.uk](http://cameronsstiff.co.uk)













## Lydford Road, London, NW2

Approximate Area = 1134 sq ft / 105.3 sq m

For identification only - Not to scale

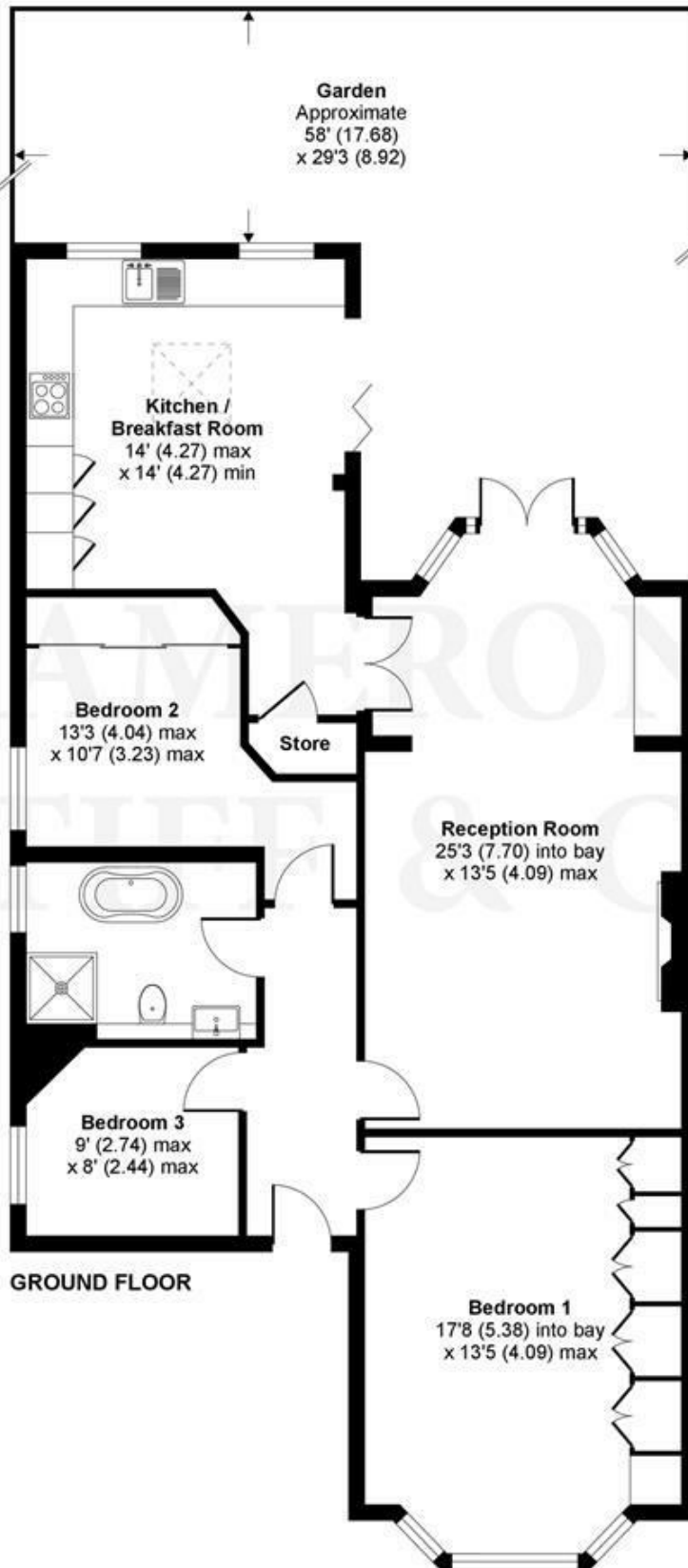

EPC: C

Ref: 15637973



Certified  
Property  
Measurer

Floor plan produced in accordance with RICS Property Measurement Standards incorporating International Property Measurement Standards (IPMS2 Residential). © nichecom 2021.  
Produced for Camerons Stiff & Co. REF: 768819

