



Solent Road, NW6

Freehold - £1,500,000

FOR SALE and offered CHAIN FREE is this four-bedroom family home in the heart of West Hampstead, offering 1,570 sq ft across three floors.

Full of character, the property retains original fireplaces and ceiling mouldings. The Ground Floor features a bright, airy lounge, a separate dining room, and a kitchen with potential for renovation. The kitchen leads to a rear garden. The First Floor includes three spacious bedrooms, one with built-in wardrobes and another with a balcony. Upstairs, the principal bedroom offers ample storage and an en-suite bathroom.

Solent Road is a quiet, tree-lined residential street with easy access to local amenities such as boutique shops, cafes, and restaurants along West End Lane and Finchley Road. Excellent transport links include West Hampstead (Jubilee, Overground, and Thameslink - Zone 2), offering convenient access to Central London.

- Offered CHAIN FREE
- 4 bedroom family home - 1,570 sq ft over three floors
- Retains original fireplaces and ceiling mouldings
- Council: Camden (G)

020 8459 1133

enquiries@cameronsstiff.co.uk

cameronsstiff.co.uk







Solent Road, London, NW6

Approximate Area = 1570 sq ft / 145.8 sq m

For identification only - Not to scale

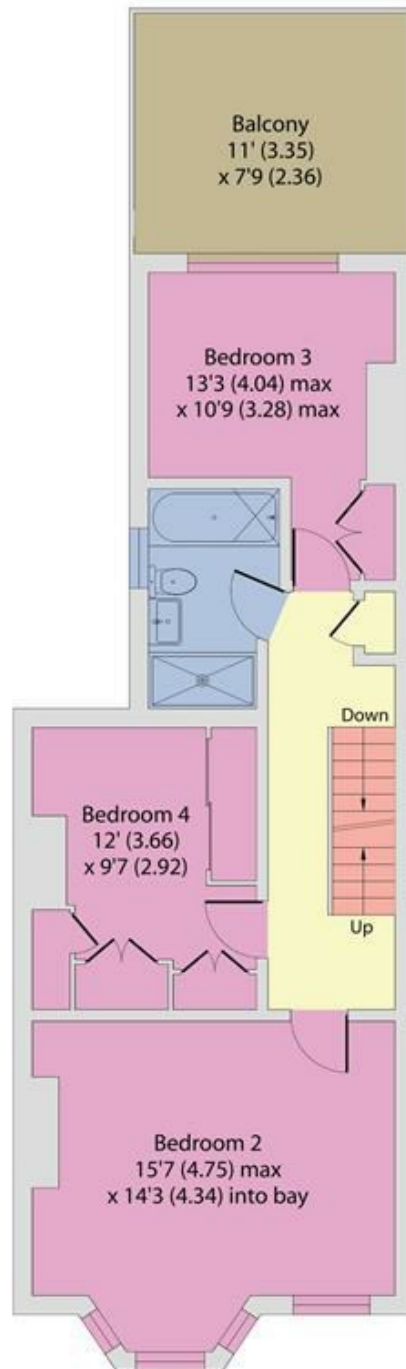
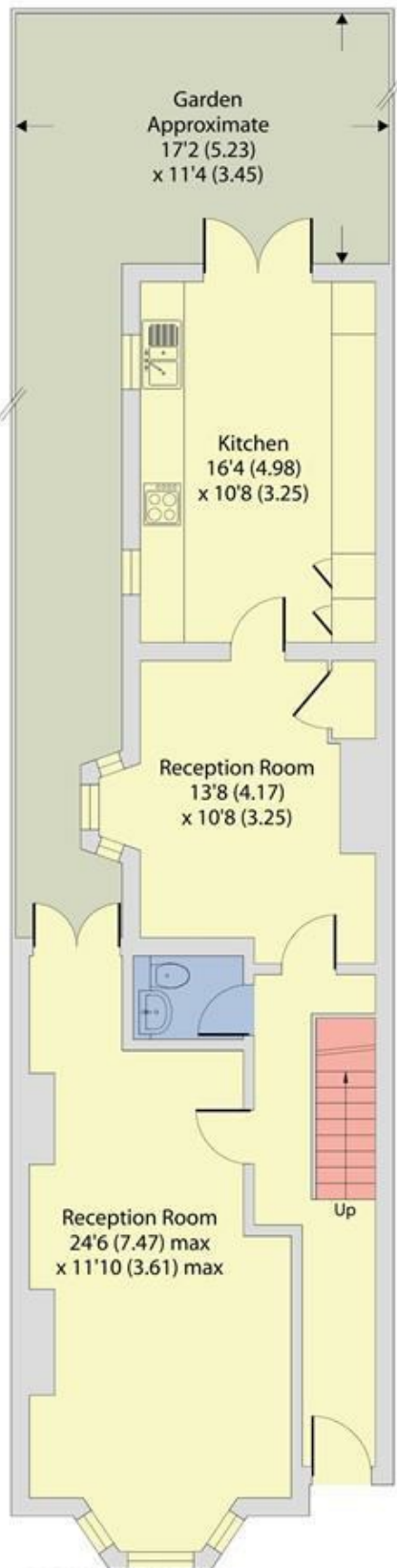

Floor plan produced in accordance with RICS Property Measurement 2nd Edition, Incorporating International Property Measurement Standards (IPMS2 Residential). Produced for Camerons Stiff & Co. REF: 1247197

EPC: D
Ref: 19216143

