



## Brondesbury Park, NW6

### Share of Freehold - £399,950

For Sale is this one bedroom Ground Floor flat. Offering 650 sq ft of well-presented accommodation, set in this renowned purpose built mansion block in Brondesbury Park.

This property boasts a spacious reception area, a modern kitchen and a generously sized double bedroom, complemented by a recently refurbished family bathroom. Residents of Blandford Court can also enjoy communal gardens. Further benefits include a private garage.

Situated in an sought after location in Brondesbury Park, close to the open spaces of Queens Park and all the cafes and eateries of Salusbury Road. Transport links are available via Brondesbury Park (Overground - Zone), Kilburn (Jubilee - Zone 2) and Queens Park (Bakerloo - Zone 2).

- Share of freehold - 900+ years lease
- 1 bedroom Ground Floor flat
- Offering 650 sq ft
- Private garage with re-felting roof
- Communal garden
- Council: Brent (C)

020 8459 1133

[enquiries@cameronsstiff.co.uk](mailto:enquiries@cameronsstiff.co.uk)

[cameronsstiff.co.uk](http://cameronsstiff.co.uk)



## Brondesbury Park, London, NW6 7BP

Approximate Area = 650 sq ft / 60.4 sq m

For identification only - Not to scale

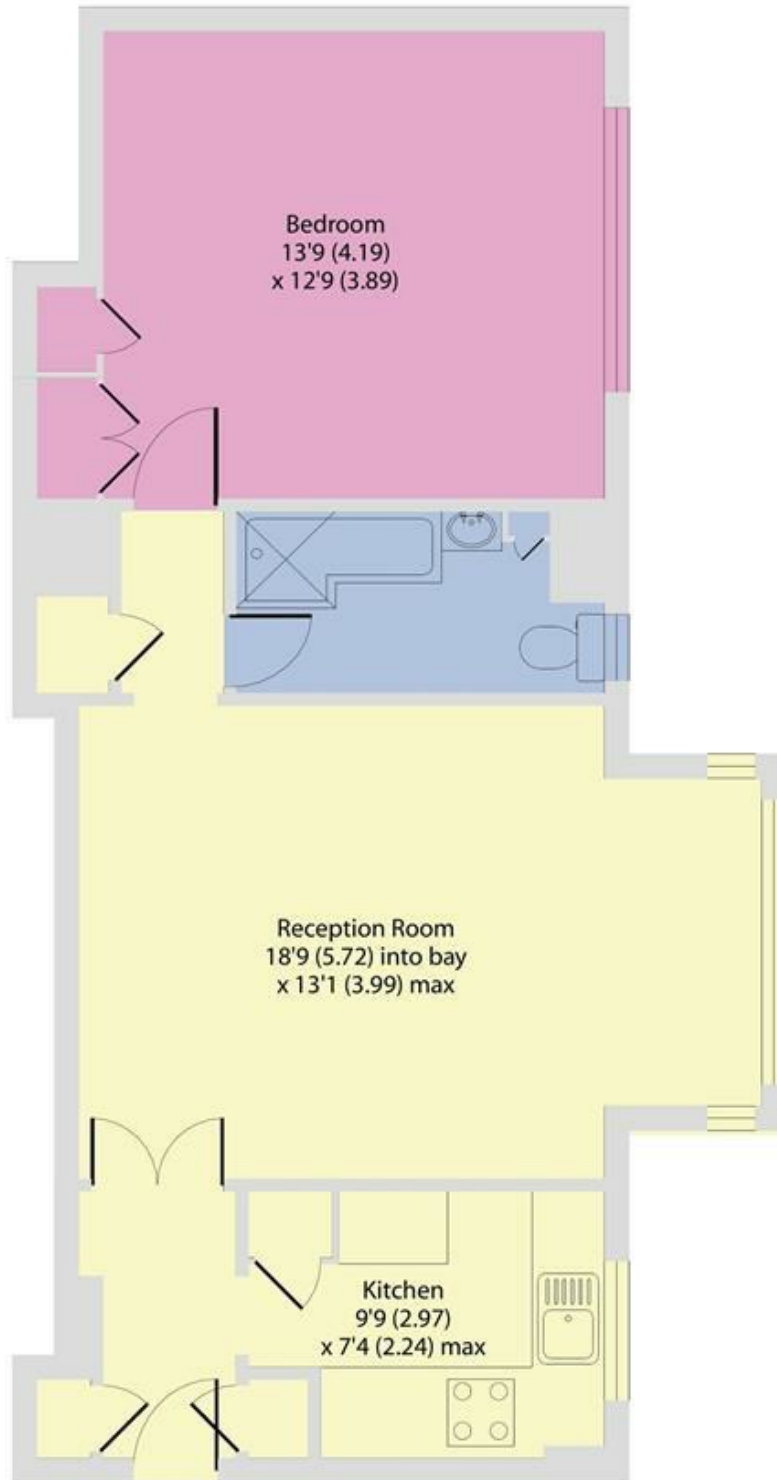

GROUND FLOOR

EPC: C

Ref: 15063686



Floor plan produced in accordance with RICS Property Measurement Standards incorporating International Property Measurement Standards (IPMS2 Residential). © n'cheom 2024. Produced for Camerons Stiff & Co. REF: 277326

