



Pine Road, NW2

Freehold - £795,000

FOR SALE is this refurbished three bedroom Period mid-terraced house offering 1,458 sq ft of well-proportioned accommodation set in the heart of Cricklewood.

The Ground Floor is comprised of a bright bay fronted reception room, dining room, modern kitchen with access to a 17 ft private rear garden and a downstairs shower room. The First Floor features three double bedrooms serviced by a three piece family bathroom. The property is offered with vacant possession and there is potential to extend at the side and into the loft (SSTP).

Pine Road is moments away from Cricklewood Broadway and Willesden Green. The area offers an excellent array of local bars, restaurants and the green open spaces of the award winning 86-acre Gladstone Park. Transport links include Cricklewood Thameslink (Zone 3) and Willesden Green (Jubilee Line - Zone 2).

- Refurbished 3 bedroom mid-terraced Period house
- Offering 1,458 sq ft of accommodation over 2 floors
- Potential to extend at the side and into the loft (SSTP)
- Brand new boiler & central heating system
- New electrical rewiring, loft & floor insulation
- COUNCIL: Brent (D)

020 8459 1133

enquiries@cameronsstiff.co.uk

cameronsstiff.co.uk



Pine Road, London, NW2

Approximate Area = 1458 sq ft / 135.4 sq m

For identification only - Not to scale

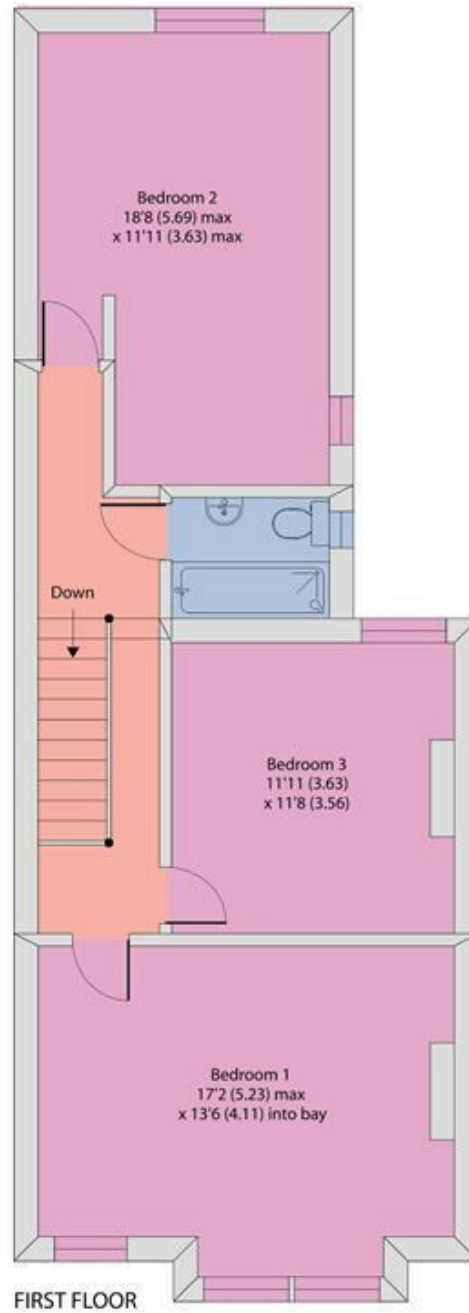

EPC: D

Ref: 18703142



Floor plan produced in accordance with RICS Property Measurement Standards incorporating International Property Measurement Standards (IPMS2 Residential). © nichecom 2024. Produced for Camerons Stiff & Co. REF: 1155382

