



## Huddleston Road, NW2

### Leasehold - £570,000

FOR SALE and offered with vacant possession is this stunning two bedroom First Floor Flat set within the converted Willesden Green Baptist Church, offering 681 sq ft of well laid out accommodation.

With a unique blend of historical charm and modern design, the property retains many original features including wood-framed roof beams and stained glass windows. The flat comprises an open-plan kitchen/reception room with a breakfast bar, the main bedroom with an en-suite shower room and a second double bedroom which is serviced by a family bathroom.

The property is situated close to Willesden Green and Walm Lane, which offers a multitude of local delis, bars and restaurants. The green open spaces of popular 86-acre Gladstone Park is moments away with its outdoor gym, tennis courts and a café, a hub for the local community. Transport links include Willesden Green (Jubilee - Zone 2) and 24-hour bus routes into Central London.

- Offered with vacant possession
- Stunning 2 bedroom First Floor Flat
- Set in the converted Willesden Green Baptist Church
- Original features throughout
- Transport Links: Willesden Green (Jubilee - Zone 2)
- COUNCIL: Brent (D)

020 8459 1133

[enquiries@cameronsstiff.co.uk](mailto:enquiries@cameronsstiff.co.uk)

[cameronsstiff.co.uk](http://cameronsstiff.co.uk)



## Huddlestone Road, London, NW2

Approximate Area = 681 sq ft / 63.3 sq m

For identification only - Not to scale

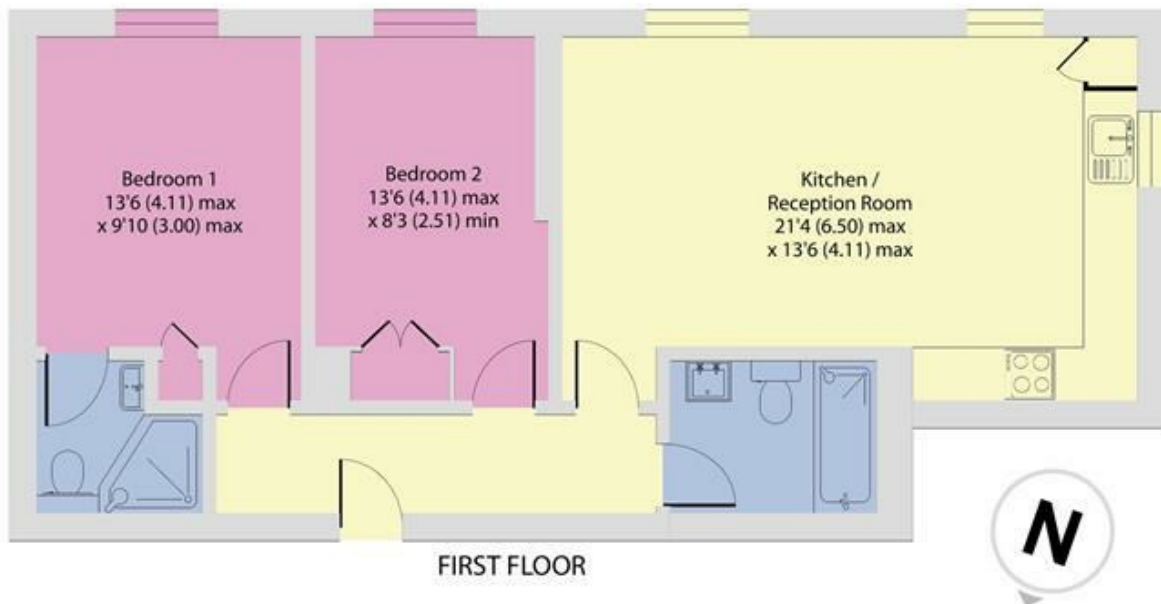

### EPC:

Ref: 18903637



Floor plan produced in accordance with RICS Property Measurement Standards incorporating International Property Measurement Standards (IPMS2 Residential). © nichecom 2024. Produced for Camerons Stiff & Co. REF: 1129701

