



Chandos Road, NW2

Share of Freehold - £500,000

FOR SALE is this Ground Floor, two-bedroom apartment tucked away on the corner of Chandos Road. Spanning 816 sq ft, this property effortlessly combines comfort and convenience, making it a truly remarkable find.

The spacious living area provides an ideal space for both entertaining and relaxation, thanks to the abundant natural light that fills the rooms. Featuring two generously sized bedrooms, this flat allows for various possibilities.

The flat is within close proximity to Willesden Green Station (Jubilee - Zone 2), connecting you effortlessly to London's major hotspots. Nearby a delightful array of shops, restaurants, and cafes, creating a vibrant local scene for you to explore. The 86 acre Gladstone Park is on your doorstep offering a peaceful place to walk and enjoy the sports available there.

- 2 bedroom apartment offering 816 sq ft
- Well-presented throughout
- Close to the 86 acre Gladstone Park
- Good transport links
- COUNCIL: Brent (D)

020 8459 1133

enquiries@cameronsstiff.co.uk

cameronsstiff.co.uk



Chandos Road, London, NW2

Approximate Area = 816 sq ft / 75.8 sq m

For identification only - Not to scale

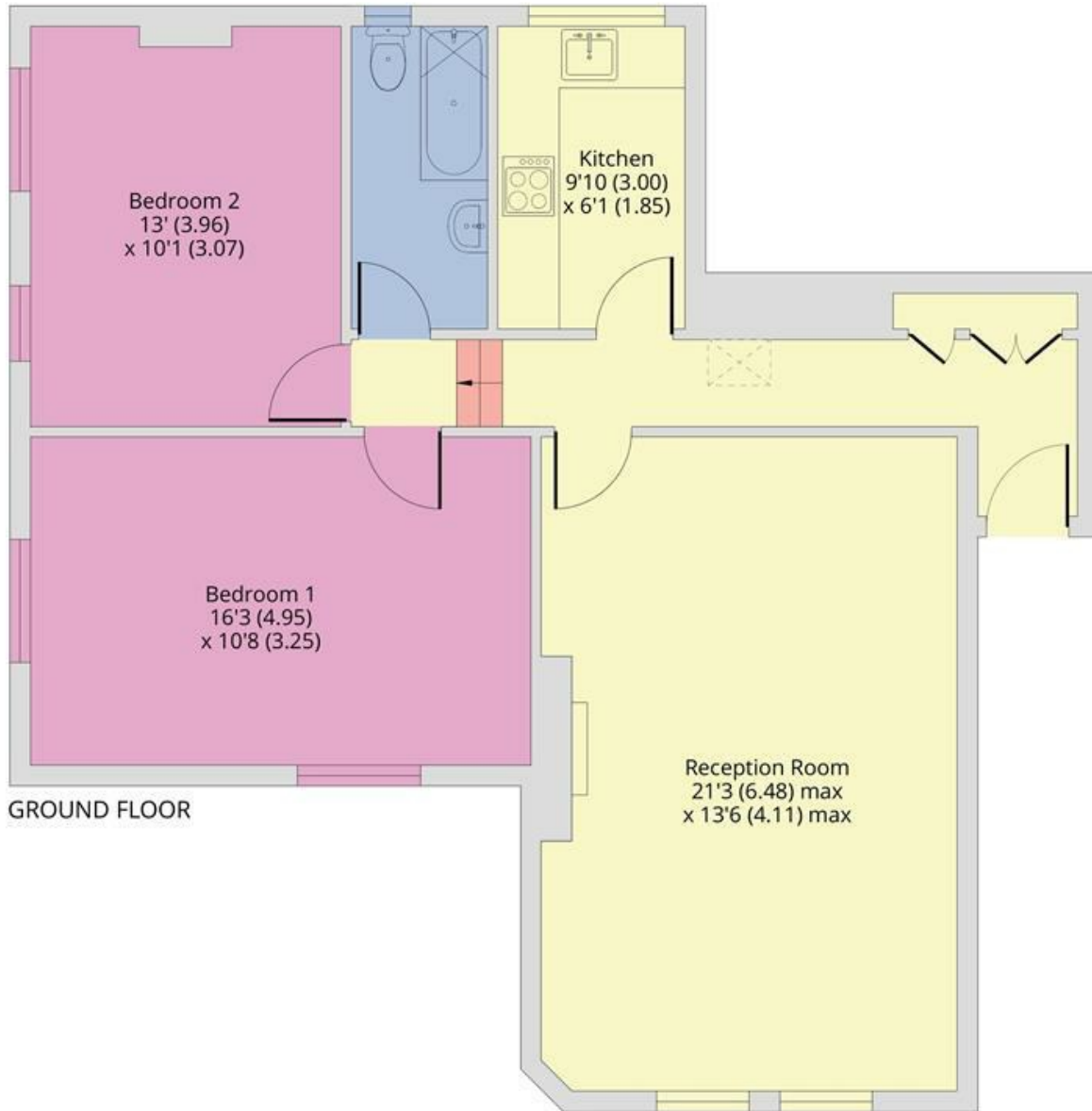

GROUND FLOOR



Floor plan produced in accordance with RICS Property Measurement Standards incorporating International Property Measurement Standards (IPMS2 Residential). © n'cheom 2024. Produced for Camerons Stiff & Co. REF: 1007663

EPC: D
Ref: 18517838

