



Chambers Lane, NW10

Leasehold - £525,000

For Sale is this two bedroom Ground Floor flat, offering 724 sq ft, set within a period property situated on Chambers Lane. Close to the exclusive Dobree Estate, the property is in good condition, with scope for the next person to make it their own.

The flat has its own entrance and comprises a bright and spacious reception room with a feature fireplace and access to the 76 ft south-facing private garden, a separate fully fitted kitchen, two double bedrooms and a bathroom.

Chambers Lane is a tree lined street with Roundwood Park to the west and Willesden Sports Grounds and Queen's Park to the south. The property is ideally located to access the amenities of Kensal Rise and Willesden Green.



- 2 bedroom garden flat offering 724 sq ft of accommodation
- Long lease (925 years remaining)
- Allocated parking space in front of the building
- Transport: Brondesbury Park (Overground) & Willesden Green (Jubilee - Zone 2)
- COUNCIL: Brent (D)

020 8459 1133

enquiries@cameronsstiff.co.uk

cameronsstiff.co.uk







Chambers Lane, London, NW10

Approximate Area = 724 sq ft / 67.3 sq m

For identification only - Not to scale

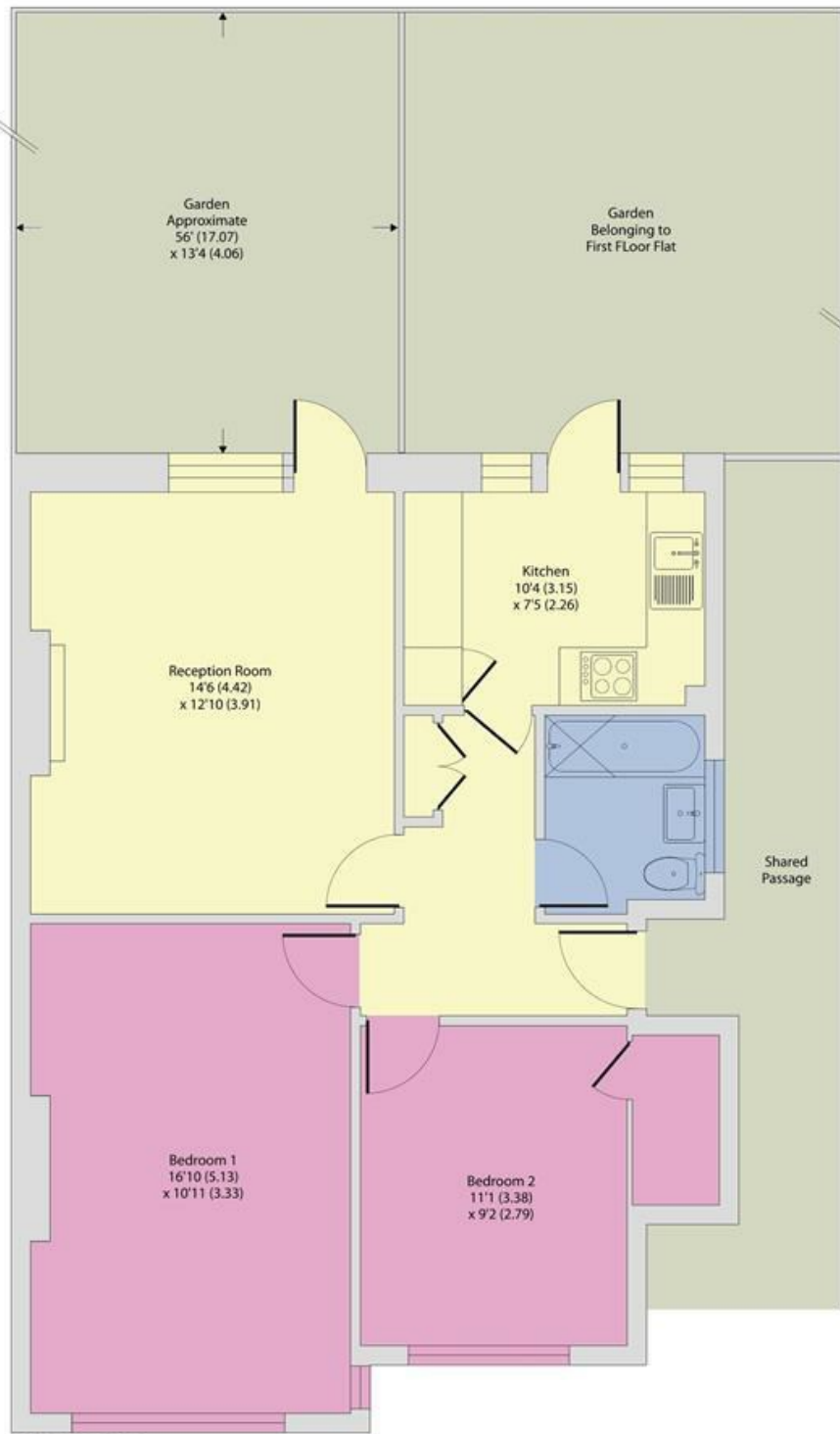

GROUND FLOOR



Floor plan produced in accordance with RICS Property Measurement Standards incorporating International Property Measurement Standards (IPMS2 Residential). © nlcocom 2024. Produced for Camerons Stiff & Co. REF: 1115526

EPC: C

Ref: 18809486

