

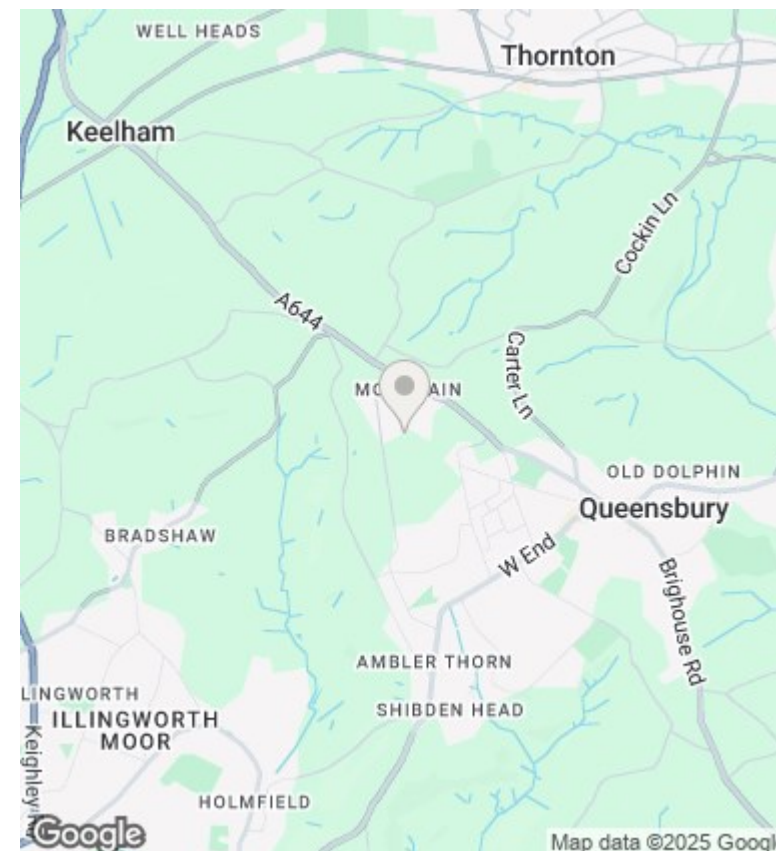

21 Tree Top View, Mountain, Queensbury, Bradford, BD13 1NT

Auction Guide £160,000

- THREE BEDROOM SEMI DETACHED
- BUYERS FEES APPLICABLE
- CLOSE TO FOX HILL PRIMARY SCHOOL
- PRICED TO SELL.... VIEW, BID & BUY
- FOR SALE BY MODERN METHOD OF AUCTION
- DRIVE FOR SEVERAL CARS
- GAS CENTRAL HEATING
- SUBJECT TO AN UNDISCLOSED RESERVE FEE
- CONSERVATORY TO THE REAR
- DOUBLE GLAZING

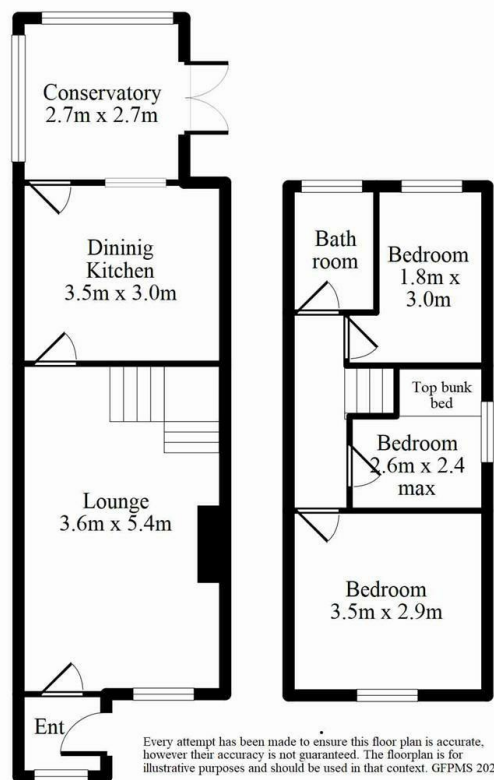

Directions

Viewings

Viewings by arrangement only.
Call 01274884040 to make an appointment.

Council Tax Band

B

EPC Rating:

C

Energy Efficiency Rating		
	Current	Potential
Very energy efficient - lower running costs		
(92 plus) A		
(81-91) B		84
(69-80) C	69	
(55-68) D		
(39-54) E		
(21-38) F		
(1-20) G		
Not energy efficient - higher running costs		
England & Wales		EU Directive 2002/91/EC