



SIBLEY PARES

CHARTERED SURVEYORS & ESTATE AGENTS

Riverbank

Maidstone, Kent, ME15 7RZ

Guide Price £170,000

Riverbank

Maidstone, Kent, ME15 7RZ

Key Features

- Two Bedroom Apartment
- Kitchen with Integrated Appliances
- No Onward Chain
- South Facing Balcony
- Two Allocated Parking Spaces
- Walking Distance to Maidstone Town Centre

Description

Two bedroom ground floor apartment close to the town centre with two allocated parking spaces and within walking distance of Maidstone Town Centre.

The apartment is accessed via a communal area on the ground floor and comprises spacious entrance hall, living room with balcony enabling you to enjoy a south facing view over the protected nature reserve, modern fitted kitchen with integral appliances, including dishwasher, washing machine, fridge freezer and electric oven and hob, primary bedroom with built in wardrobe, second bedroom and bathroom with shower over bath.

The property also benefits from two allocated parking spaces and electric heating.

Lease length of 999 years from 1.6.1998

Service Charge: TBC

Ground Rent: TBC



Riverbank

Maidstone, Kent, ME15 7RZ

Location

Maidstone town centre is just a short walk from this property, with Sainsbury to hand. You can then enjoy the highlights of the town with its variety of clubs, pubs and restaurants as well as take advantage of shows at the Hazlitt Theatre and the Odeon Cinema complex.

The M20 motorway junction 7 is just a couple of miles along the Sittingbourne Road giving you access to most areas of Kent. The mainline railway station at Maidstone East runs a service to London Victoria, while Maidstone West runs the High Speed Rail Link to St Pancras, as well as the Medway Valley Line from Paddock Wood to Strood.

For all Viewings and Enquiries contact:



Mr Mitchell Bourner
mitchell.bourner@sibleypares.co.uk



Mr Marcus Monger
Marcus.monger@sibleypares.co.uk



SIBLEY PARES

CHARTERED SURVEYORS & ESTATE AGENTS

01622 673086

sibleypares.co.uk





Floorplan and Dimensions

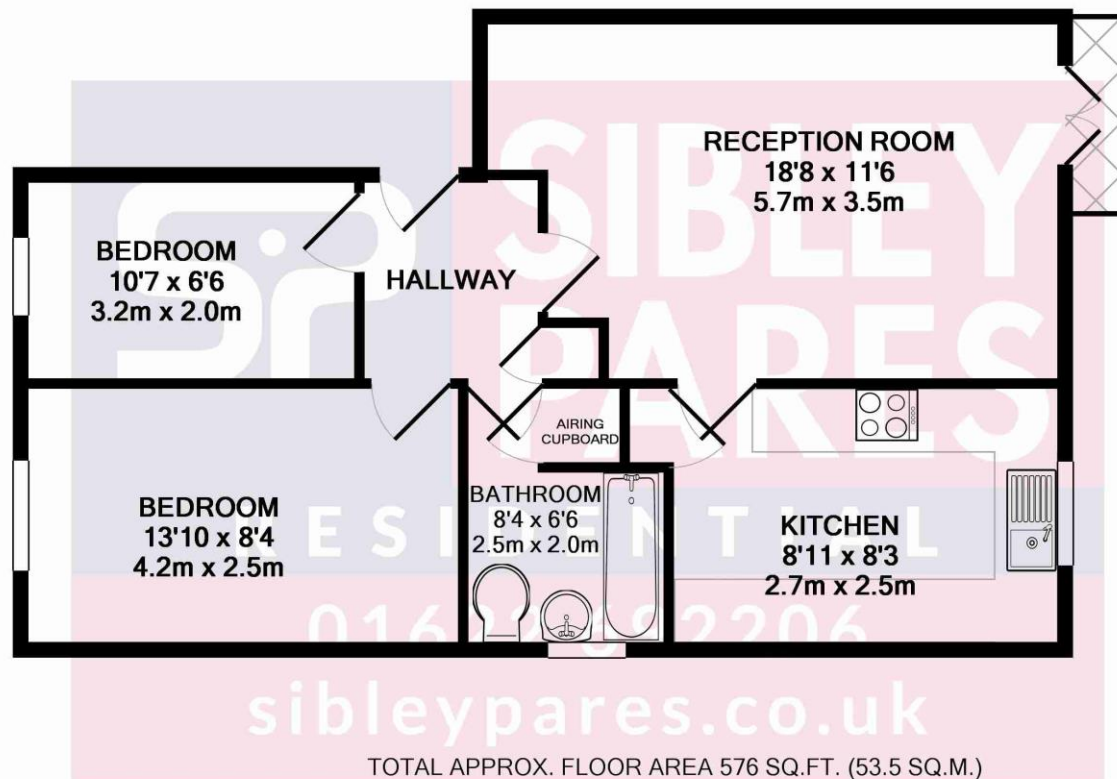

Whilst every attempt has been made to ensure the accuracy of the floor plan contained here, measurements of doors, windows, rooms and any other items are approximate and no responsibility is taken for any error, omission, or mis-statement. This plan is for illustrative purposes only and should be used as such by any prospective purchaser. The services, systems and appliances shown have not been tested and no guarantee as to their operability or efficiency can be given
Made with Metropix ©2016

NOTE: Rental, prices or any other charges are inclusive of VAT unless otherwise stated.

MISREPRESENTATION ACT 1967. These particulars are believed to be correct, their accuracy cannot be guaranteed and are expressly excluded from any other contract. Any intending purchaser must satisfy himself by inspection or otherwise as to the correctness of each of the statements contained in these particulars. No fittings, appliances or services mentioned have been tested by Sibley Pares. Please note that in accordance with Money Laundering Regulations, we are now required to obtain proof of identity for purchasers.



1 Ashford Road, Maidstone, Kent ME14 5BJ
sibleypares.co.uk | Maidstone (01622) 673086 | Ashford (01233) 629281

Partners: Sarah Raggett, BSc (Hons) MRICS | Phillip Hubbard, BA (Hons) MRICS
Sibley Pares Chartered Surveyors is a trading name of Sibley Pares LLP

Registered in England and Wales No: OC400776. | Registered as above. | VAT Reg No: 218 5130 30.