



SIBLEY PARES

CHARTERED SURVEYORS & ESTATE AGENTS

2 Albion Place

Maidstone, Kent, ME14 5DY

£150,000 No Onward Chain

2 Albion Place

Maidstone, Kent, ME14 5DY

Key Features

- One Bedroom Apartment
- Modern Fitted Kitchen
- Allocated Parking Space
- Town Centre Location
- Redecorated Throughout
- Modern Kitchen with Appliances

Description

One bedroom apartment available with its own private entrance and benefitting from no onward chain and a share of the freehold. The property has been re-decorated throughout and would be an ideal purchase for a first time buyer, wanting to get onto the property ladder, or buy to let investor.

This modern apartment has been finished to a very high standard throughout and comprises open plan lounge/kitchen with appliances, primary bedroom with en-suite shower room and storage cupboard.

The property also benefits from one allocated parking space, gas central heating and double glazed sash windows.

Lease Details:

Lease of 125 years from 1/1/2014

Service Charge: £821.43 pa

Ground Rent: Share of the freehold



2 Albion Place

Maidstone, Kent, ME14 5DY

Location

The property is within walking distance of Maidstone town Centre offering a variety of shops and leisure activities and Maidstone East & West rail stations, providing direct routes to London and the coast. The M20 motorway is close by offering good access to motorway links such as the M2, also providing good access to London and the coast.

■ EPC Rating TBC

■ Council Tax Band A

■ Maidstone Borough Council

■ For Broadband Speed Refer to the Ofcom Website

For all Viewings and Enquiries contact:



Mr Mitchell Bourner
mitchell.bourner@sibleypares.co.uk



Mr Marcus Monger
marcus.monger@sibleypares.co.uk



SIBLEY PARES

CHARTERED SURVEYORS & ESTATE AGENTS

01622 673086

sibleypares.co.uk



SIBLEY PARES
CHARTERED SURVEYORS & ESTATE AGENTS



Floorplan and Dimensions

GROUND FLOOR
333 sq.ft. (31.0 sq.m.) approx.

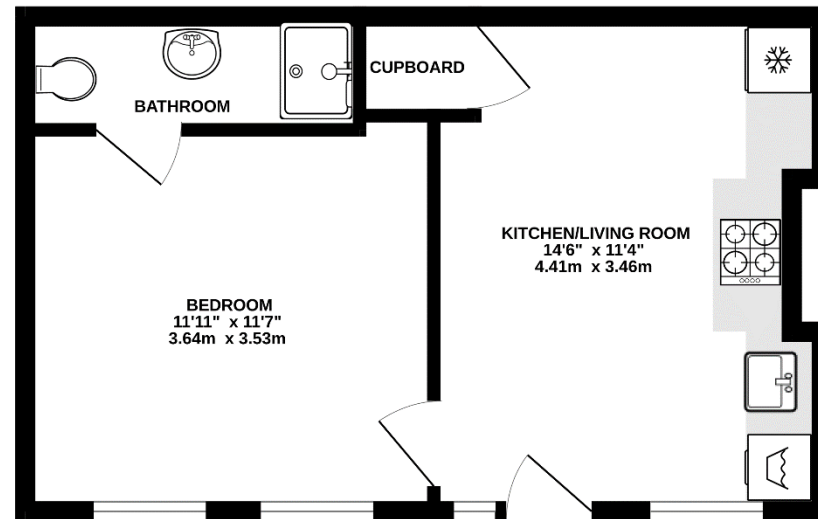

TOTAL FLOOR AREA : 333 sq.ft. (31.0 sq.m.) approx.

Whilst every attempt has been made to ensure the accuracy of the floorplan contained here, measurements of doors, windows, rooms and any other items are approximate and no responsibility is taken for any error, omission or mis-statement. This plan is for illustrative purposes only and should be used as such by any prospective purchaser. The services, systems and appliances shown have not been tested and no guarantee as to their operability or efficiency can be given.
Made with Metrepro ©2024

NOTE: Rental, prices or any other charges are inclusive of VAT unless otherwise stated.

MISREPRESENTATION ACT 1967. These particulars are believed to be correct, their accuracy cannot be guaranteed and are expressly excluded from any other contract. Any intending purchaser must satisfy himself by inspection or otherwise as to the correctness of each of the statements contained in these particulars. No fittings, appliances or services mentioned have been tested by Sibley Pares. Please note that in accordance with Money Laundering Regulations, we are now required to obtain proof of identity for purchasers.



1 Ashford Road, Maidstone, Kent ME14 5BJ
sibleypares.co.uk | Maidstone (01622) 673086 | Ashford (01233) 629281

Partners: Sarah Raggett, BSc (Hons) MRICS | Phillip Hubbard, BA (Hons) MRICS
Sibley Pares Chartered Surveyors is a trading name of Sibley Pares LLP

Registered in England and Wales No: OC400776. | Registered as above. | VAT Reg No: 218 5130 30.