

HUNTERS[®]

HERE TO GET *you* THERE



Dorchester Road

Stourbridge, DY9 0XB

£475,000



Council Tax: D



Dorchester Road

Stourbridge, DY9 0XB

£475,000



Front Of The Property

With a tarmac driveway leading to garage, gated access to both sides, large lawn and a further tarmac driveway to side.

Entrance Hall

With a door to front, double glazed window to front, doors to rooms, stairs to the first floor landing, tiled floor, under stairs storage cupboard and a central heating radiator.

Cloakroom

With a door from the entrance hall, WC, wash hand basin, tiled splashback and tiled floor.

Dining Room

13'1" x 11'10" (4.01 x 3.63)

With a door from the entrance hall, double glazed bay window to front, wall lights and a central heating radiator.

Lounge

13'0" x 13'1" (3.97 x 4.00)

With a door from the entrance hall, double glazed patio doors to rear, double glazed bay window to side, decorative fire surround and a central heating radiator.

Kitchen Breakfast Room

9'7" x 19'3" (2.93 x 5.87)

With a door from the entrance hall, fitted wall and base units, work surfaces with tiled splashback, one and a half sink and drainer, integrated oven, gas hob, extractor fan, integrated fridge and dishwasher, plumbing for washing machine, walk in pantry cupboard, two double glazed windows to rear, double glazed door to side, door to garage, tiled floor and a central heating radiator.

Landing

With stairs from the entrance hall, loft access with fitted ladders and doors to rooms.

Bedroom One

13'6" x 11'5" (4.14 x 3.5)

With a door from the landing, double glazed windows to front and side, fitted wardrobes, matching dressing table, matching bedside table and a central heating radiator.

Bedroom Two

13'0" x 11'3" (3.97 x 3.43)

With a door from the landing, double glazed window to front, laminate floor and a central heating radiator.

Bedroom Three

11'0" x 10'11" (3.36 x 3.34)

With a door from the landing, double glazed windows to rear and side, and a central heating radiator.

Bedroom Four

8'1" x 10'1" (2.47 x 3.09)

With a door from the landing, double glazed windows to rear and side, laminate floor and a central heating radiator.

Bedroom Five

9'10" x 7'4" (3.02 x 2.25)

With a door from the landing, double glazed window to front and a central heating radiator.

Bathroom

With a door from the landing, double glazed window to rear, corner bath with shower over, fitted glass shower screen, WC, wash hand basin, part tiled walls, tiled floor and a central heating radiator.

Garden

With double glazed patio doors from the lounge to a large block paved patio, steps up to lawn with mature shrub borders, summerhouse to rear, gated access to both sides, outside tap and power points.

Garage

17'0" x 8'1" (5.2 x 2.47)

With a garage door to front, power, light and door to kitchen.



Road Map



Hybrid Map



Terrain Map

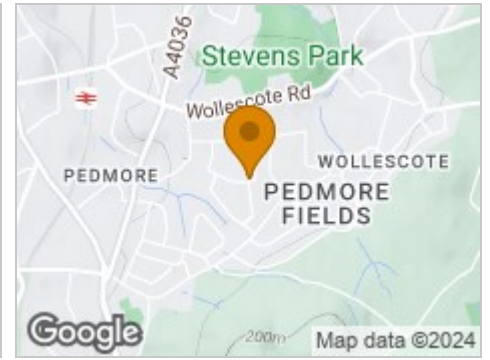

Floor Plan

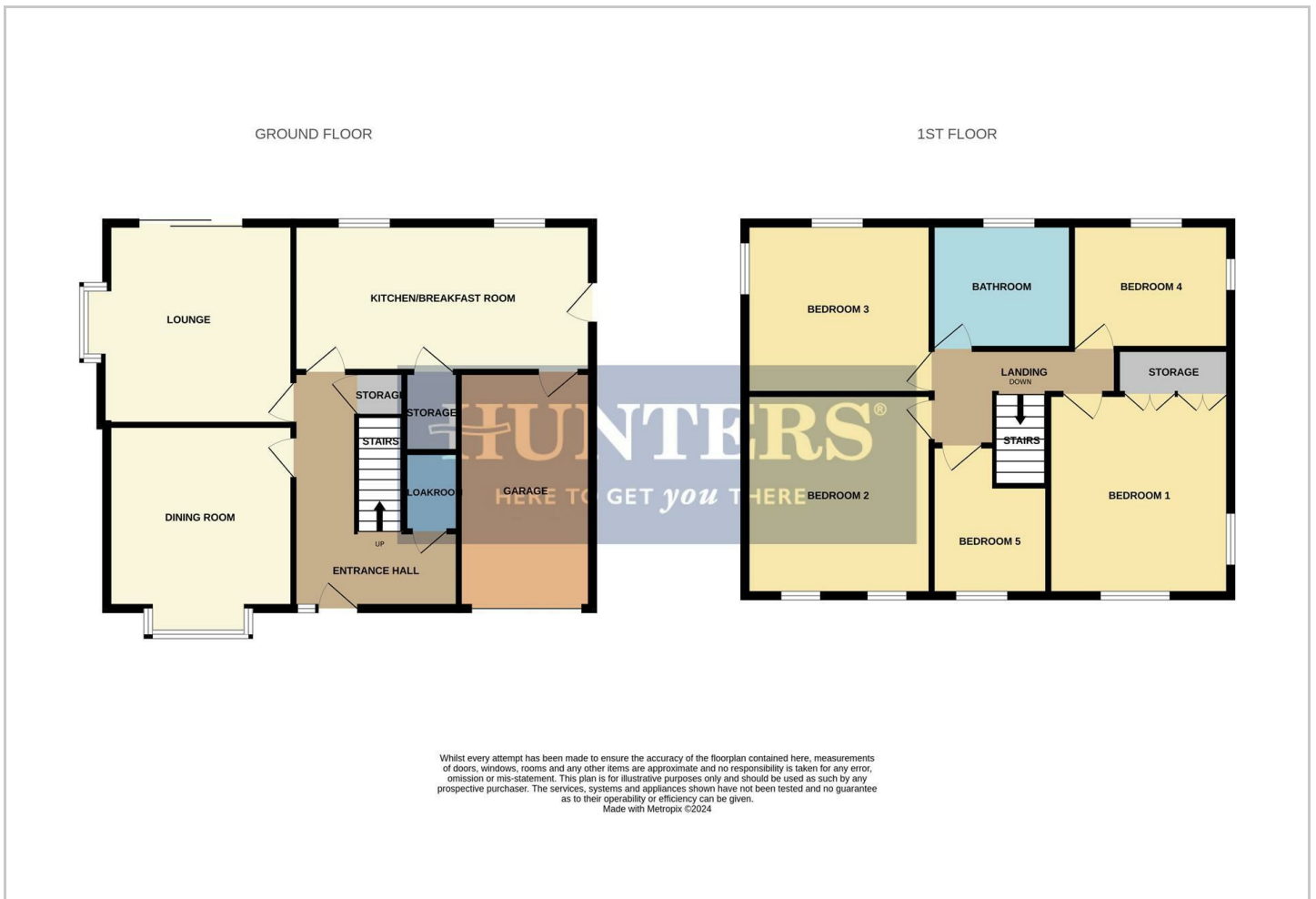

Viewing

Please contact our Hunters Stourbridge Office on 01384 443331 if you wish to arrange a viewing appointment for this property or require further information.

Energy Efficiency Graph

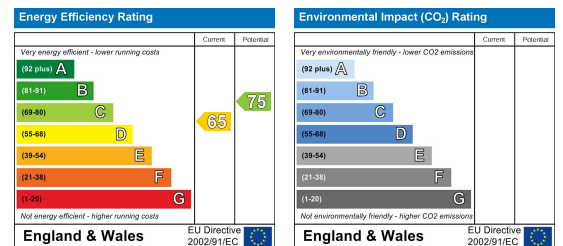

These particulars are intended to give a fair and reliable description of the property but no responsibility for any inaccuracy or error can be accepted and do not constitute an offer or contract. We have not tested any services or appliances (including central heating if fitted) referred to in these particulars and the purchasers are advised to satisfy themselves as to the working order and condition. If a property is unoccupied at any time there may be reconnection charges for any switched off/disconnected or drained services or appliances - All measurements are approximate. **THINKING OF SELLING?** If you are thinking of selling your home or just curious to discover the value of your property, Hunters would be pleased to provide free, no obligation sales and marketing advice. Even if your home is outside the area covered by our local offices we can arrange a Market Appraisal through our national network of Hunters estate agents.