

# HUNTERS<sup>®</sup>

HERE TO GET *you* THERE



Corbett Road  
Brierley Hill, DY5 2TQ

 3  2  1  D

Council Tax: A



# Corbett Road

Brierley Hill, DY5 2TQ

£220,000



## Front Of The Property

To the front of the property there is a chipping stone driveway with gated side access.

## Entrance Hall

With a double glazed door leading from the front, doors to various rooms, stairs to the first floor landing, recessed spotlights and a further door to an under stairs utility area with double glazed window to front and boiler.

## Cloakroom

With a door leading from the entrance hall, WC, wash hand basin, double glazed window to rear and a central heating radiator.

## Kitchen Family Room

20'1" x 22'2" (6.13 x 6.76)

With a door leading from the entrance hall, fitted with range of wall and base units, work surfaces with tiled splash back, gas hob, electric oven, extractor hood, one and a half stainless steel sink and drainer, skylight window, door to bedroom three, double glazed window to rear, double glazed patio doors to rear and recessed spotlights.

## Bedroom Three

7'10" x 12'5" (2.39 x 3.79)

With a door leading from the kitchen family room, double glazed window to side, door to en suite and a central heating radiator.

## En Suite

With a door leading from bedroom three, double glazed window to front, tiled walls, shower cubicle, WC, wash hand basin set into vanity unit and extractor fan.

## Landing

With stairs leading from the entrance hall, double glazed window to front, doors to various rooms, storage cupboard, loft access and a central heating radiator.

## Bedroom One

12'1" x 12'4" (3.69 x 3.77)

With a door leading from the landing, double glazed window to rear and a central heating radiator.

## Bedroom Two

9'6" x 11'2" (2.9 x 3.4)

With a door leading from the landing, double glazed window to rear and a central heating radiator.

## Bathroom

With a door leading from the landing, double glazed window to front, tiled walls, bath with shower over, shower cubicle, WC, wash hand basin set into vanity unit and a central heating radiator.

## Garden

With double glazed patio doors from the kitchen family room to a patio with chipping stone borders and lawn beyond.



## Road Map

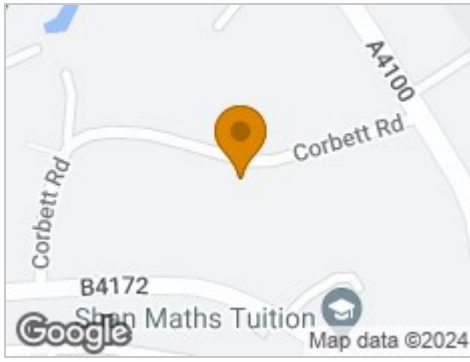

## Hybrid Map



## Terrain Map

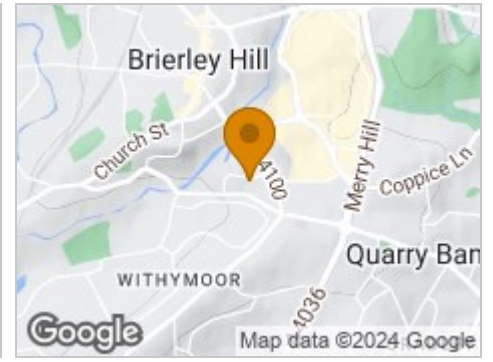

## Floor Plan

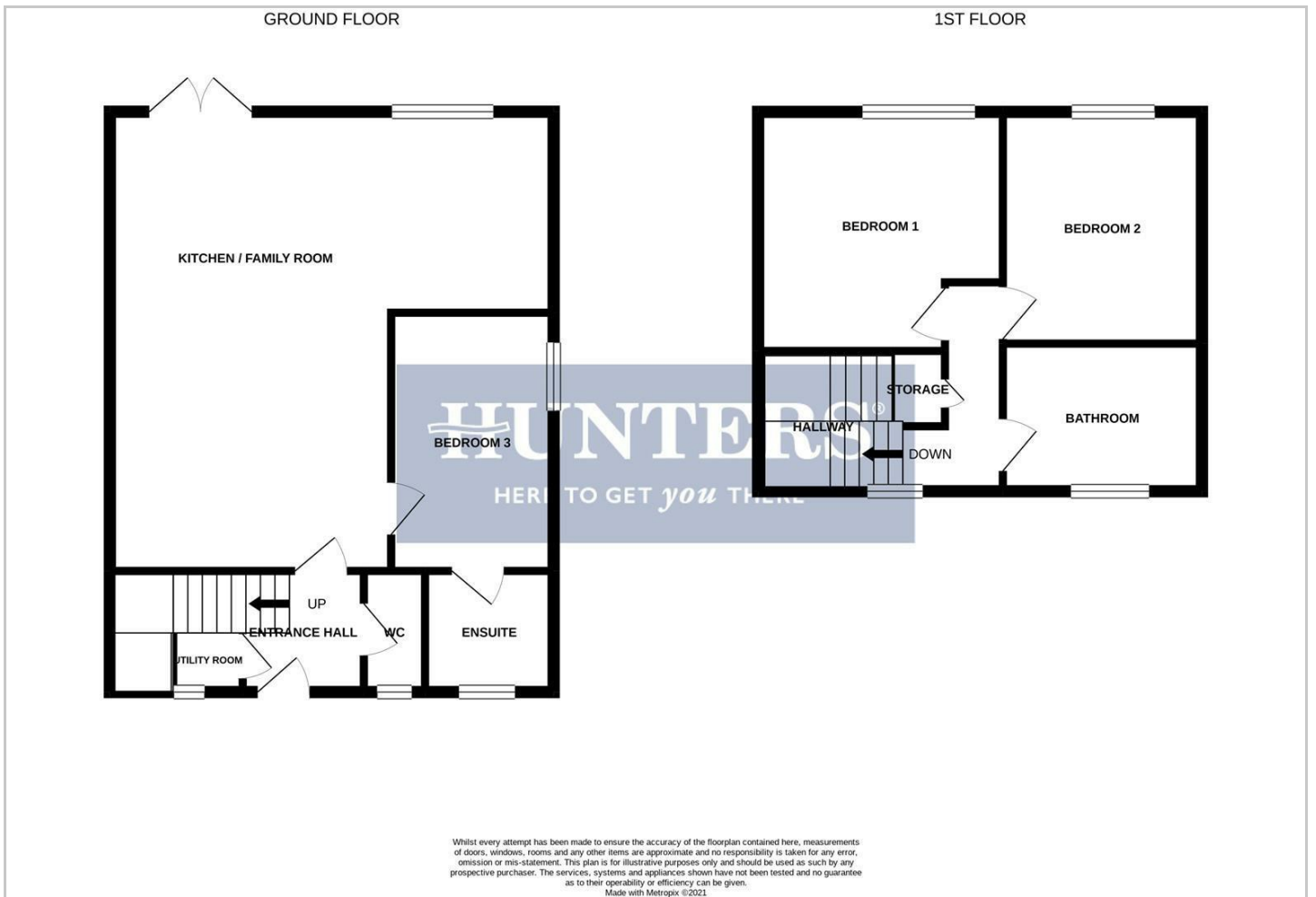

Please contact our Hunters Stourbridge Office on 01384 443331 if you wish to arrange a viewing appointment for this property or require further information.

## Energy Efficiency Graph

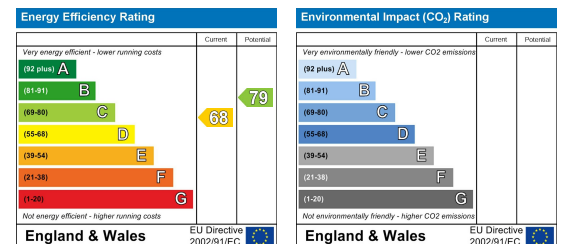

These particulars are intended to give a fair and reliable description of the property but no responsibility for any inaccuracy or error can be accepted and do not constitute an offer or contract. We have not tested any services or appliances (including central heating if fitted) referred to in these particulars and the purchasers are advised to satisfy themselves as to the working order and condition. If a property is unoccupied at any time there may be reconnection charges for any switched off/disconnected or drained services or appliances - All measurements are approximate. **THINKING OF SELLING?** If you are thinking of selling your home or just curious to discover the value of your property, Hunters would be pleased to provide free, no obligation sales and marketing advice. Even if your home is outside the area covered by our local offices we can arrange a Market Appraisal through our national network of Hunters estate agents.