



Tel: 01698322555

7A Church Street, Uddingston, Glasgow, G71
7PT

info@premierpropertiesweb.com

GLENFRUIN ROAD, BLANTYRE

OFFERS OVER £70,000

- Popular location
- Ideal for first time and investment buyers
- Ground floor flat
- Dual aspect bright and spacious lounge
- Fitted kitchen
- Two double bedrooms
- Fitted bathroom with white suite
- Ample storage space
- DG & GCH
- Unrestricted on road parking





This extremely spacious flat which enjoys the preferred ground floor position within a quiet pocket of Blantyre would be a tremendous first time buyers, professional couples, landlords or investment purchase.

Accommodation:

Access to the property opens to a large hallway with two storage cupboards and doors leading to a dual aspect bright and spacious lounge which has a door leading to a fitted kitchen with a range of wall and base cupboards, work tops and a wall mounted gas boiler. From the hallway there are further doors leading to two double bedrooms, the main bedroom comes with built in wardrobes.

Other features in include double glazing and gas central heating along with on unrestricted on road parking to the front.





Amenities:

The town of Blantyre offers excellent shopping amenities and retail parks within Blantyre itself as do the nearby towns of Hamilton and East Kilbride. Blantyre provides a library, sports centre with gym and swimming pool. The property is also located within popular school catchments. The area has several parks, picturesque walks, pubs, bistros and restaurants. There are regular bus and train links to the surrounding towns and cities including Glasgow. For those commuting by car, Blantyre Farm Road is located nearby which provides easy striking distance to the M74, M73 and M8 motorways connecting to Glasgow, Edinburgh and the surrounding towns.



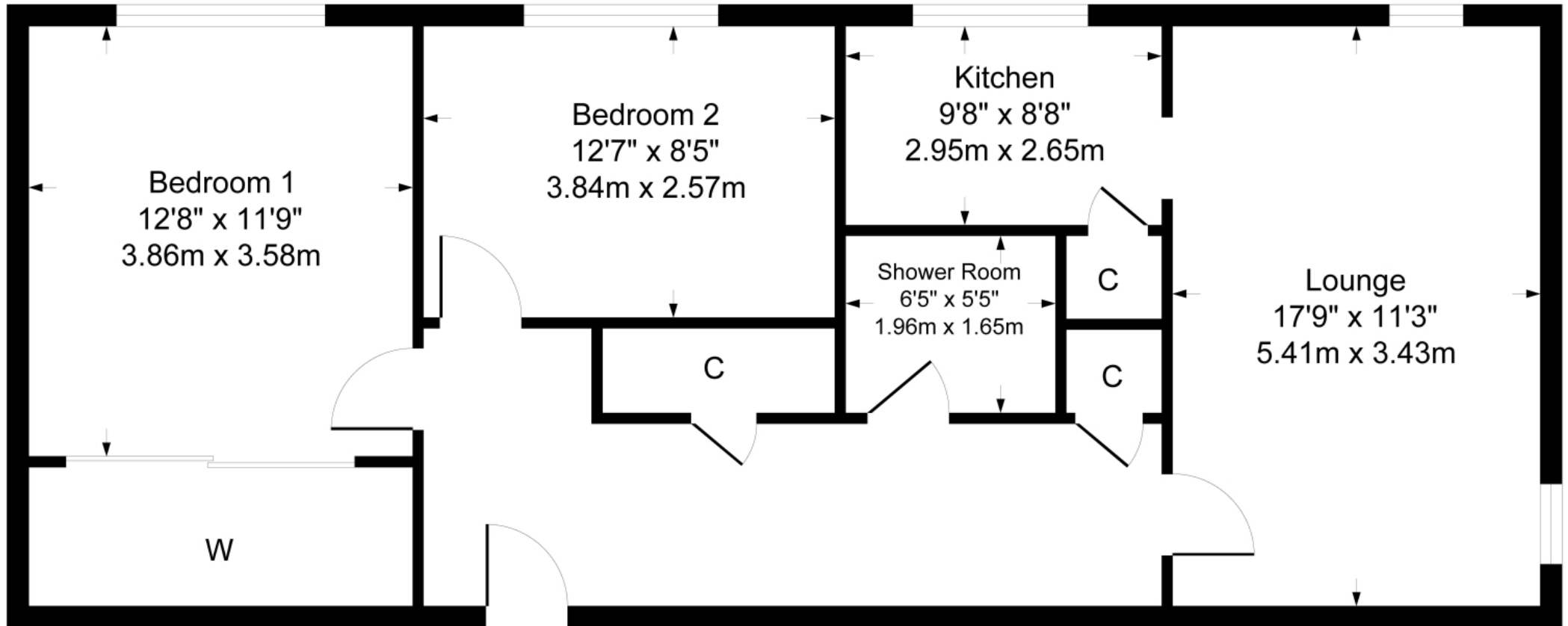

Although every attempt has been made to ensure accuracy, all measurements are approximate.
This floorplan is for illustrative purposes only and not to scale.
Measured in accordance with RICS Standards.

