



Tel: 01698322555

7A Church Street, Uddingston, Glasgow, G71  
7PT

[info@premierpropertiesweb.com](mailto:info@premierpropertiesweb.com)

**BURTE COURT, BELLSHILL**

**OFFERS OVER £115,000**

- Great location
- Ideal for first time buyers
- Bright and spacious lounge diner
- Modern fitted kitchen
- Fitted white suite in bathroom
- Two double bedrooms with built in wardrobes
- En-suite shower room
- GCH & DG
- Allocated parking bay





Presented in excellent order throughout is this immaculate top floor apartment which is set in the convenient Oval estate of Bellshill.

Being in walk in condition throughout this tremendous property presents itself as the perfect first time buyer opportunity therefore early viewing is strongly advised.

**Accommodation:**

The accommodation comprises of a spacious lounge with ample dining space, kitchen with white goods, family bathroom with three piece suite, two double bedrooms with fitted mirrored wardrobes and a master en-suite shower room.

Further benefits are gas c.h., double glazing, secure entry system and private parking.





## Amenities:

The town of Bellshill is held in high regard where its excellent Main Street provides an abundance of shops, cafes, pubs, restaurants and every day shopping needs. Further benefits within the area include gyms, swimming and sports complexes, a bowling club, a number of children's play areas, nature walks and the nearby Bellshill golf course. Bellshill also benefits from its very own Train Station which provides a regular service to both Glasgow and Edinburgh City Centres as well as connecting throughout the rest of the UK. The M8, M73 and recently extended M74 motorways are nearby which provide excellent access to nearby towns such as Hamilton, Motherwell, East Kilbride and around the central belt. Ample bus services are also available providing access to the surrounding towns within the Lanarkshire area as well as Glasgow city centre. The location is very attractive to families with popular schooling in the area.



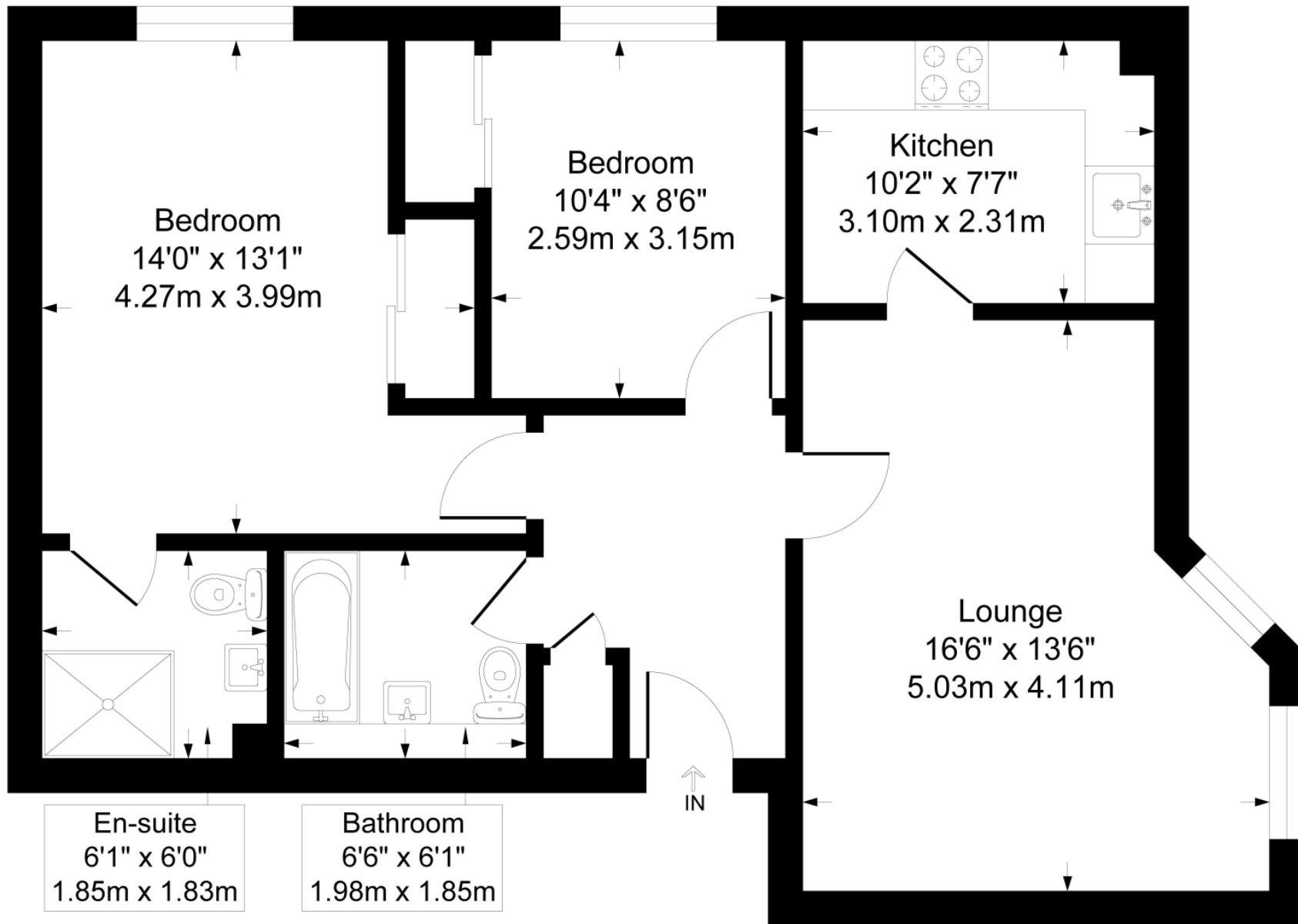

Although every attempt has been made to ensure accuracy, all measurements are approximate.  
This floorplan is for illustrative purposes only and not to scale.  
Measured in accordance with RICS Standards.

