



Tel: 01698322555

7A Church Street, Uddingston, Glasgow, G71
7PT

info@premierpropertiesweb.com

DALCROSS WAY, PLAINS

OFFERS OVER £154,950

Popular development
Semi detached
Spacious and bright lounge
Great sized kitchen diner
Downstairs WC
Three double bedrooms all with storage
White bathroom suite
GCH & DG
Vacant possession
Extensive driveway
Private garden





Nestled within the charming village of Plains, Airdrie, this delightful family abode offers an exceptional opportunity for a family seeking comfort, style, and convenience.

Accommodation:

The easily maintained and spacious accommodation consists of an entrance vestibule, WC, generously sized lounge, fantastic kitchen open plan to dining area, three well appointed bedrooms all with storage facilities and stylish bathroom.

All rooms are presented in bright decor and fixtures and fittings are to a good standard throughout. Heating is provided by gas fired central heating and double glazing has been installed.

To the front of the home is a good sized mono-block driveway providing off street parking and to the rear is a low maintenance garden. The rear garden is fully enclosed and private by substantial timber fencing to provide a child and pet friendly environment.





As this is a popular development and the house is presented in excellent order early viewings are recommended to avoid disappointment.

Amenities:

With views of Ben Lomond and Isle of Arran, Plains is an idyllic countryside setting., far enough away from the hustle and bustle of city life, but conveniently close enough to the towns of Airdrie and Drumgelloch.

And should you need to dip back into city life, the M8 motorway is a short drive away, allowing you easy access to both Glasgow and Edinburgh.

Lastly, with children's play areas and local schools only a short walk away, Plains really is the ideal place for you and your family.



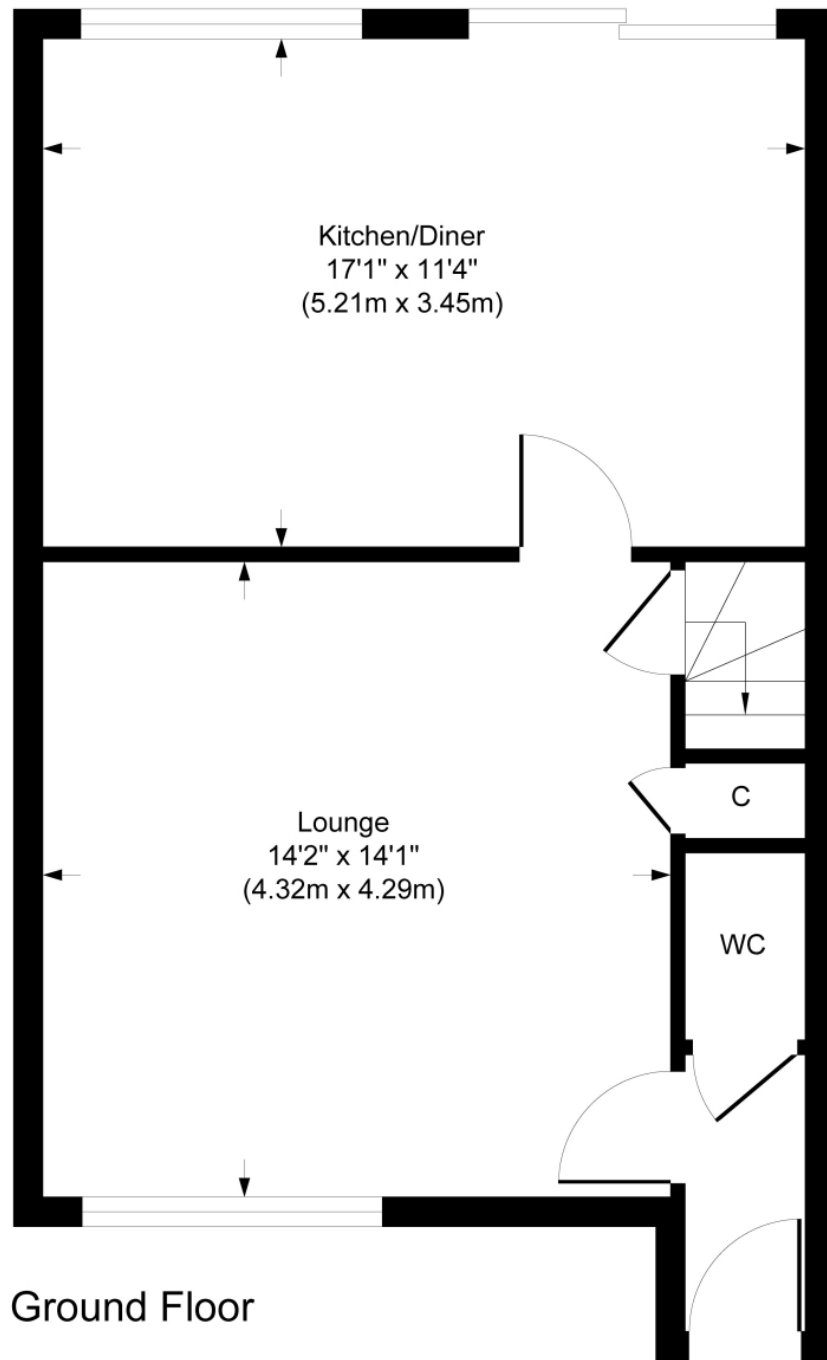

Ground Floor

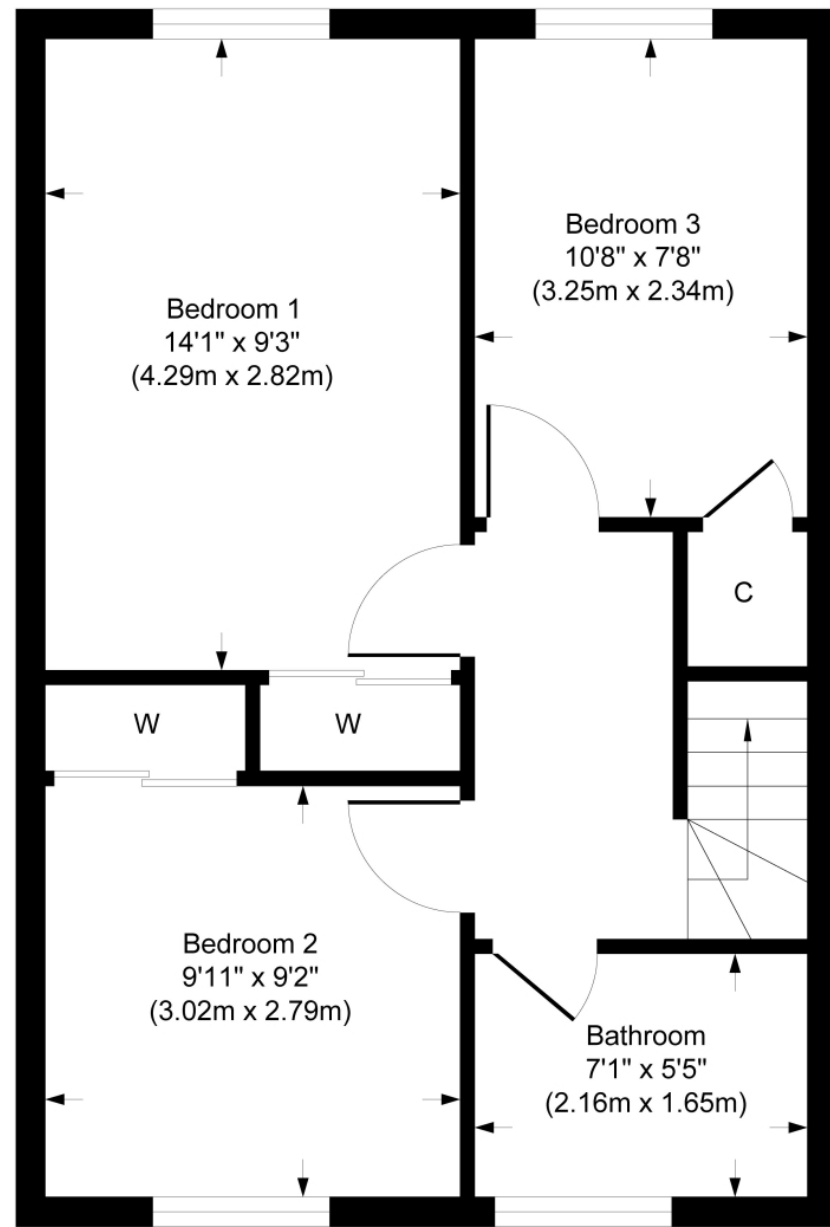

First Floor

Although every attempt has been made to ensure accuracy, all measurements are approximate.
 This floorplan is for illustrative purposes only and not to scale.
 Measured in accordance with RICS Standards.

