



Tel: 01698322555

7A Church Street, Uddingston, Glasgow, G71
7PT

info@premierpropertiesweb.com

CYPRESS ROAD, MOTHERWELL

OFFERS OVER £215,000

- Excellent Family Home
- Well presented
- Downstairs WC
- Bright and Spacious Lounge
- 16' 4" Kitchen/diner
- Three well appointed bedrooms
- Ensuite shower room
- Stunning Bathroom
- DG & GCH
- Ample storage space
- Private well kept gardens
- Extensive driveway





Presented to the market in excellent condition with is this three bedroom semi detached family home, well positioned within a modern and highly sought after development in Motherwell?

Accommodation:

To the ground floor there is a WC off of the entrance lobby, a bright and spacious lounge with an understairs cupboard, which leads to a fantastic sized kitchen/diner, upstairs there are three well appointed bedrooms, master bedroom provides an ensuite showerroom, and a stunning family bathroom. Other features are double glazing and gas central heating. Outside there is an extensive driveway to the front and side with a lawn and a well laid out rear garden ,mostly laid to lawn with a raised decked to the back of garden with space for garden furniture.

Premier Properties highly recommends early internal inspection to fully appreciate the standard of accommodation on offer and to avoid disappointment.





Amenities:

The sought after area of Motherwell boasts a wide and varied range of shops, bars, restaurants, banks and building societies. Local amenities include: Showcase Leisure Park, multiplex cinema, bowling alley, sports complex, bowling green, golf course, Chatelherault & Strathclyde Country Parks and Wishaw General Hospital. Motherwell offers primary and secondary educational facilities, access to Hamilton College and bus, rail and motorway links providing access in and around the Central Belt.



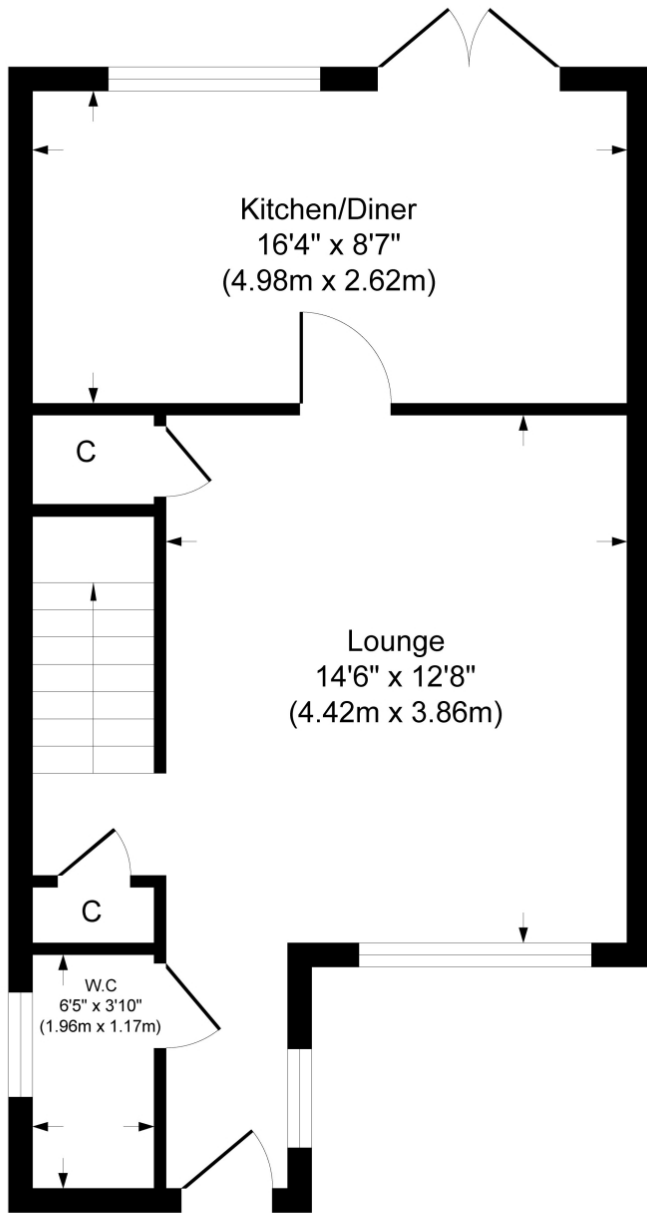

Ground Floor

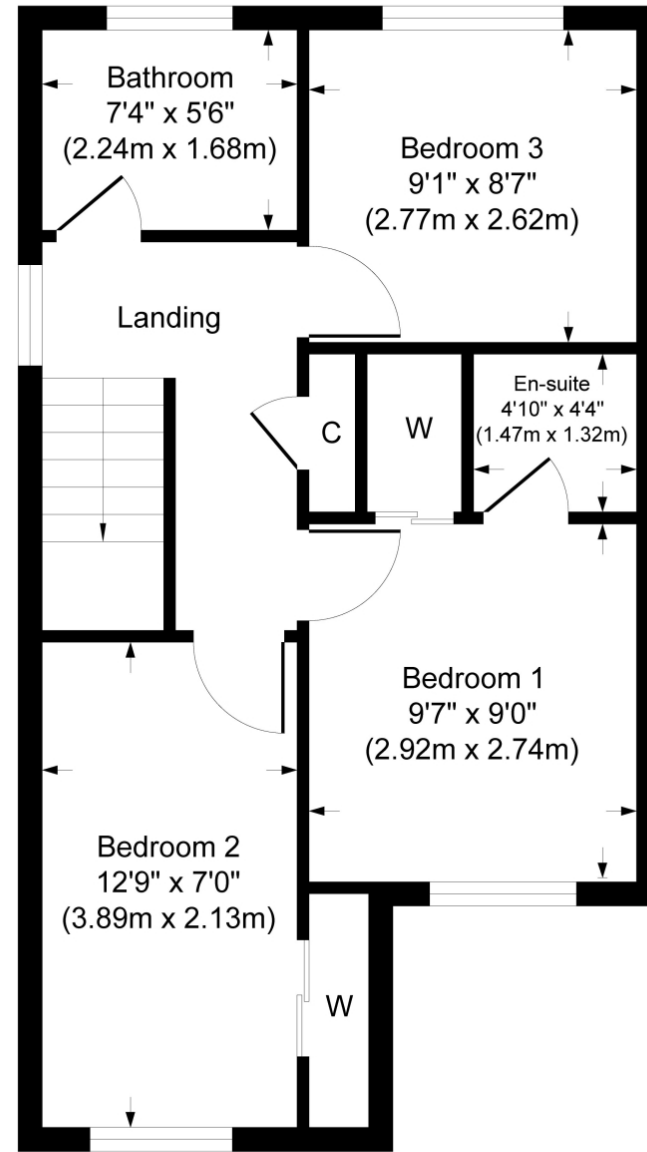

First Floor

Although every attempt has been made to ensure accuracy, all measurements are approximate.
 This floorplan is for illustrative purposes only and not to scale.
 Measured in accordance with RICS Standards. © Outline Photos.

