



18 Weaver Crescent, Tiverton, Devon EX16 5FG
£260,000

Welden 
Edwards
Supporting your every move

A wonderful three bedroom home located in the Rackenford Meadows Development. Benefiting from spacious accommodation, modern kitchen/diner, low maintenance rear garden and off road parking for two cars. Viewing is highly recommended.

Description

This 'Gosford' designed family home, built in 2015, offers spacious and beautifully presented accommodation in a prime location. Situated on a lovely plot with open views to the front and a private, Southerly facing rear garden, this property boasts a perfect balance of indoor and outdoor living spaces.

Upon entering through the front door, you are welcomed into an inviting entrance hall with a modern tiled floor, leading to the lounge that overlooks the picturesque open space to the front. The kitchen/dining room is a standout feature of the home, with double opening patio doors that lead to the South facing rear garden. The kitchen is well-appointed with modern wall and base units, classic worktops, and high-quality appliances, creating a functional and stylish space for cooking and entertaining.

The first floor landing provides access to all rooms, including the primary bedroom with built-in wardrobes and an en-suite shower room. The two rear-facing bedrooms are spacious and light-filled, sharing a family bathroom with a shower over the bath.

Outside, the property features two parking spaces to the front, with side access leading to the beautifully maintained rear garden. The sunny garden boasts a lush lawn, vibrant shrub borders, and a patio area, perfect for outdoor dining and relaxing.

Overall, this home is a perfect blend of modern design, practicality, and outdoor living, offering a comfortable and welcoming environment for family living and entertaining.

Services

Council tax band C.
All mains services connected.
Freehold

Tiverton

Tiverton is a market town in Mid Devon with a wide range of amenities, with a range of shops, recreational and educational facilities, as well as superb travel links to Exeter and Taunton via the North Devon link road, the M5 accessible from here via junction 27.

Sales enquiries

If you have any enquiries, please do not hesitate to contact the office on 01884 257997 or email us at sales@weldenedwards.co.uk.

Disclaimer

Whilst every attempt has been made to ensure our sales particulars are accurate and reliable, they are only a general guide to the property, and accordingly, if there is any point which is of particular importance to you, please contact the office and we will be pleased to clarify the position for you.

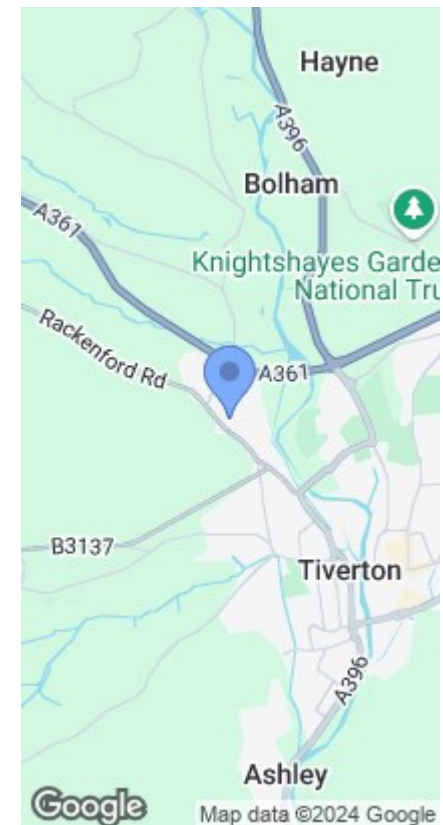
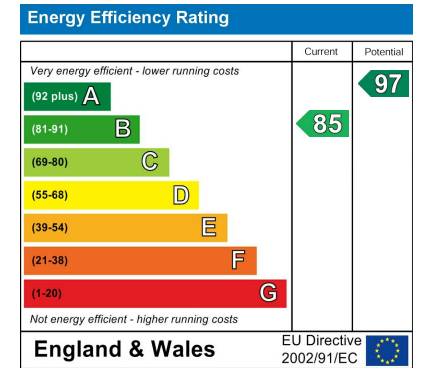

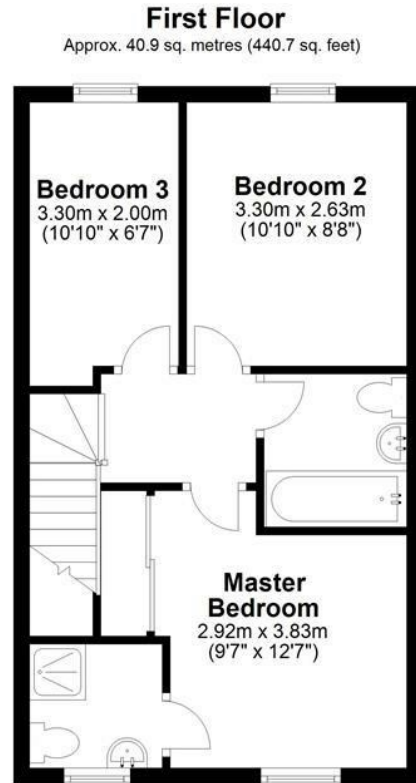
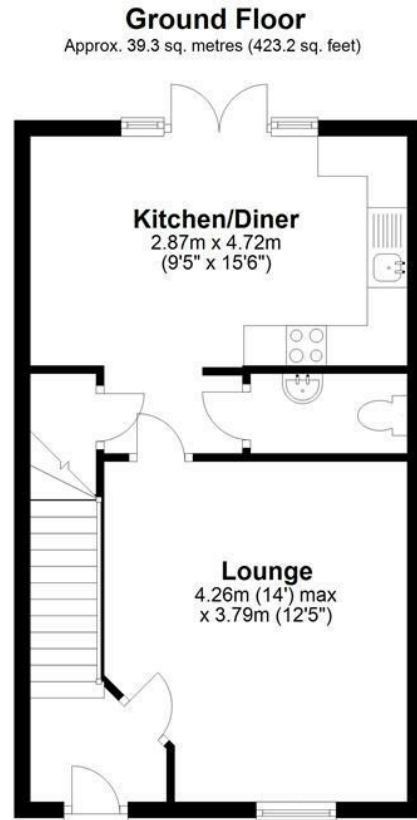

Total area: approx. 80.3 sq. metres (863.9 sq. feet)

This plan is for guidance only and is not to be relied upon. Measurements are approximate.
Plan produced using PlanUp.



