



Salisburys

Yelverton, PL20.

Offers In Region Of £385,000

🛏 2 🚿 3 🛋 1



- Stylish Contemporary Terraced House
- Spacious open plan living
- Downstairs cloakroom
- Walking distance to local amenities
- Allocated parking
- Immaculately presented throughout
- Two bedrooms with Master ensuite
- Enclosed front garden
- Far reaching views of the Walkham Valley
- Offered with NO CHAIN



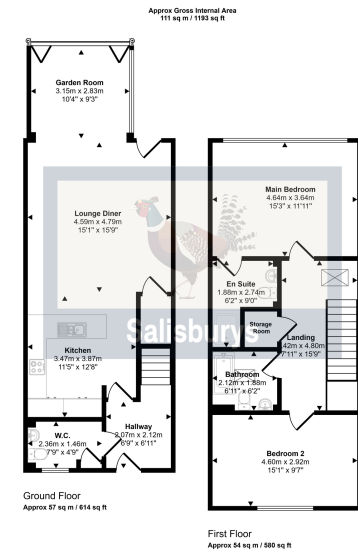

Ideally located in the sought-after village of Yelverton, this contemporary terraced house enjoys easy access to Plymouth city centre, the market town of Tavistock, the wider delights of Dartmoor and beyond. Perfectly positioned within a small, well-maintained development of houses built in 2014, the property offers modern living in a great location. Comprising of two large double bedrooms, the Master with Ensuite and large picture window to enjoy the views, Lounge with Garden Room, luxury fitted Kitchen, Family Bathroom and downstairs cloakroom. The property benefits from expansive views across the Walkham Valley, an enclosed rear garden, as well as the convenience of allocated off-road parking. Within easy, walking distance to the local amenities of both Yelverton's Leg'O'Mutton and Moorland Villas collection of shops and cafes and local transport routes. Offered with NO CHAIN.

Score	Energy rating	Current	Potential
92+	A		
81-91	B		85 B
69-80	C	75 C	
55-68	D		
39-54	E		
21-38	F		
1-20	G		

