



Salisburys

Meavy, Yelverton, PL20.

Offers In Region Of £465,000

🛏 4 🚿 2 🛋 1



- 4 Bedroom Semi-Detached Family Home
- Stunning countryside views
- Adaptable living for fourth bedroom option
- Walking distance to local amenities
- Garage with driveway
- Kitchen and separate utility
- Master en-suite bathroom
- Double glazed windows
- Central heating throughout
- Edge of village location



A well presented four bedroom house with a spacious lounge, kitchen, separate utility room and downstairs bathroom. Also offering the flexibility of the option of a fourth downstairs bedroom, currently used as a dining room. Upstairs the master bedroom benefits from a spacious en-suite bathroom, two additional bedrooms and family bathroom. Externally the property has an enclosed front garden with a lawned and patio area including a wooden framed greenhouse. The garage is accessed to the rear of the property via a well maintained, shared access driveway. There is an additional lawned area and pathway leading to the rear entrance via a small external porchway. Set within the moorland village of Meavy, the property benefits from tranquil, countryside views, local school and popular pub 'The Royal Oak', offering a perfect place to escape to the country still within striking commutable distance of Tavistock and Plymouth. Viewings by appointment only.

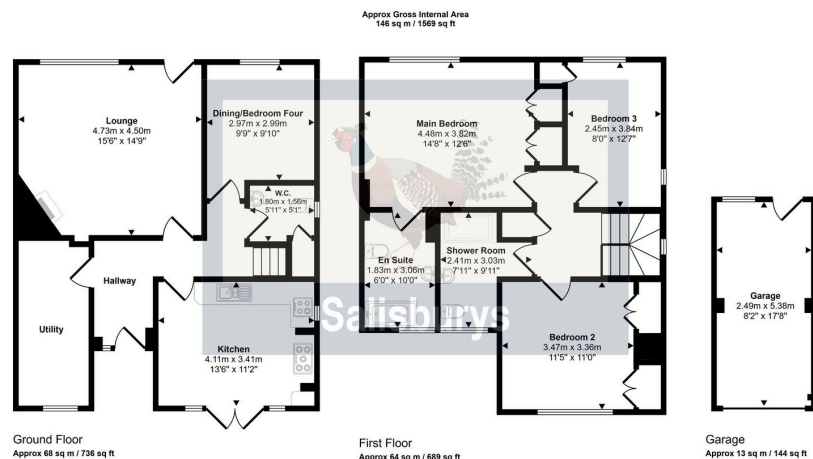

This floorplan is only for illustrative purposes and is not to scale. Measurements of rooms, doors, windows, and any items are approximate and no responsibility is taken for any error, omission or mis-statement. Icons of items such as bathroom suites are representations only and may not look like the real items. Made with Made Snappy 360.

Score	Energy rating	Current	Potential
92+	A		
81-91	B		
69-80	C		69 C
55-68	D	68 D	
39-54	E		
21-38	F		
1-20	G		

