

Westella Road, Yelverton.

Offers Over £650,000

3 2 1





- Exceptional 3 bedroom detached bungalow
- Stunning vaulted Kitchen/Dining Room overlooking Garden
- Three double bedrooms (two with access to Sun Terrace)
- Family Bathroom with Bath and separate Shower
- Beautifully presented
- Level gardens to front and rear with lawn, flower beds and patio area
- Lounge with patio doors overlooking Garden
- Master with en-suite Shower Room
- Single detached garage with parking for multiple vehicles
- Highly desirable Yelverton location

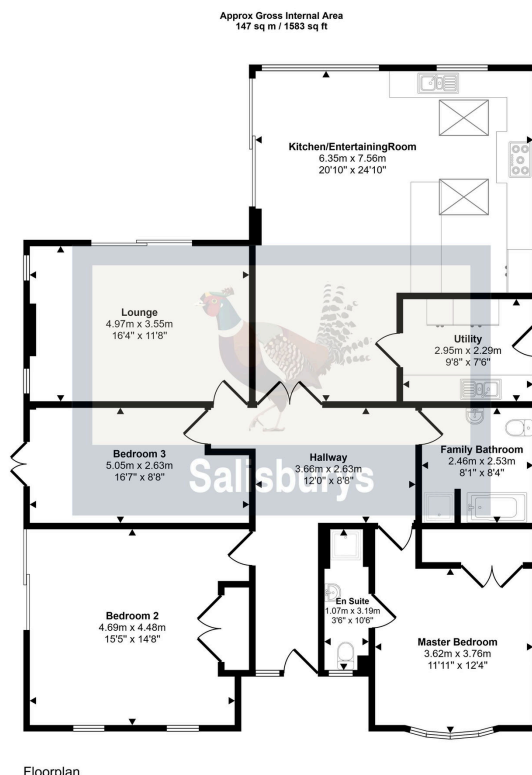

This floorplan is only for illustrative purposes and is not to scale. Measurements of rooms, doors, windows, and any items are approximate and no responsibility is taken for any error, omission or mis-statement. Icons of items such as bathroom suites are representations only and may not look like the real items. Made with Made Snappy 360.

An exceptional opportunity to purchase a deceptively spacious three bedroom detached bungalow in an aspirational position in Yelverton. The property is situated in a good sized level plot with an enclosed rear garden with Tool shed, large gravelled frontage with parking for numerous vehicles and a detached garage (currently arranged with a Gardener's w.c/storage area). Internally, the bungalow has a superb vaulted Kitchen/Dining Room overlooking the rear gardens with floor to ceiling windows and patio doors to the Sun Terrace which can also be accessed via the Lounge. The bungalow offers two large double bedrooms (one with a well



appointed en-suite) and a further double bedroom, two of which have access to the wrap around Sun Terrace, a Family Bathroom with bath and separate shower cubicle and a separate Utility Room. In summary; a stunning property in a prime location!