



Salisburys



# Oakwood, Westella Road

Offers Over £650,000

3 2 1



- Highly desirable Yelverton location
- Master with en-suite Shower Room
- Level gardens to front and rear with lawn, flower beds and patio area
- Family Bathroom with Bath and separate Shower
- Stunning vaulted Kitchen/ Dining Room overlooking Garden
- Single detached garage with parking for multiple vehicles
- Lounge with patio doors overlooking Garden
- Beautifully presented
- Three double bedrooms (two with access to patio)
- Exceptional 3 bedroom detached bungalow







An exceptional opportunity to purchase a deceptively spacious three bedroom detached bungalow in an aspirational position in Yelverton. The property is situated in a good sized level plot with an enclosed rear garden with Tool shed, large gravelled frontage with parking for numerous vehicles and a detached garage (currently arranged with a Gardener's w.c/storage area). Internally, the bungalow has a superb vaulted Kitchen/Dining Room overlooking the rear gardens with floor to ceiling windows and patio doors to the Sun Terrace which can also be accessed via the Lounge. The bungalow offers two large double bedrooms (one with a well appointed en-suite) and a further double bedroom, two of which have access to the wrap around Sun Terrace, a Family Bathroom with bath and separate shower cubicle and a separate Utility Room. In summary; a stunning property in a prime location!

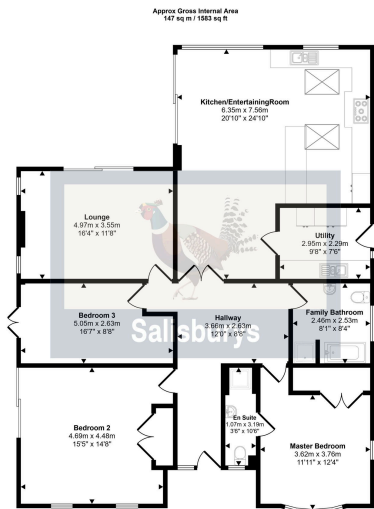

Floorplan

This floorplan is only for illustrative purposes and is not to scale. Measurements of rooms, doors, windows, and any other items are approximate and no responsibility is taken for any error, omission or misstatement. Some of the items such as the bedroom names are representations only and may not look like the real items. Made with Magic Drawings 360.

Score	Energy rating	Current	Potential
92+	A		
81-91	B		
69-80	C		77 C
55-68	D	64 D	
39-54	E		
21-38	F		
1-20	G		

