



Salisburys



## Trelawny Road, PL19.

Offers In Region Of £225,000

🛏 2 🚿 1 🛋 2



- Character cottage
- Two double bedrooms
- Light and airy
- Front and rear gardens
- Far reaching views
- Walking distance to Tavistock centre
- Log burner
- Garden room and patio
- Storage shed
- NO CHAIN







Offered chain free - this attractive two bedroom terraced house, with garden and external storage is within walking distance to Tavistock town centre. This charming terrace house offers period features, far reaching views and a well established garden. Inside, the property is entered via a practical porchway into the cosy lounge with a log burner and large window looking out to the front garden. This leads onto a second reception room currently used as an office/library offering handy under the stair storage. The well equipped kitchen features cream shaker style cabinets and wood effect work surfaces with plenty of storage. The family bathroom includes a bath and shower. To the rear there is a multi-purpose garden room that leads to the patio. Upstairs, there are two double bedrooms including fitted wardrobes in the master. Externally this home benefits from a front garden and a rear garden set back slightly from the house including a handy storage shed.

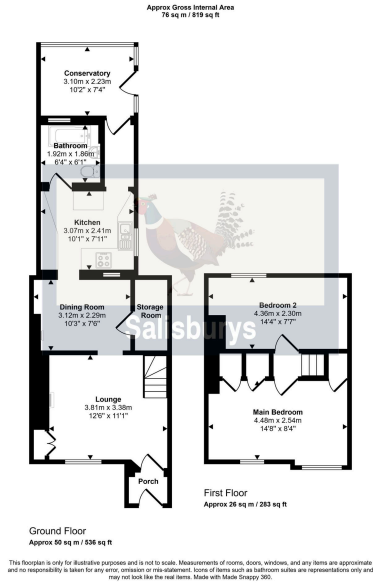

Score	Energy rating	Current	Potential
92+	A		
81-91	B		81 B
69-80	C		
55-68	D	57 D	
39-54	E		
21-38	F		
1-20	G		

