



Salisburys



Trelawny Road, PL19.

£240,000

🛏 2 🚿 1 🛋 2





- Character cottage
- Two double bedrooms
- Light and airy
- Front and rear gardens
- Far reaching views
- Walking distance to Tavistock centre
- Log burner
- Garden room and patio
- Storage shed
- NO CHAIN





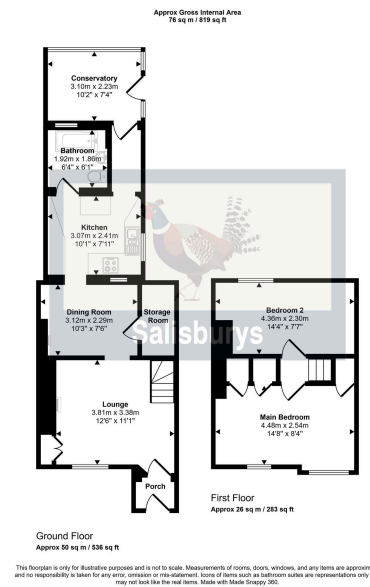

No Chain - two double bedroom terrace house, with garden and external storage within striking walking distance to Tavistock town centre. This charming terrace house offers period features, far reaching views and a well established garden. Inside, the property is entered via a practical porchway into the cosy lounge with a log burner and large window looking out to the front garden. Leading onto a second reception room currently used as an office/library offering handy under the stair storage. The well equipped kitchen features cream shaker style cabinets and wood effect work surfaces with plenty of storage. The family bathroom includes a bath and shower. To the rear of the property, there is a garden room currently being used as a dining room that leads out to the patio. Upstairs, there are two double bedrooms including fitted wardrobes in the master. Externally this home benefits from a front and rear garden set

