



Salisbury's



# The Glade, Crapstone, Yelverton, PL20 7PR

Offers Over £545,000

🛏 3 🚿 1 🛋 2



- CHAIN FREE
- Well presented
- Driveway parking
- Garage/Utility Room
- Fully fitted kitchen
- Two Reception rooms
- Three double bedrooms
- Large lawned garden
- Highly desirable "The Glades" location
- Detached 3 bedroom bungalow







**PREMIUM LOCATION!** This delightful 3 bedroom detached bungalow with a large garden is situated in the highly sought-after no through road of The Glade in Crapstone. The property offers spacious accommodation in a desirable location that is within easy reach of local amenities and a short distance from Yelverton with a wide range of shops and local transport routes. Its prime position ensures minimal traffic making it an ideal retreat for those seeking both convenience and a quiet location. Just a few minutes' walk from the property, you'll find open moorland, offering an idyllic setting for scenic walks, leisurely or simply taking the dogs for a run, this beautiful natural space provides the perfect backdrop. The property offers adaptable accommodation, providing flexibility to suit your needs.

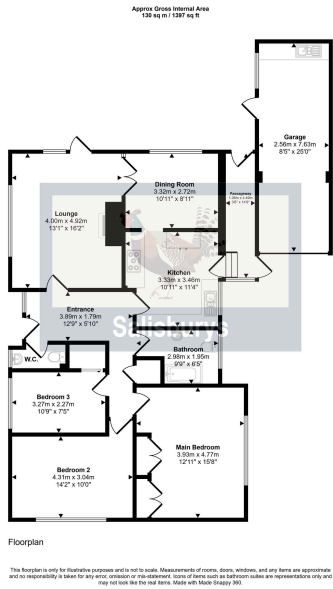

Score	Energy rating	Current	Potential
92+	A		
81-91	B		81 B
69-80	C		
55-68	D	65 D	
39-54	E		
21-38	F		
1-20	G		

