



Salisburys

Lower Dimson, Gunnislake, PL18 9NP

Guide Price £350,000

🛏 2 🚿 1 🚗 1



- Quintessential character property
- 2 large bedrooms
- Good size kitchen
- Character features with fireplaces in both bedrooms
- Beautiful low maintenance garden with seating areas
- Far reaching views of the Tamar Valley
- Mains gas, electric and water
- Lounge with log burner
- Stone outbuildings
- Off-road parking



Beautifully restored Grade II listed detached Cornish cottage, perched in an elevated position with breathtaking panoramic views over the Tamar Valley. Renovated by the current owners, this characterful two-bedroom home blends historic charm with modern comfort, offering accommodation brimming with period features. The carefully landscaped front garden is a true highlight, featuring well-established shrubs and plants perfect for enjoying the far-reaching countryside views. Stepping inside, the home boasts flagstone flooring in the entrance hall, a stunning feature fireplace with a 7kW log burner, traditional sash windows, and deep-set window seats, all adding to its undeniable charm. Externally, the property benefits from various stone-built outbuildings, including a utility room, wood store, and tool shed, providing excellent additional storage. Off-street parking completes this fantastic offering. This quintessential Cornish retreat is a rare find!

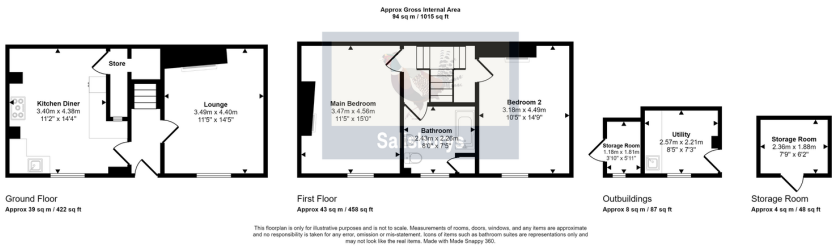

Score	Energy rating	Current	Potential
92+	A		
81-91	B		86 B
69-80	C		
55-68	D	56 D	
39-54	E		
21-38	F		
1-20	G		

