



Bannawell Street, Tavistock, PL19 0DJ

Offers In Region Of £275,000

🛏️ 2 🚿 1 🚗 1





- Character 2 bed semi detached property
- Deceptively spacious
- Extremely well presented
- Spacious downstairs accommodation
- Stunning Garden Room
- Tiered garden
- One bedroom Summer House/Lodge
- Useful attic storage
- Short walk to Tavistock
- CHAIN FREE

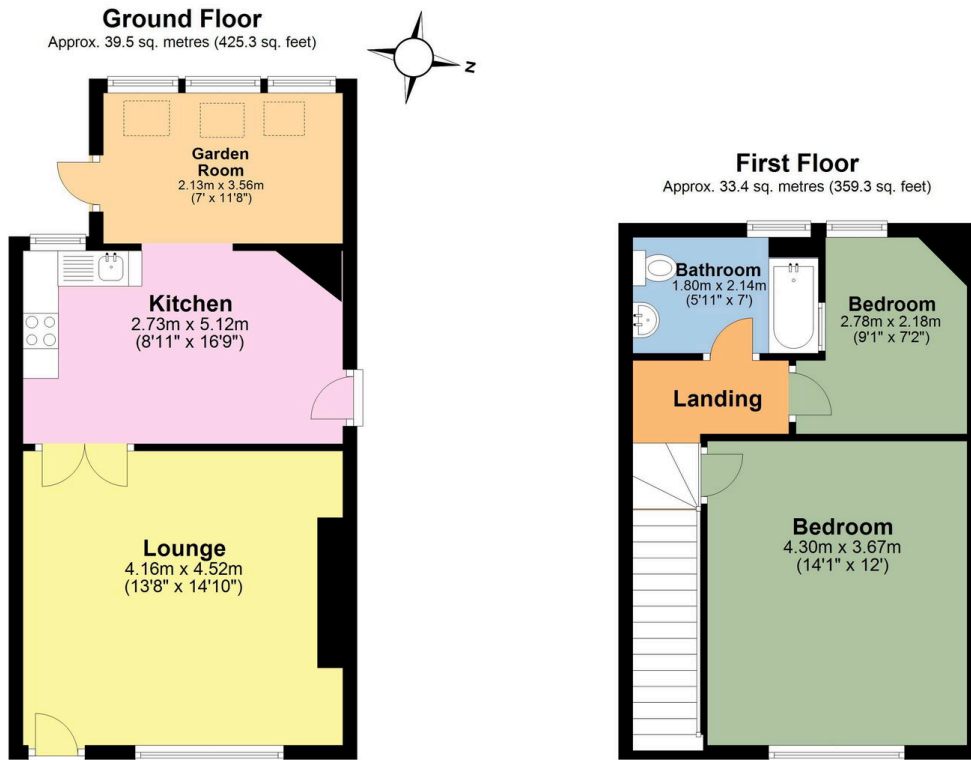

Total area: approx. 72.9 sq. metres (784.7 sq. feet)

These are appropriate dimensions.
Plan produced using PlanUp.

This attractive semi-detached property must be viewed to appreciate what is on offer! This wonderful home has spacious and stylish accommodation that briefly comprises of:- Lounge with feature fireplace and living flame log burner, contemporary kitchen, stunning Garden Room, two bedrooms, Family bathroom and additional attic storage. Externally the property offers a tiered garden with seating areas and views and a Summer House/Lodge that is fitted out with



bathroom, bedroom and kitchen. All of this is situated within a short walk to the centre of Tavistock. So much more that you would expect and is offered to the market CHAIN FREE!