



Salisburys

Trefinnick Road, Bray Shop, PL17 8QD

Offers In Region Of £345,000

🛏️ 3 🚗 1 🚗 1



- Detached bungalow
- 3 bedrooms
- Through lounge/dining room
- Utility Room
- Single garage + driveway parking + inspection pit
- Very large rear garden
- Family Bathroom
- Garden Room
- Two summerhouses, greenhouses and shed
- Countryside location



This delightful 3 bedroom bungalow is situated on a quiet country lane in a desirable location on the outskirts of Bray Shop and offers a wonderful large rear garden. The accommodation briefly comprises of 3 bedrooms, a through Lounge/Dining room, Family Bathroom, Kitchen, Utility Room and a Garden Room that overlooks the patio and garden. The large gardens are divided into a landscaped rockery and patio close to the house, a lawned area with mature shrub borders and a further garden area with a Summerhouse/Office. The property also offers a garage with an inspection pit, parking for several vehicles and lawned front garden with mature trees and shrubs. A great location!

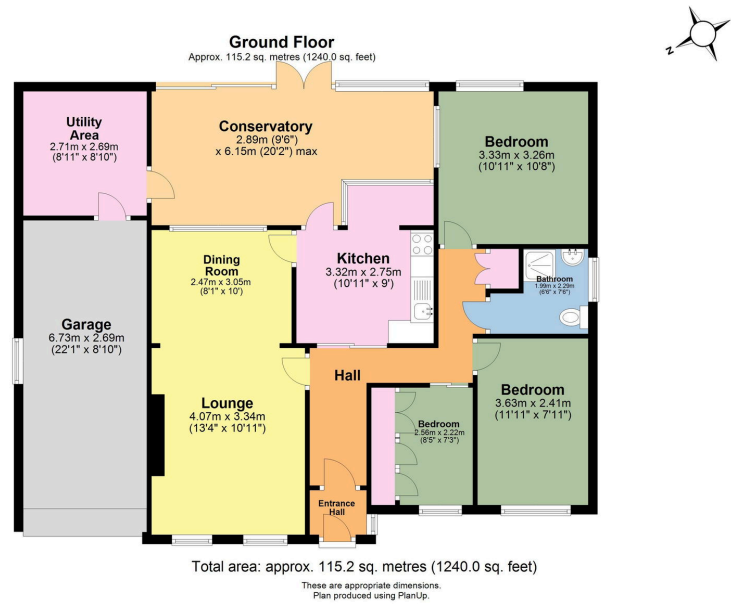

Score	Energy rating	Current	Potential
92+	A		
81-91	B		
69-80	C		78 C
55-68	D		
39-54	E		
21-38	F	27 F	
1-20	G		

