

## Harrowbeer Mews, Yelverton, PL20 6WE

Guide Price £200,000

🛏️ 2 🚿 1 🚗 1



- Stunning panoramic moorland views
- Two double bedrooms
- Luxury Villeroy & Boch bathroom
- Integrated fridge/freezer, dishwasher, double oven, extractor
- Dedicated parking space
- Ideal location for walks and commuting into Plymouth
- 990 years remaining on lease
- Secure Intercom communal entrance
- Close to shops, restaurants and cafes
- Extra visitor parking space

FIRST FLOOR  
718 sq.ft. (66.7 sq.m.) approx.

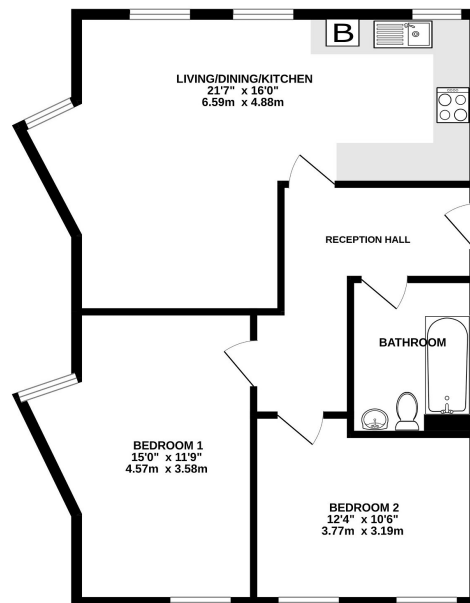

TOTAL FLOOR AREA: 718 sq ft. (66.7 sq.m.) approx.  
Whilst every effort has been made to ensure the accuracy of the floorplan contained herein, measurements of doors, windows, rooms and any other items are approximate and no responsibility is taken for any error, omission or misstatement. The plan for illustrative purposes only and should be used as such by any prospective purchaser. The technical systems and appliances shown have not been tested and no guarantee as to their operability or efficiency can be given.  
 Made with Intergen ©2023



Part of a 2014 development of the former Leg'o'Mutton Inn, this first floor flat offers a moorland location within walking distance of restaurants and shops. A dedicated parking space, security intercom, gas central heating, luxury fitted kitchen, two double bedrooms and a superb bathroom with underfloor heating - all are included. Stunning views to the rear over Dartmoor. OFFERED WITH NO ONWARD CHAIN.