

Harrowbeer Mews, Yelverton, PL20 6WE

Guide Price £200,000

🛏️ 2 🚿 1 🚗 1



- Stunning moorland views
- Two double bedrooms
- Luxury Villeroy & Boch bathroom
- Secure Intercom communal entrance
- Ideal location for walks and commuting into Plymouth
- Dedicated parking space
- Integrated fridge/freezer, dishwasher, double oven, extractor
- 990 years remaining on lease
- Close to shops, restaurants and pub
- Extra visitor parking

FIRST FLOOR
718 sq.ft. (66.7 sq.m.) approx.

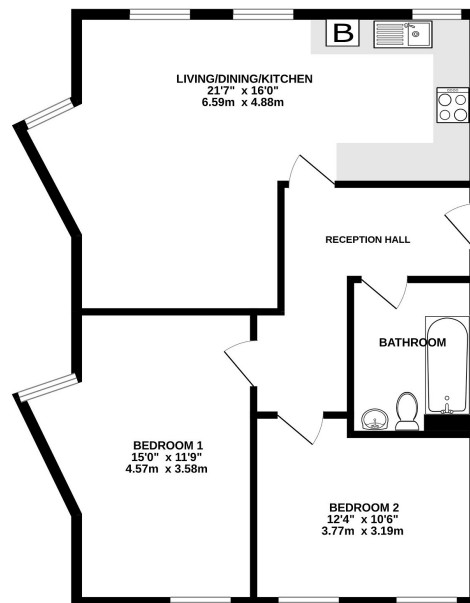

TOTAL FLOOR AREA: 718 sq ft. (66.7 sq.m.) approx.
While every effort has been made to ensure the accuracy of the floorplan contained herein, measurements of doors, windows, rooms and any other items are approximate and no responsibility is taken for any error, omission or misstatement. The plan for distribution purposes only and should be used as such by any prospective purchaser. The technical systems and appliances shown have not been tested and no guarantee as to their operability or efficiency can be given.
Made with Intergen i2023



Part of a 2014 development of the former Leg'o'Mutton Inn, this first floor flat offers a moorland location, within walking distance of restaurants and shops. A dedicated parking space, security intercom, gas central heating, luxury fitted kitchen, two double bedrooms and a superb bathroom with underfloor heating - all are included. Stunning views to the rear over Dartmoor. No onward chain - you will minimise the possibility of an abortive purchase.