

## Tamar Terrace, Horsebridge, PL19 8PH

Guide Price £200,000

1 1 1



- Attractive Slate Built Cottage
- Fully Fitted Kitchen
- One Double Bedroom
- Lawned Front Garden With Sun Terrace
- Parking Directly Outside
- Sun Lounge With Views Towards Kit Hill
- Sitting Room With Wood Burning Stove
- Spacious First Floor Shower Room
- Stunning Views Over The Tamar Valley
- Riverside Village Location

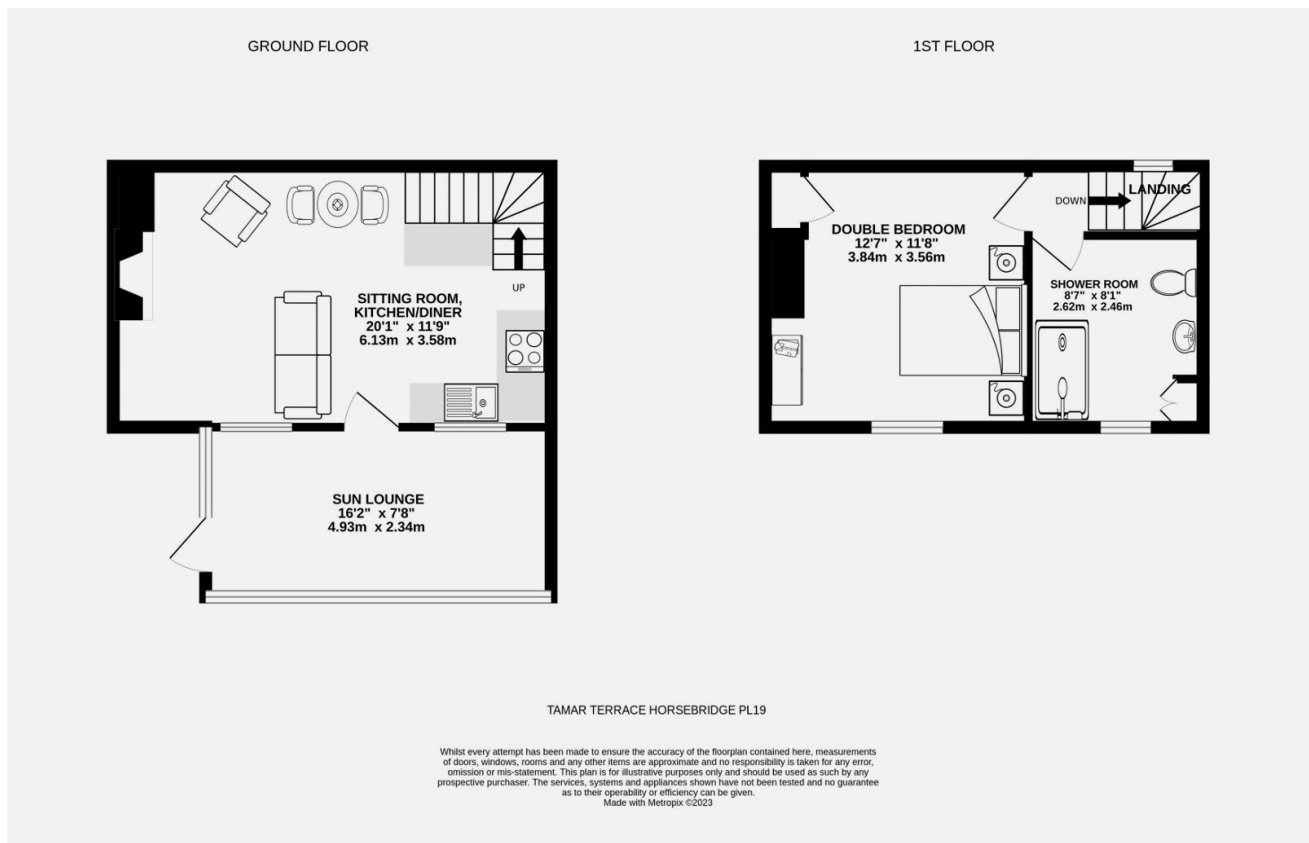

A charming and well appointed character cottage boasting wonderful views over the Tamar Valley situated in the picturesque riverside village of Horsebridge on the borders of Devon and Cornwall. The cottage is ideally located for angling and fishing and less than a minutes walk to a highly regarded and locally run pub The Royal Inn. Ideally situated as a holiday cottage or a 2nd home or for those wishing to downsize. The cottage is available to view immediately and is offered to the market with no onward chain.