



## Bagleys Springs

, Romford, RM6 5LD

Offers In The Region Of £250,000

## Barking & Dagenham



Welcome to this charming duplex maisonette located in the desirable Bagleys Springs area of Romford. This property boasts 1 reception room, 2 cosy bedrooms, and 1 bathroom, offering a comfortable living space perfect for first-time buyers or investors alike.

With a generous 743 sq ft of living area, this purpose-built flat features a garden, ideal for enjoying a cup of tea on a sunny afternoon or hosting a barbecue with friends and family. The property's layout as a duplex maisonette adds a touch of character and uniqueness to the space.

Although the property requires some updating, this presents an exciting opportunity for you to put your personal touch on the space and truly make it your own. Imagine the possibilities of transforming this property into a stylish and modern home tailored to your taste and preferences.

Don't miss out on the chance to own a property in this sought-after location. Whether you're looking to take your first step onto the property ladder or seeking a promising investment opportunity, this duplex maisonette in Bagleys Springs could be the perfect fit for you. Contact us today to arrange a viewing and start envisioning the potential that this property holds.



ENTRANCE  
Ground floor.

KITCHEN 8'9" x 8'5" (2.68m x 2.57m)  
Range of wall and base units. Gas cooker. Electric oven.

RECEPTION ROOM 14'11" x 12'8" (4.55m x 3.88m)  
Door to court yard/balcony. Double glazed. Laminate flooring.  
Radiator.

STAIRS TO FIRST FLOOR

BEDROOM ONE 14'11" x 8'4" (4.56m x 2.56m)  
Double glazed window. Laminate flooring. Radiator. Built-in  
cupboard. Radiator.

BEDROOM TWO 12'10" x 9'2" (3.92m x 2.81m)  
Double glazed window. Laminate flooring. Radiator. Built-in  
cupboard. Radiator.

BATHROOM 9'7" x 5'5" (2.94m x 1.67m)  
Panel bath. Wash hand basin. Low level toilet. Double glazed  
window.

GARDEN  
Laid to lawn.

AGENTS NOTE  
No services or appliances have been tested by Sandra  
Davidson Estate agents.

Area Map



Floor Plans

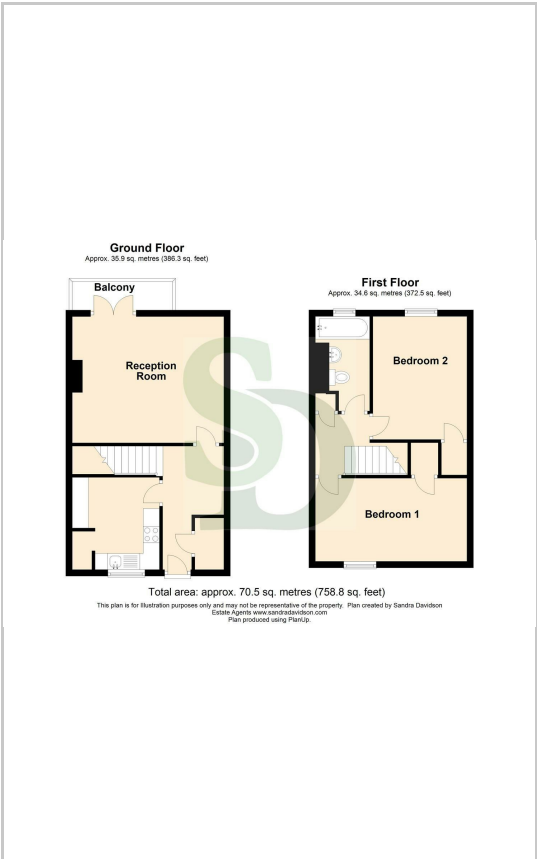

Energy Efficiency Graph

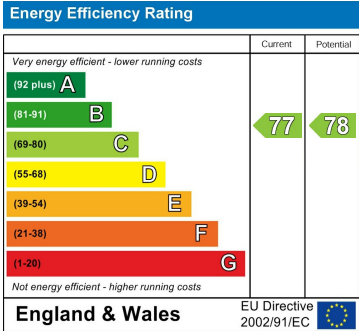

These particulars, whilst believed to be accurate are set out as a general outline only for guidance and do not constitute any part of an offer or contract. Intending purchasers should not rely on them as statements of representation of fact, but must satisfy themselves by inspection or otherwise as to their accuracy. No person in this firms employment has the authority to make or give any representation or warranty in respect of the property.