



Kinfauns Road, Ilford, IG3 9QH

£650,000



£650,000

Kinfauns Road

Ilford, IG3 9QH

- EPC RATING - D
- Two reception rooms
- Off street parking
- Three bedrooms
- Extended kitchen
- Close to Goodmayes Station

GUIDE PRICE £625,000 to £650,000

Sandra Davidson Estate Agents are pleased to offer this spacious and carefully maintained three bedroom end of terrace family home located in a popular residential location and within walking distance to Goodmayes Station (Elizabeth Line - Zone 4). Local amenities such as schools, shops and public transport are also in close proximity. The accommodation comprises: two receptions, ground floor shower room, kitchen, three good size bedrooms and large first floor family bathroom. Other benefits include double glazing, gas central heating and spacious garden. Viewings are highly recommended to avoid disappointment.



ENTRANCE

RECEPTION ONE 13'11" x 12'6" (4.26m x 3.83m)

RECEPTION TWO 12'3" x 11'8" (3.74m x 3.57m)

SHOWER ROOM

KITCHEN 19'3" x 15'4" (5.87m x 4.69m)

STAIRS TO FIRST FLOOR

BEDROOM ONE 12'9" x 11'2" (3.91m x 3.42m)

BEDROOM TWO 12'2" x 11'2" (3.71m x 3.42m)

BEDROOM THREE 9'7" x 8'7" (2.93m x 2.63m)

BATHROOM 8'9" x 8'7" (2.69m x 2.63m)

EXTERIOR

AGENTS NOTE



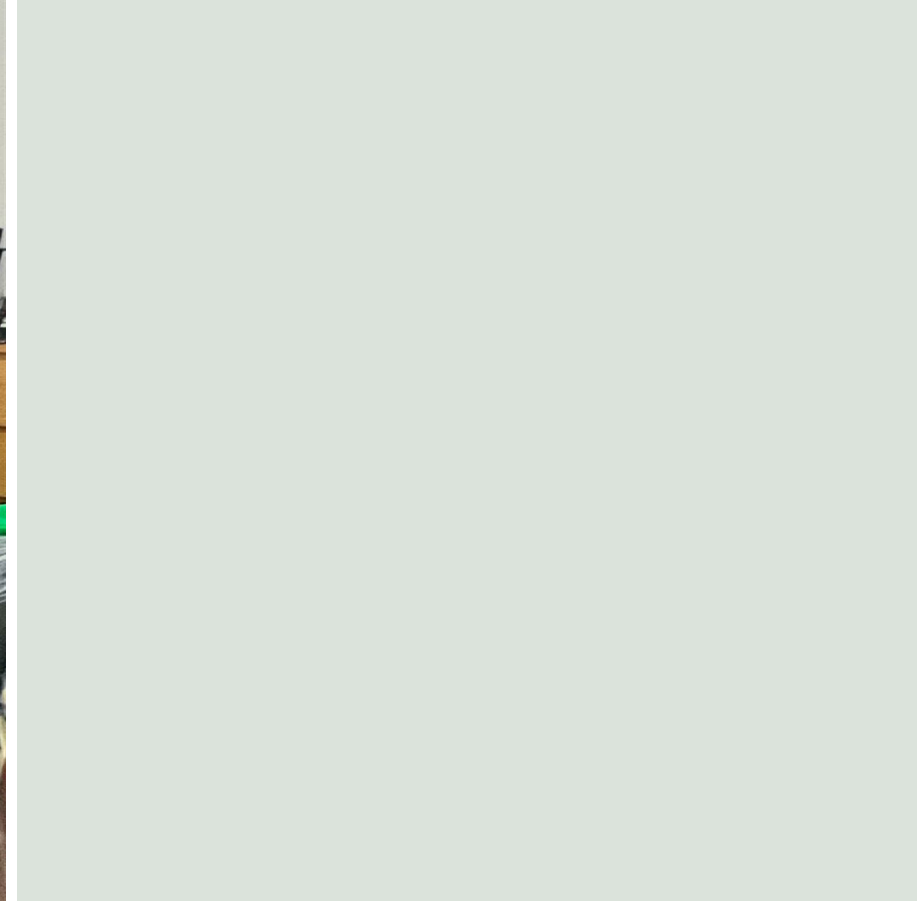

Directions





Floor Plans

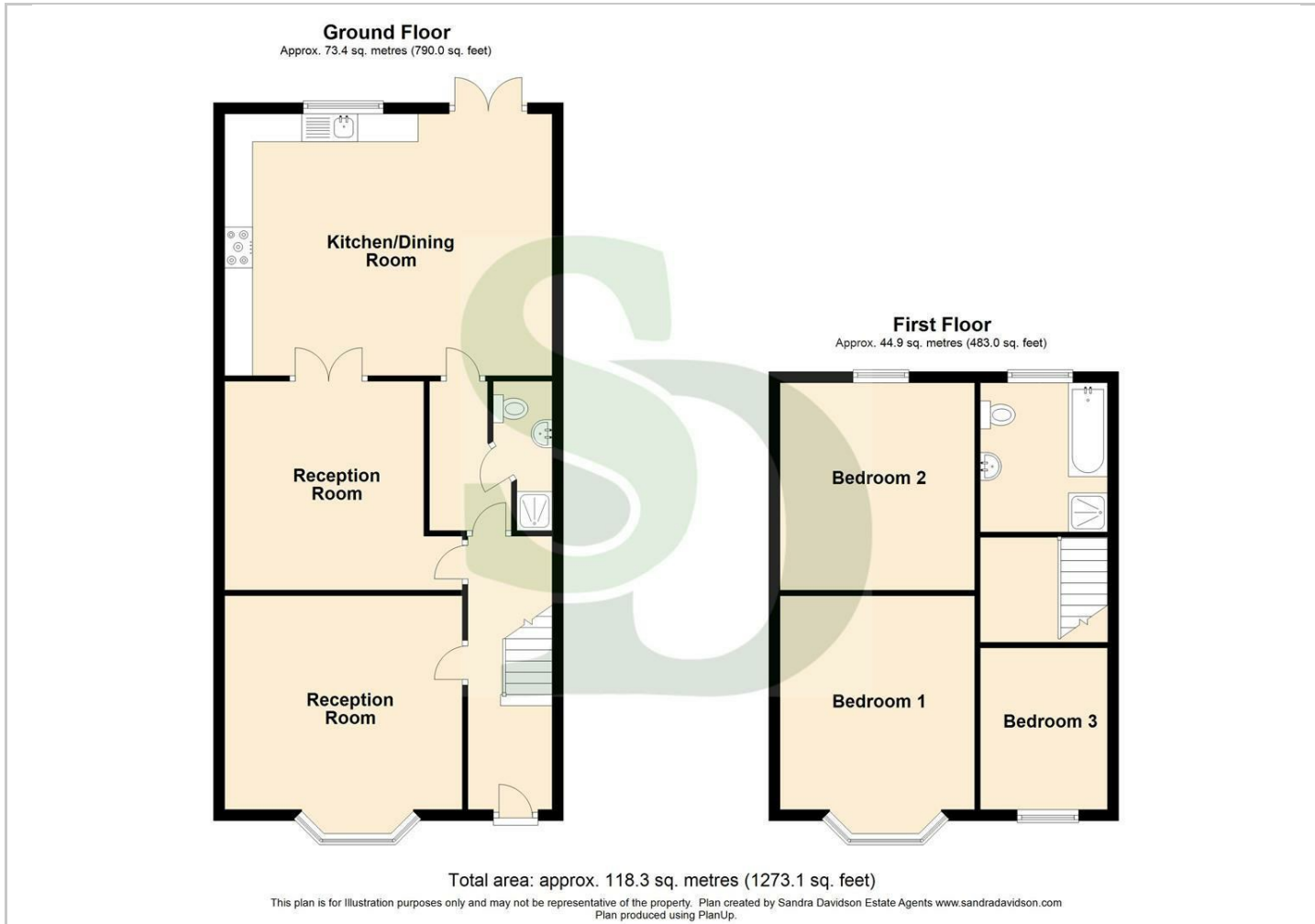

Viewing

Please contact our Seven Kings Sales Office on 020 8597 7372 if you wish to arrange a viewing appointment for this property or require further information.

The particulars are set out as a general outline only for the guidance of intended purchasers or lessees, and do not constitute, any part of a contract. Nothing in these particulars shall be deemed to be a statement that the property is in good structural condition or otherwise nor that any of the services, appliances, equipment or facilities are in good working order. Purchasers should satisfy themselves of this prior to purchasing.

353 Green Lane, Seven Kings, Essex, IG3 9TH
Tel: 020 8597 7372 Email: sevenkings@sandradavidson.com <https://www.sandradavidson.com>

Location Map

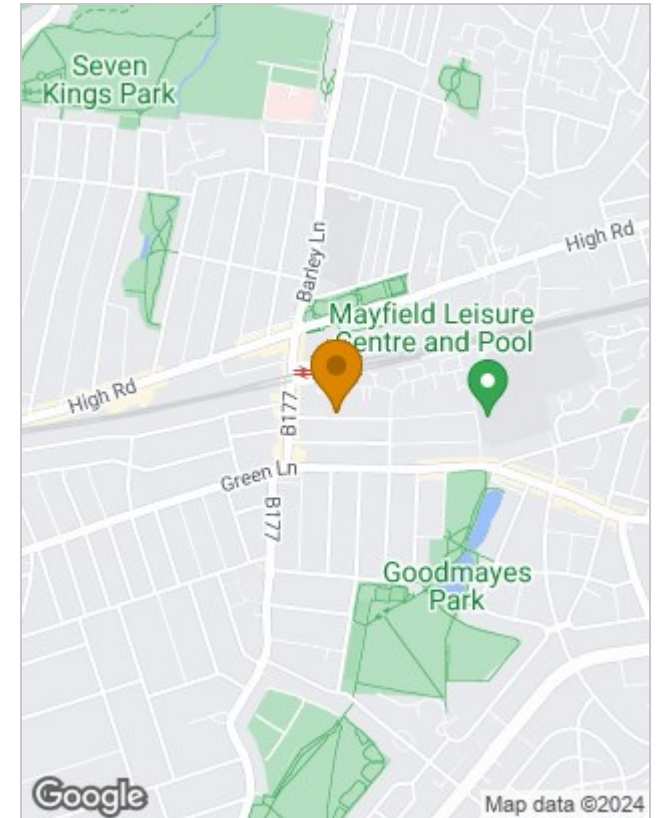

Energy Performance Graph

