



Glebelands Avenue, Ilford, IG2 7DN

Guide Price £550,000





Guide Price £550,000

Glebelands Avenue

Iford, IG2 7DN

- EPC RATING D
- Two reception rooms
- Off street parking
- Garage
- Three bedrooms
- Kitchen
- Close to Newbury Park Station

GUIDE PRICE £550,000 to £575,000

Sandra Davidson Estate Agents are pleased to present this end terraced three bedroom family house with a garage to the side located within close proximity of Seven Kings High School and a convenient location near Newbury Park Station (Central Line - Zone 4). The property comprises three bedrooms, two reception rooms, good size kitchen and first floor family bathrooms. The property also benefits from gas central heating and off-street parking. Viewings are recommended to avoid disappointment.



ENTRANCE

RECEPTION ONE 13'9" x 11'11" (4.21m x 3.64m)

RECEPTION TWO 12'0" x 11'6" (3.67m x 3.51m)

KITCHEN 8'10" x 8'1" (2.71m x 2.48m)

STAIRS TO FIRST FLOOR

BEDROOM ONE 12'10" x 12'0" (3.93m x 3.66m)

BEDROOM TWO 12'3" x 11'10" (3.74m x 3.62m)

BEDROOM THREE 8'9" x 6'11" (2.68m x 2.11m)

BATHROOM 7'5" x 7'1" (2.28m x 2.18m)

EXTERIOR 85' (25.91m)

GARAGE 22'2" x 6'11" (6.78m x 2.13)

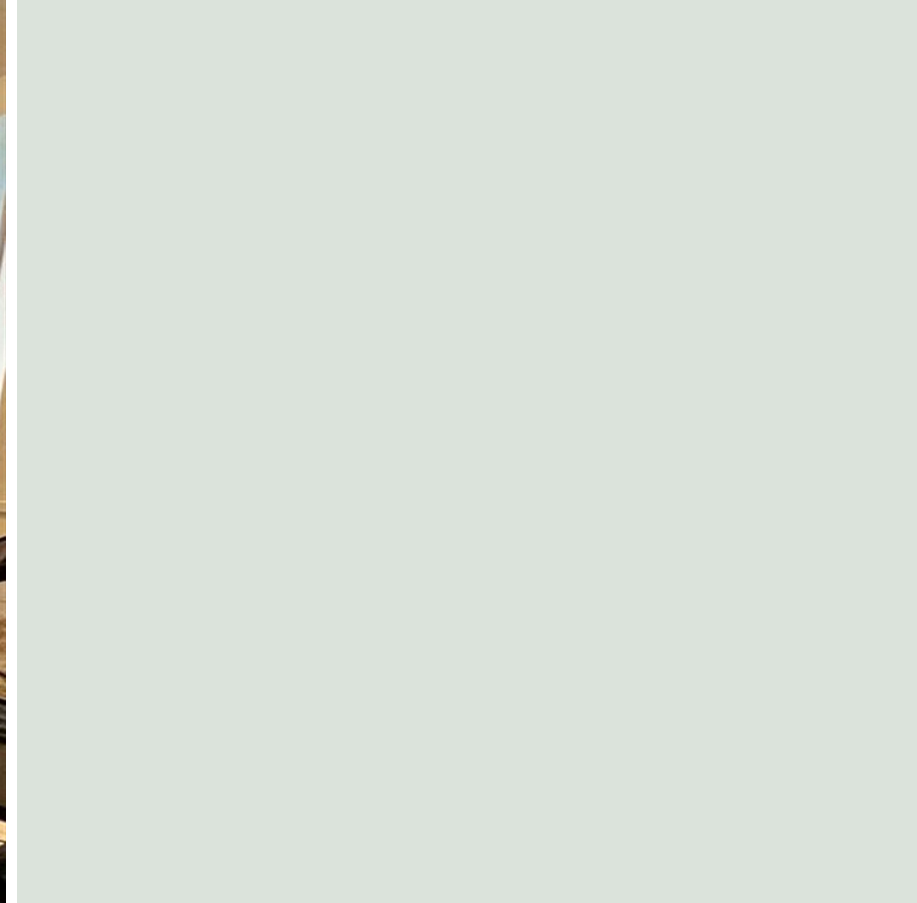

Directions





Floor Plans

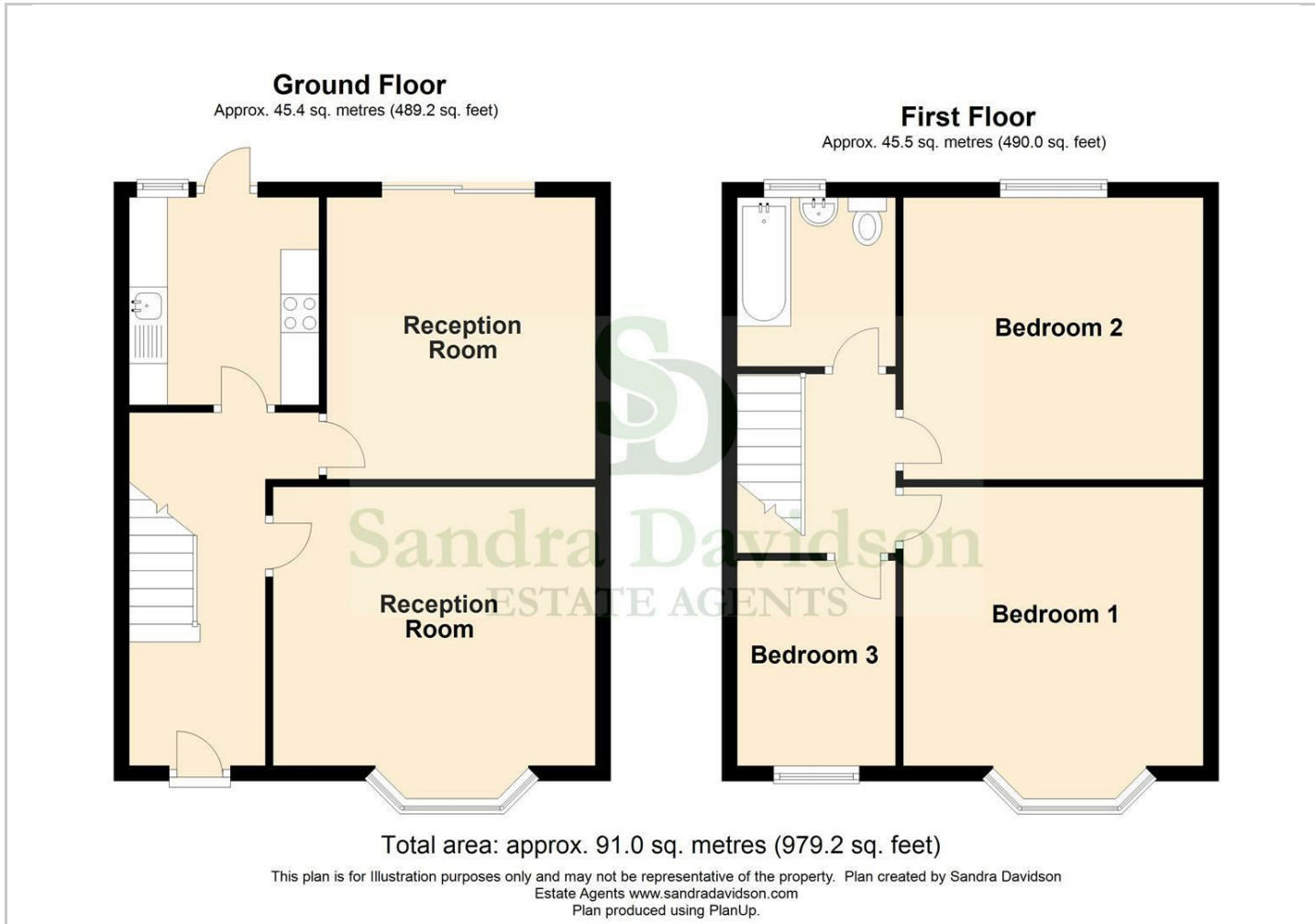

Viewing

Please contact our Seven Kings Sales Office on 020 8597 7372 if you wish to arrange a viewing appointment for this property or require further information.

The particulars are set out as a general outline only for the guidance of intended purchasers or lessees, and do not constitute, any part of a contract. Nothing in these particulars shall be deemed to be a statement that the property is in good structural condition or otherwise nor that any of the services, appliances, equipment or facilities are in good working order. Purchasers should satisfy themselves of this prior to purchasing.

353 Green Lane, Seven Kings, Essex, IG3 9TH
Tel: 020 8597 7372 Email: sevenkings@sandradavidson.com <https://www.sandradavidson.com>

Location Map

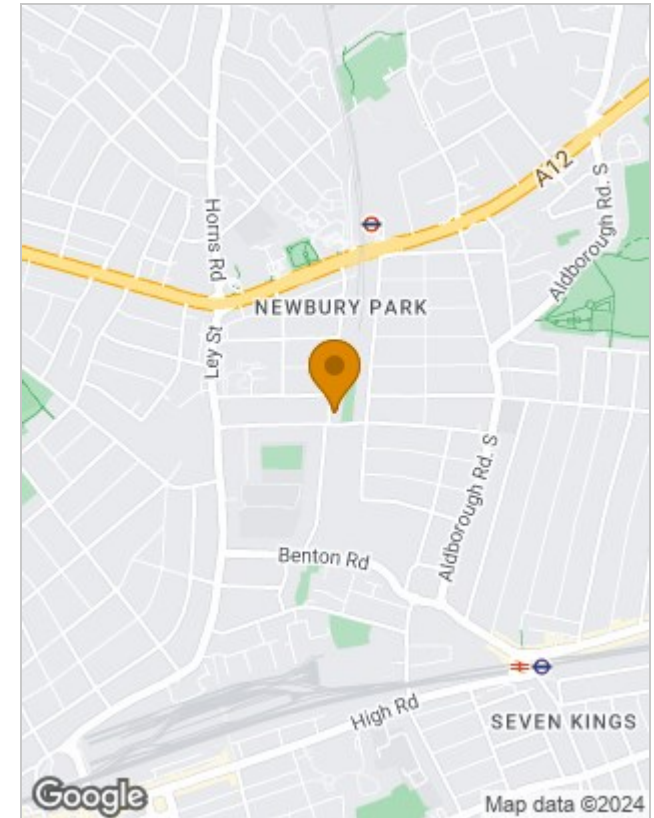

Energy Performance Graph

